

TEMPORARY PAVEMENT MARKINGS LEGEND		
SYMBOL	ITEM	QUANTITY
(A)	4" SOLID WHITE TEMPORARY MARKING, PAINT (ITEM 817003)	1,870 LF
(B)	4" SOLID DOUBLE YELLOW (4"-6"-4") TEMPORARY MARKING, PAINT (ITEM 817003)	1,576 LF
(C)	4" WHITE AUXILIARY LANE (3" STRIPE, 9" GAP) TEMPORARY MARKING, PAINT (ITEM 817003)	65 LF
(D)	TEMPORARY PAVEMENT SYMBOL, PAINT (ITEM 817004)	42 SF

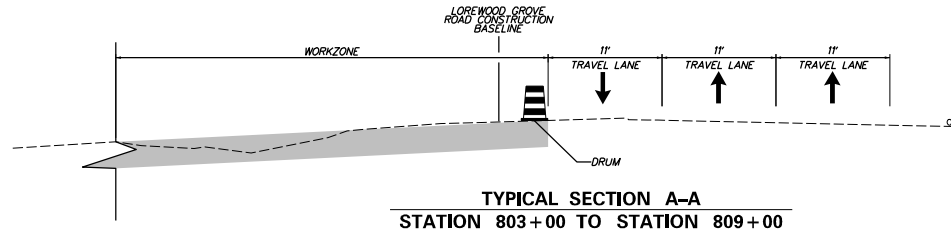

TYPICAL SECTION A-A
STATION 803+00 TO STATION 809+00

PARCEL 12-035.00-001
PARKWAY GRAVEL, INC.
INSTR NO. 20010123 0004754

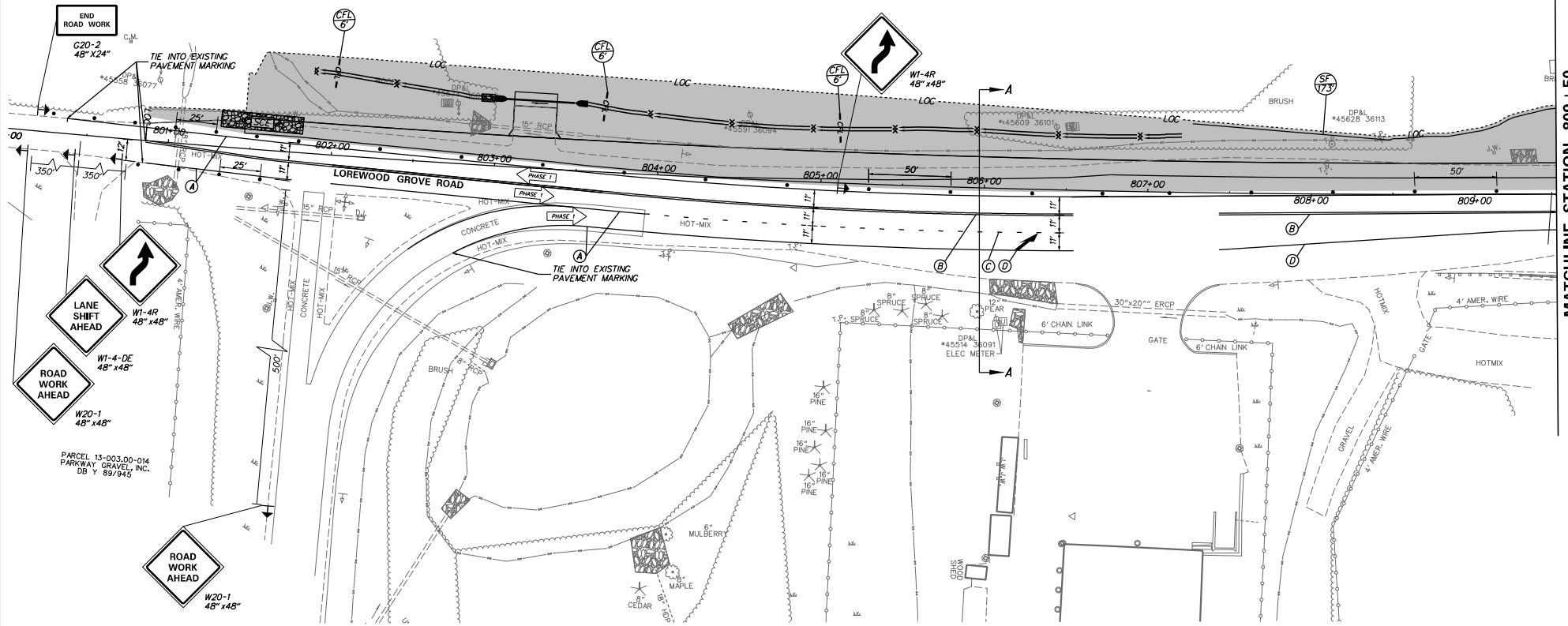

MATCHLINE STATION 809+50

PLOTTED BY: BBOUGHERTY DATE: 4/18/2017
FILE LOCATION: Q:\INR\120995-02\17-GEORGES_MAINTENANCE_CADD\ROADWAY_CS_PHASE_FINAL.DWG [SHEET: 001]

DELAWARE
DEPARTMENT OF TRANSPORTATION

ADDENDUMS / REVISIONS

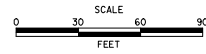

ST. GEORGES
MAINTENANCE YARD
ENTRANCE IMPROVEMENTS

CONTRACT	BRIDGE NO.	N/A
T201780102	DESIGNED BY:	ABF
COUNTY	CHECKED BY:	WJD
NEW CASTLE		

CONSTRUCTION PHASING, M.O.T.
AND EROSION CONTROL PLAN

SHEET NO.	17
TOTAL SHTS.	40