

# SR 1 – REHOBOTH CANAL TO NORTH OF US 9 (FIVE POINTS) PEDESTRIAN IMPROVEMENTS

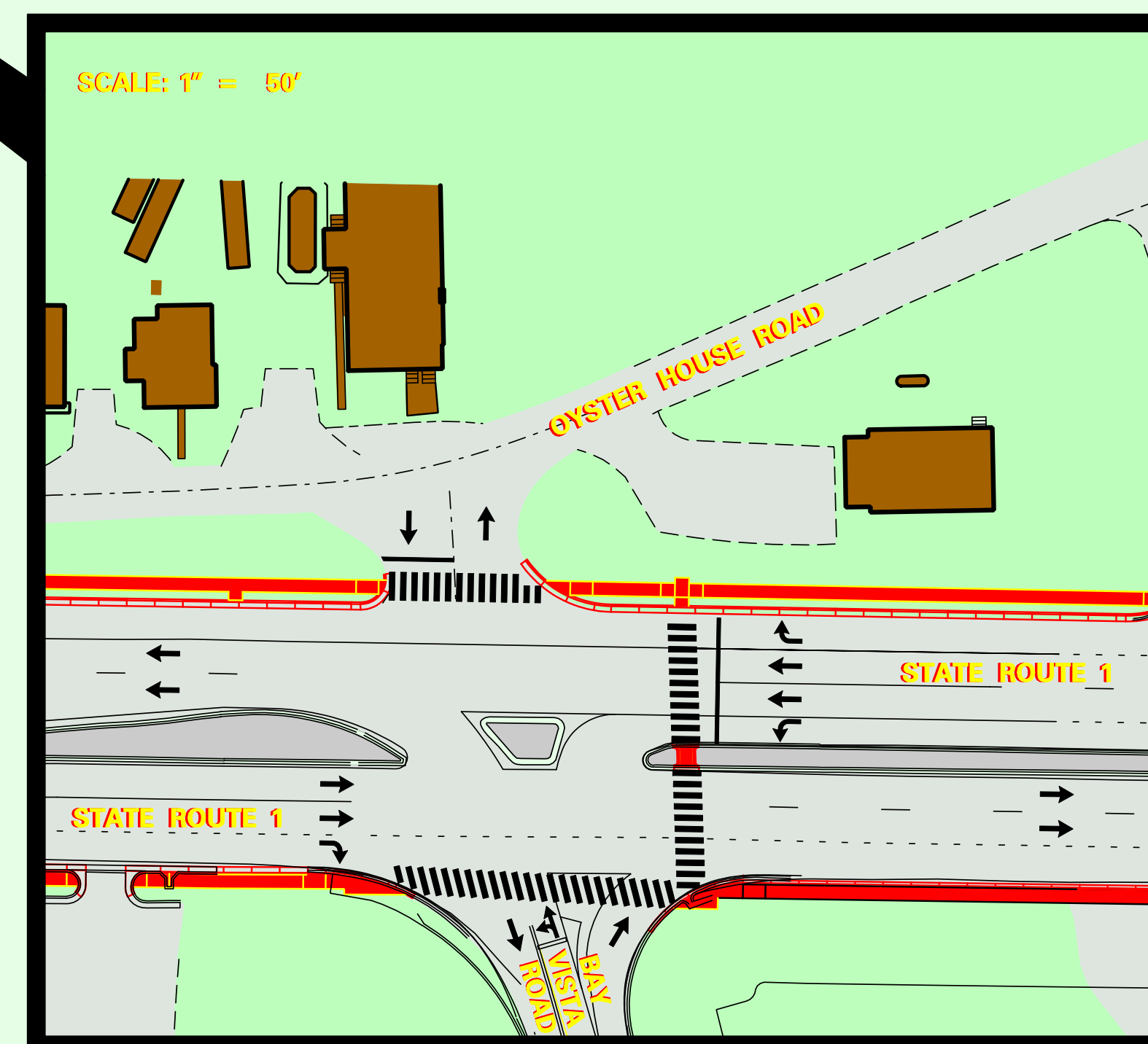
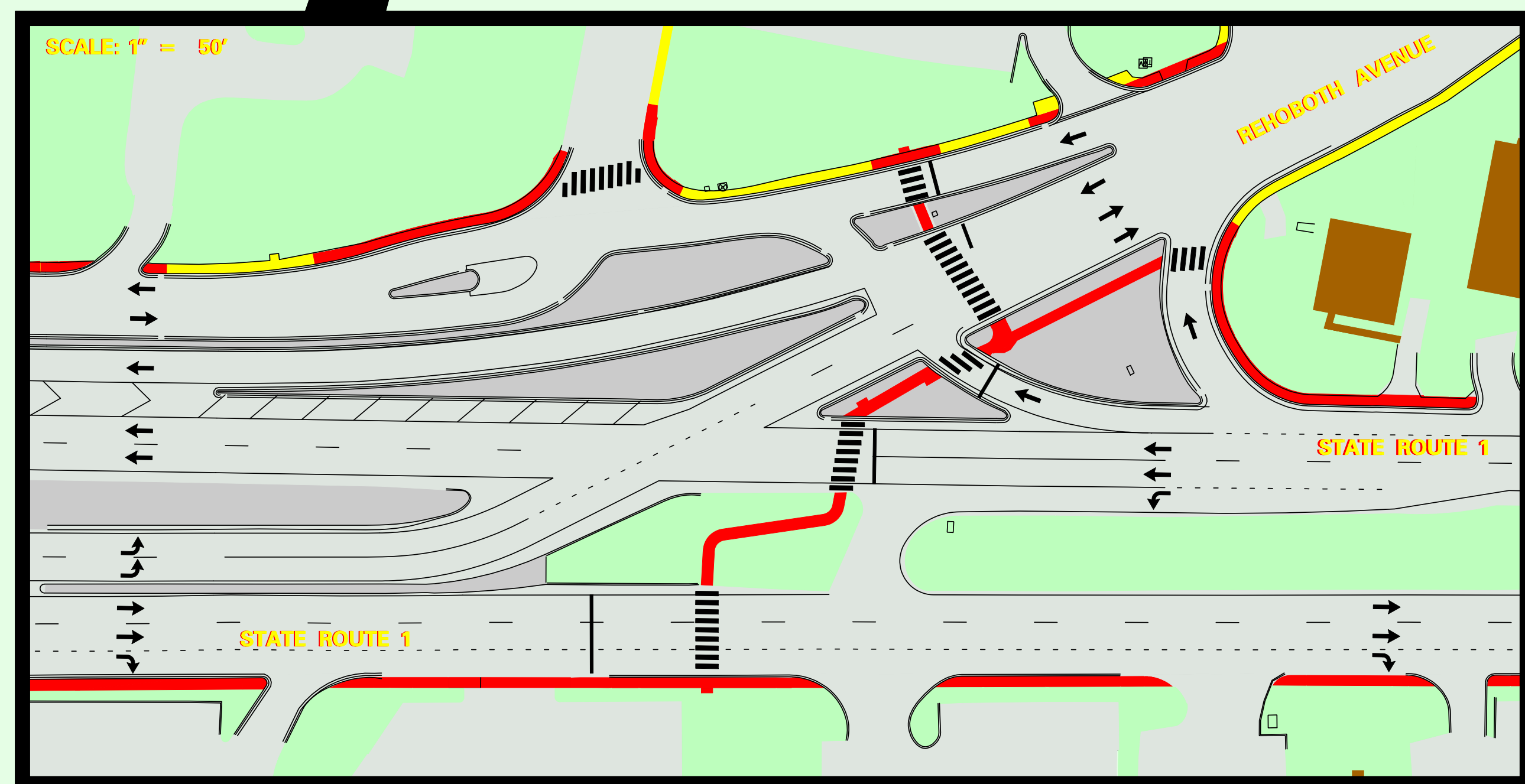

LEGEND	
<span style="color: red;">—</span>	PROPOSED SIDEWALK
<span style="color: yellow;">—</span>	EXISTING SIDEWALK
<span style="color: yellow;">—</span>	LIGHTING LIMITS
<span style="color: green;">●</span>	RELOCATED BUS STOP
<span style="color: purple;">—</span>	EXISTING LUMINAIRE
<span style="color: blue;">—</span>	PROPOSED LUMINAIRE FOR BUS STOPS & SIGNALS
<span style="color: red;">—</span>	PROPOSED LUMINAIRE FOR CONTINUOUS LIGHTING