

DELAWARE STATE HISTORIC PRESERVATION OFFICE
15 THE GREEN, DOVER, DE 19901

CULTURAL RESOURCE SURVEY
PROPERTY IDENTIFICATION FORM

CRS # S-11908
SPO Map 12-13-11
Hundred Georgetown
Quad Georgetown
Other _____

1. HISTORIC NAME/FUNCTION: Dwelling
2. ADDRESS/LOCATION: 18988 Redden Road
3. TOWN/NEAREST TOWN: Georgetown vicinity?
4. MAIN TYPE OF RESOURCE: building structure
landscape district site object
5. MAIN FUNCTION OF PROPERTY: domestic
6. PROJECT TITLE/ REASON FOR SURVEY (if applicable):

7. ADDITIONAL FORMS USED:

| #: | Form: | List property types: |
|----|--------------------------------------|----------------------|
| X | CRS 2 Main Building Form | |
| X | CRS 3 Secondary Building Form | |
| | CRS 4 Archaeological Site Form | |
| | CRS 5 Structure (Building-Like) Form | |
| | CRS 6 Structure (Land Feature) Form | |
| | CRS 7 Object Form | |
| | CRS 8 Landscape Elements Form | |
| X | CRS 9 Map Form | N/A |
| | CRS 14 Potential District Form | |

8. SURVEYOR INFORMATION:

Surveyor name: Kate Farnham

Principal Investigator name: Grace Ziesing

Principal Investigator signature: 

Organization: John Milner Associates, Inc Date: 9/5/2008

9. OTHER NOTES OR OBSERVATIONS:

CRS# S-11908

(information gathered from owner)

owned by Uncle Hoyt, then his father – the house was lost in a poker game with one payment left

rear kitchen torn down and replaced with modern addition; was formerly a 1-story porch

lot to N – had a house, supposedly haunted, now gone

lot across street to S – had oil towers and pump house all/mostly gone

lot to W – was a store, condemned 10 years ago due to septic, about to be demolished; once part of this property.

Front section is original, back 2-story ell is an addition

Family has occupied multiple properties in this street area

10. STATE HISTORIC CONTEXT FRAMEWORK (check all appropriate boxes; refer to state management plan(s)):

- a) Time period(s)
- Pre-European Contact
 - Paleo-Indian
 - Archaic
 - Woodland I
 - Woodland II
 - 1600-1750∇ Contact Period (Native American)
 - 1630-1730∇ Exploration and Frontier Settlement
 - 1730-1770∇ Intensified and Durable Occupation
 - 1770-1830∇ Early Industrialization
 - 1830-1880∇ Industrialization and Early Urbanization
 - 1880-1940∇ Urbanization and Early Suburbanization
 - 1940-1960∇ Suburbanization and Early Ex-urbanization

- b) Geographical zone
- Piedmont
 - Upper Peninsula
 - Lower Peninsula/Cypress Swamp
 - Coastal
 - Urban (City of Wilmington)

- c) Historic period theme(s)
- | | |
|--|---|
| <input type="checkbox"/> Agriculture | <input type="checkbox"/> Transportation and Communication |
| <input type="checkbox"/> Forestry | <input type="checkbox"/> Settlement Patterns and Demographic Changes |
| <input type="checkbox"/> Trapping/Hunting | <input checked="" type="checkbox"/> Architecture, Engineering and Decorative Arts |
| <input type="checkbox"/> Mining/Quarrying | <input type="checkbox"/> Government |
| <input type="checkbox"/> Fishing/Oystering | <input type="checkbox"/> Religion |
| <input type="checkbox"/> Manufacturing | <input type="checkbox"/> Education |
| <input type="checkbox"/> Retailing/Wholesaling | <input type="checkbox"/> Community Organizations |
| <input type="checkbox"/> Finance | <input type="checkbox"/> Occupational Organizations |
| <input type="checkbox"/> Professional Services | <input type="checkbox"/> Major Families, Individuals and Events |

USE BLACK INK ONLY

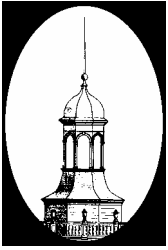

DELAWARE STATE HISTORIC PRESERVATION OFFICE
15 THE GREEN, DOVER, DE 19901

CULTURAL RESOURCE SURVEY
MAIN BUILDING FORM

CRS # S-11908.001

1. ADDRESS/LOCATION: 18988 Redden Road

2. FUNCTION(S): historic dwelling current dwelling

3. YEAR BUILT: 1895 CIRCA?: ARCHITECT/BUILDER:

4. STYLE OR FLOOR PLAN: Vernacular/ I-house

5. INTEGRITY: original site moved

if moved, from where other location's CRS # year

list major alterations and additions with years (if known) year

a. new siding, porch enclosed

b.

6. CURRENT CONDITION: excellent good fair poor

7. DESCRIPTION: (Describe the resource as completely as possible. Use N/A for not applicable; leave no blanks.)

a. Overall shape: Stories: 2.5
Additions:

b Structural system (if known): wood-framed

c. Foundation: materials: rusticated concrete block
basement: full partial not visible no basement

d. Exterior walls (original if visible& any subsequent coverings): vinyl siding

e. Roof: shape: side gable, cross gable
materials: asphalt
cornice: exposed rafter ends
dormers:
chimney: location(s): 2 - int. gable, brick

8. DESCRIPTION OF ELEVATIONS:

| | | |
|----|--------------------|--|
| a. | Facade: Direction: | S |
| 1) | Bays | 3 |
| 2) | Windows | 2 (1 st story), 3 (2 nd story) |
| | fenestration | regular |
| | type | double hung 1/1 wood – older |
| | trim | vinyl |
| | shutters | vinyl, non-functional |

| | | | |
|------------------------|-------------------------|--|---------------------------|
| Facade (cont'd) | | | |
| 3) | Door(s) | 1 | |
| | location | center | |
| | type | vinyl storm | |
| | trim | plain | |
| 4) | Porch(es) | shed-roofed full-width porch with wood floor (Astroturf), rusticated metal cladding skirting plain wood posts with applied modern gingerbread brackets, screened porch | |
| b. | Side: Direction: | E | |
| 1) | Bays | 2 | |
| | 2) | Windows | 2 (3 rd story) |
| 2) | fenestration | regular | |
| | type | fixed (attic) | |
| | trim | wood | |
| | shutters | n/a | |
| 3) | Door(s) | n/a | |
| | location | | |
| | type | | |
| 3) | trim | | |
| | 4) | Porch(es) | n/a |
| | c. | Side: Direction: | W |
| 1) | Bays | 2 | |
| 2) | Windows | 5 - 1 (1 st story), 2 (on both 2 nd and 3 rd) | |
| | fenestration | regular | |
| | type | double hung 1/1 (old); fixed (attic) | |
| | trim | vinyl | |
| | shutters | vinyl, non-functional | |
| 3) | Door(s) | n/a | |
| | location | | |
| | type | | |
| 3) | trim | | |
| | 4) | Porch(es) | n/a |
| | d. | Rear: Direction: | N |
| 1) | Bays | not visible due to rear addition | |
| 2) | Windows | | |
| | fenestration | | |
| | type | | |
| | trim | | |
| | shutters | | |
| 3) | Door(s) | | |
| | location | | |
| | type | | |
| 3) | trim | | |
| | 4) | Porch(es) | |

| | |
|------------|--|
| 9. | INTERIOR: |
| 10. | LANDSCAPING: set close to road on wooded lot; driveway to E; dirt driveway to W with barn/garage at rear and dog pens |
| 11. | OTHER COMMENTS: |

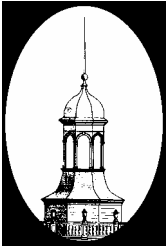

DELAWARE STATE HISTORIC PRESERVATION OFFICE
15 THE GREEN, DOVER, DE 19901

CULTURAL RESOURCE SURVEY
SECONDARY BUILDING FORM

CRS # S-11908.002

1. ADDRESS/LOCATION: 18988 Redden Road

2. FUNCTION(S): historic Domestic current Domestic

3. YEAR BUILT: 1900 CIRCA?: ARCHITECT/BUILDER: _____

4. STYLE/FLOOR PLAN: Vernacular, One pen

5. INTEGRITY: original site moved
if moved, from where original location's CRS # year

list major alterations and additions with years (if known) year

a. asphalt siding, newer doors, construction of dog pens and appended prefab shed on E side

b. _____

6. CURRENT CONDITION: excellent good fair poor

7. DESCRIPTION:

a. Structural system wood-framed

b. Number of stories 1.5

c. Wall coverings asphalt

d. Foundation

e. Roof
structural system gable front, exposed rafter ends
coverings corrugated metal
openings n/a

8. DESCRIPTION OF ELEVATIONS:

a. Facade: direction: S

1) bays: 2

2) windows: 0

3) door(s): 2, 1 pair modern cross-batten doors, 1 3-light door ca. 1960s

4) other:

- b. Side: direction: W
 - 1) bays: 0
 - 2) windows:
 - 3) door(s):
 - 4) other:

- c. Side: direction: E
 - 1) bays: not visible due to 1-story side addition
 - 2) windows:
 - 3) door(s):
 - 4) other:

- d. Rear: direction: N
 - 1) bays: 1
 - 2) Windows: 1, double hung 6/6
 - 3) door(s): track still there from covered-over door, now covered by siding
 - 4) other:

9. INTERIOR (if accessible):

a) Floor plan

b) Partition/walls

c) Finishes

d) Furnishings/machinery

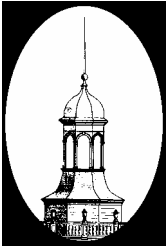

DELAWARE STATE HISTORIC PRESERVATION OFFICE
15 THE GREEN, DOVER, DE 19901

CULTURAL RESOURCE SURVEY
SECONDARY BUILDING FORM

CRS # S-11908.003

1. ADDRESS/LOCATION: 18988 Redden Road

2. FUNCTION(S): historic Workshop/ equipment shed current domestic

3. YEAR BUILT: 1950 CIRCA?: ARCHITECT/BUILDER: _____

4. STYLE/FLOOR PLAN: n/a

5. INTEGRITY: original site moved
if moved, from where original location's CRS # year

list major alterations and additions with years (if known) year

a. modern asphalt roll siding on rear and side of shed area

b. _____

6. CURRENT CONDITION: excellent good fair poor

7. DESCRIPTION:

a. Structural system wood-framed

b. Number of stories 1

c. Wall coverings wood shingle

d. Foundation concrete block

e. Roof
structural system shed
coverings standing seam metal
openings int. gable, stovepipe

8. DESCRIPTION OF ELEVATIONS:

- a. Facade: direction: S
1) bays: 5
2) windows: 2, double hung 2/2 (horizontal division)
3) door(s): 4 (3 open bays), Jalousie panel door (aluminum)
4) other: _____

- b. Side: direction: E
 - 1) bays: 1
 - 2) windows: 1, double hung 1/1; narrow and appears to have been salvaged from historic house
 - 3) door(s): n/a
 - 4) other:

- c. Side: direction: W
 - 1) bays: 0
 - 2) windows:
 - 3) door(s):
 - 4) other:

- d. Rear: direction: N
 - 1) bays: 2
 - 2) windows: 1, double hung 1/1, very narrow, salvaged from another historic building
 - 3) door(s): 1, right side, 2-panel interior-type door
 - 4) other:

9. INTERIOR (if accessible):

a) Floor plan

b) Partition/walls

c) Finishes

d) Furnishings/machinery

INDICATE NORTH ON PLAN

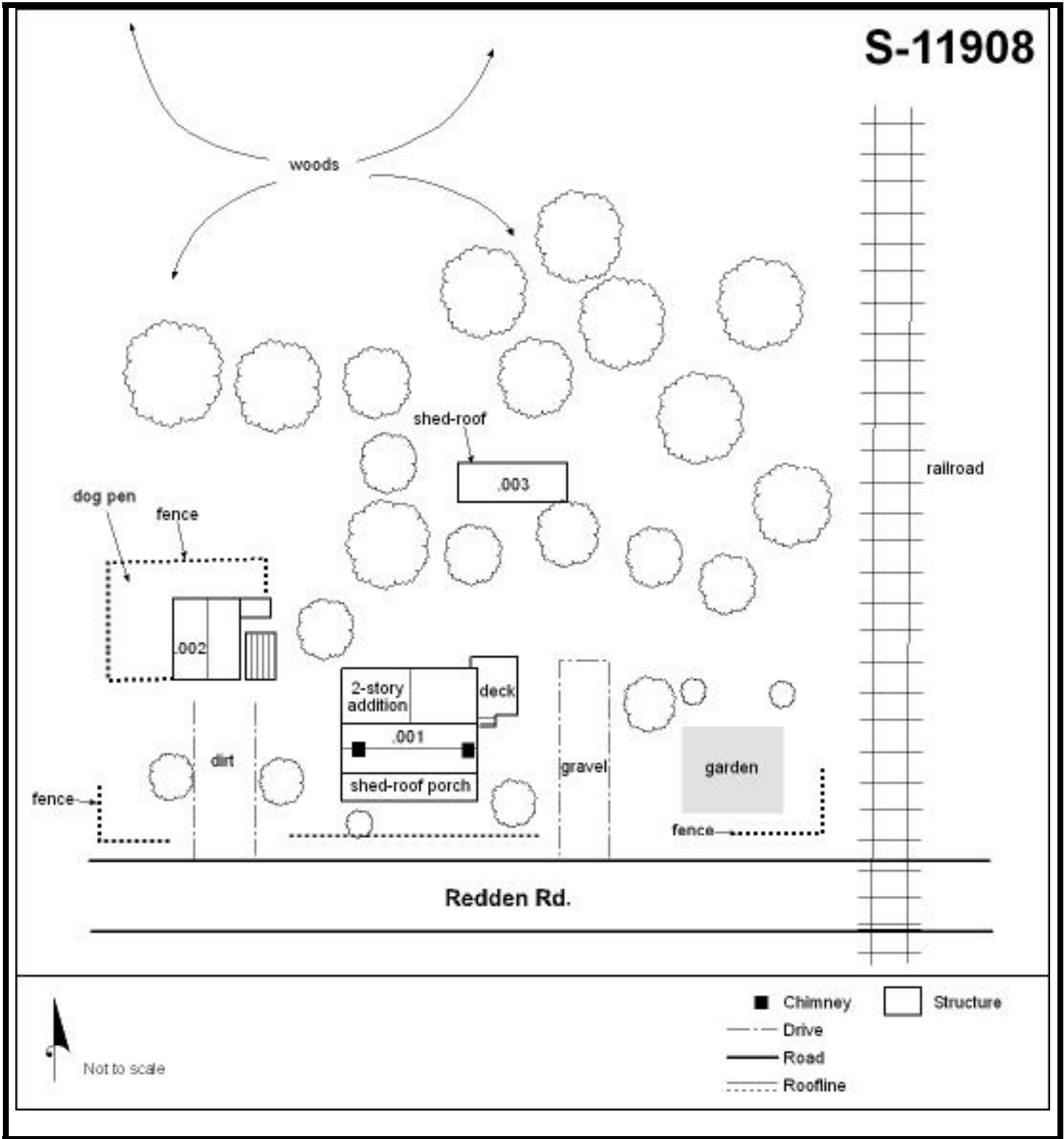

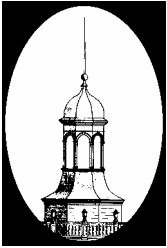

DELAWARE STATE HISTORIC PRESERVATION OFFICE
15 THE GREEN, DOVER, DE 19901

CULTURAL RESOURCE SURVEY
PROPERTY IDENTIFICATION FORM

CRS # S-11909
SPO Map 12-13-11
Hundred Georgetown
Quad Georgetown
Other _____

1. HISTORIC NAME/FUNCTION: Country Store

2. ADDRESS/LOCATION: Redden Road (north side)

3. TOWN/NEAREST TOWN: Georgetown vicinity?

4. MAIN TYPE OF RESOURCE: building structure site object
landscape district

5. MAIN FUNCTION OF PROPERTY: Vacant/ not in use (condemned)

6. PROJECT TITLE/ REASON FOR SURVEY (if applicable):

7. ADDITIONAL FORMS USED:

| #: | Form: | List property types: |
|----|--------------------------------------|----------------------|
| X | CRS 2 Main Building Form | |
| | CRS 3 Secondary Building Form | |
| | CRS 4 Archaeological Site Form | |
| | CRS 5 Structure (Building-Like) Form | |
| | CRS 6 Structure (Land Feature) Form | |
| | CRS 7 Object Form | |
| | CRS 8 Landscape Elements Form | |
| X | CRS 9 Map Form | N/A |
| | CRS 14 Potential District Form | |

8. SURVEYOR INFORMATION:

Surveyor name: Kate Farnham

Principal Investigator name: Grace Ziesing

Principal Investigator signature:

Organization: John Milner Associates, Inc Date: 9/5/2008

9. OTHER NOTES OR OBSERVATIONS:

CRS# S-11909

The woman next door (to the East) says that this was a store, later converted to a residence. Was condemned due to septic issues. Probably will be torn down soon; building next door is a remodeled trailer.

10. STATE HISTORIC CONTEXT FRAMEWORK (check all appropriate boxes; refer to state management plan(s)):

a) Time period(s)

- Pre-European Contact
- Paleo-Indian
- Archaic
- Woodland I
- Woodland II

- 1600-1750∇ Contact Period (Native American)
- 1630-1730∇ Exploration and Frontier Settlement
- 1730-1770∇ Intensified and Durable Occupation
- 1770-1830∇ Early Industrialization
- 1830-1880∇ Industrialization and Early Urbanization
- 1880-1940∇ Urbanization and Early Suburbanization
- 1940-1960∇ Suburbanization and Early Ex-urbanization

b) Geographical zone

- Piedmont
- Upper Peninsula
- Lower Peninsula/Cypress Swamp
- Coastal
- Urban (City of Wilmington)

c) Historic period theme(s)

- | | |
|--|---|
| <input type="checkbox"/> Agriculture | <input type="checkbox"/> Transportation and Communication |
| <input type="checkbox"/> Forestry | <input type="checkbox"/> Settlement Patterns and Demographic Changes |
| <input type="checkbox"/> Trapping/Hunting | <input checked="" type="checkbox"/> Architecture, Engineering and Decorative Arts |
| <input type="checkbox"/> Mining/Quarrying | <input type="checkbox"/> Government |
| <input type="checkbox"/> Fishing/Oystering | <input type="checkbox"/> Religion |
| <input type="checkbox"/> Manufacturing | <input type="checkbox"/> Education |
| <input type="checkbox"/> Retailing/Wholesaling | <input type="checkbox"/> Community Organizations |
| <input type="checkbox"/> Finance | <input type="checkbox"/> Occupational Organizations |
| <input type="checkbox"/> Professional Services | <input type="checkbox"/> Major Families, Individuals and Events |

USE BLACK INK ONLY

CRS-1

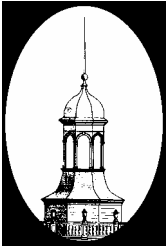

DELAWARE STATE HISTORIC PRESERVATION OFFICE
15 THE GREEN, DOVER, DE 19901

CULTURAL RESOURCE SURVEY
MAIN BUILDING FORM

CRS # S-11909.001

1. ADDRESS/LOCATION: Redden Road (north side)

2. FUNCTION(S): historic commerce/trade current Vacant/ condemned

3. YEAR BUILT: 1940 CIRCA?: ARCHITECT/BUILDER: _____

4. STYLE OR FLOOR PLAN: Country Store

5. INTEGRITY: original site moved

if moved, from where other location's CRS # year

list major alterations and additions with years (if known) year

a. new siding, roofing, windows, doors and skylights

b. _____

6. CURRENT CONDITION: excellent good fair poor

7. DESCRIPTION: (Describe the resource as completely as possible. Use N/A for not applicable; leave no blanks.)

a. Overall shape: rectangle Stories: 1
Additions: _____

b. Structural system (if known): wood-framed

c. Foundation: materials: not visible
basement: full partial not visible no basement

d. Exterior walls (original if visible& any subsequent coverings): vinyl siding

e. Roof: shape: side gable
materials: standing seam metal
cornice: boxed
dormers: _____
chimney: location(s): n/a

8. DESCRIPTION OF ELEVATIONS:

| | | |
|---------------------|-----------------------------|------------------------------------|
| a. | Facade: Direction: <u>S</u> | |
| | 1) | Bays <u>3</u> |
| | 2) | Windows <u>2</u> |
| | | fenestration <u>irregular</u> |
| | | type <u>double hung, 6/6 vinyl</u> |
| | | trim <u>vinyl</u> |
| shutters <u>n/a</u> | | |

| | | |
|------------------------|-------------------------|--|
| Facade (cont'd) | | |
| 3) | Door(s) | 1 |
| | location | center |
| | type | aluminum-clad, 6-panel, modern |
| | trim | plain |
| 4) | Porch(es) | shed-roof porch, concrete floor, turned posts, inset |
| b. | Side: Direction: | W |
| 1) | Bays | 1 |
| | Windows | 1 |
| 2) | fenestration | irregular |
| | type | double hung, 6/6 vinyl |
| | trim | vinyl |
| | shutters | n/a |
| 3) | Door(s) | n/a |
| | location | |
| | type | |
| | trim | |
| 4) | Porch(es) | n/a |
| c. | Side: Direction: | E |
| 1) | Bays | 2 |
| 2) | Windows | 1 |
| | fenestration | irregular |
| | type | double hung, 6/6 vinyl |
| | trim | vinyl |
| | shutters | n/a |
| 3) | Door(s) | 1 |
| | location | right side |
| | type | aluminum-clad, 6 panel, modern |
| | trim | plain |
| 4) | Porch(es) | concrete slab stoop |
| d. | Rear: Direction: | N |
| 1) | Bays | 2 |
| 2) | Windows | 2 |
| | fenestration | irregular |
| | type | awning |
| | trim | aluminum |
| | shutters | n/a |
| 3) | Door(s) | n/a |
| | location | |
| | type | |
| | trim | |
| 4) | Porch(es) | n/a |

| | |
|-----|--|
| 9. | INTERIOR: |
| 10. | LANDSCAPING: open grass lot with shrubs along rear; pile of tree stumps at NE corner; small wooden duplex to W; both buildings vacant |
| 11. | OTHER COMMENTS: |

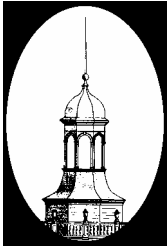

DELAWARE STATE HISTORIC PRESERVATION OFFICE
15 THE GREEN, DOVER, DE 19901

CULTURAL RESOURCE SURVEY
MAP FORM

CRS # S-11909

1. ADDRESS/LOCATION: Redden Road (north side)
2. NOT FOR PUBLICATION reason: _____
3. LOCATION MAP:

Indicate position of resource in relation to geographical landmarks such as streams and crossroads.

(attach section of USGS quad map with location marked or draw location map)

INDICATE NORTH ON SKETCH

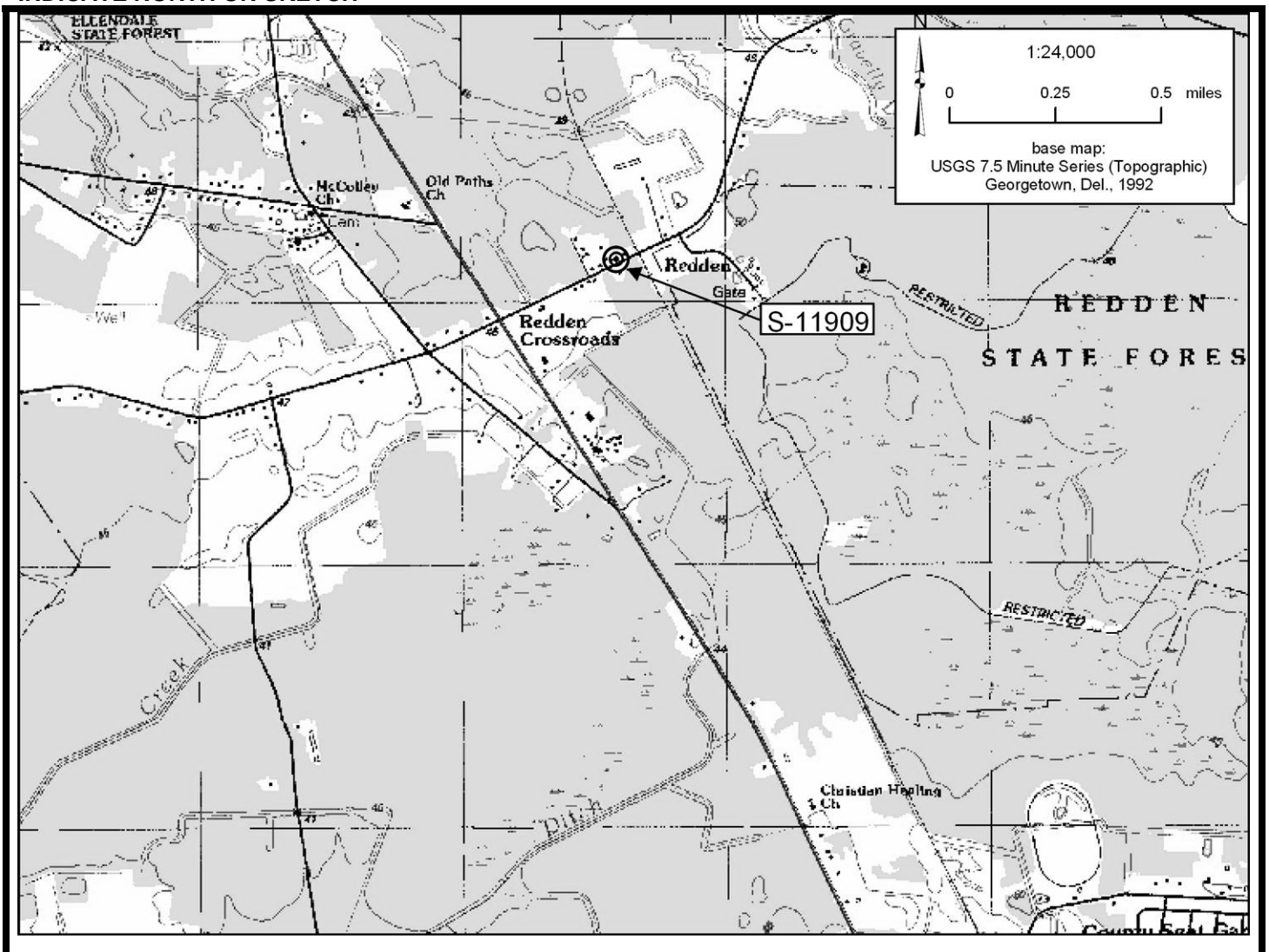

INDICATE NORTH ON PLAN

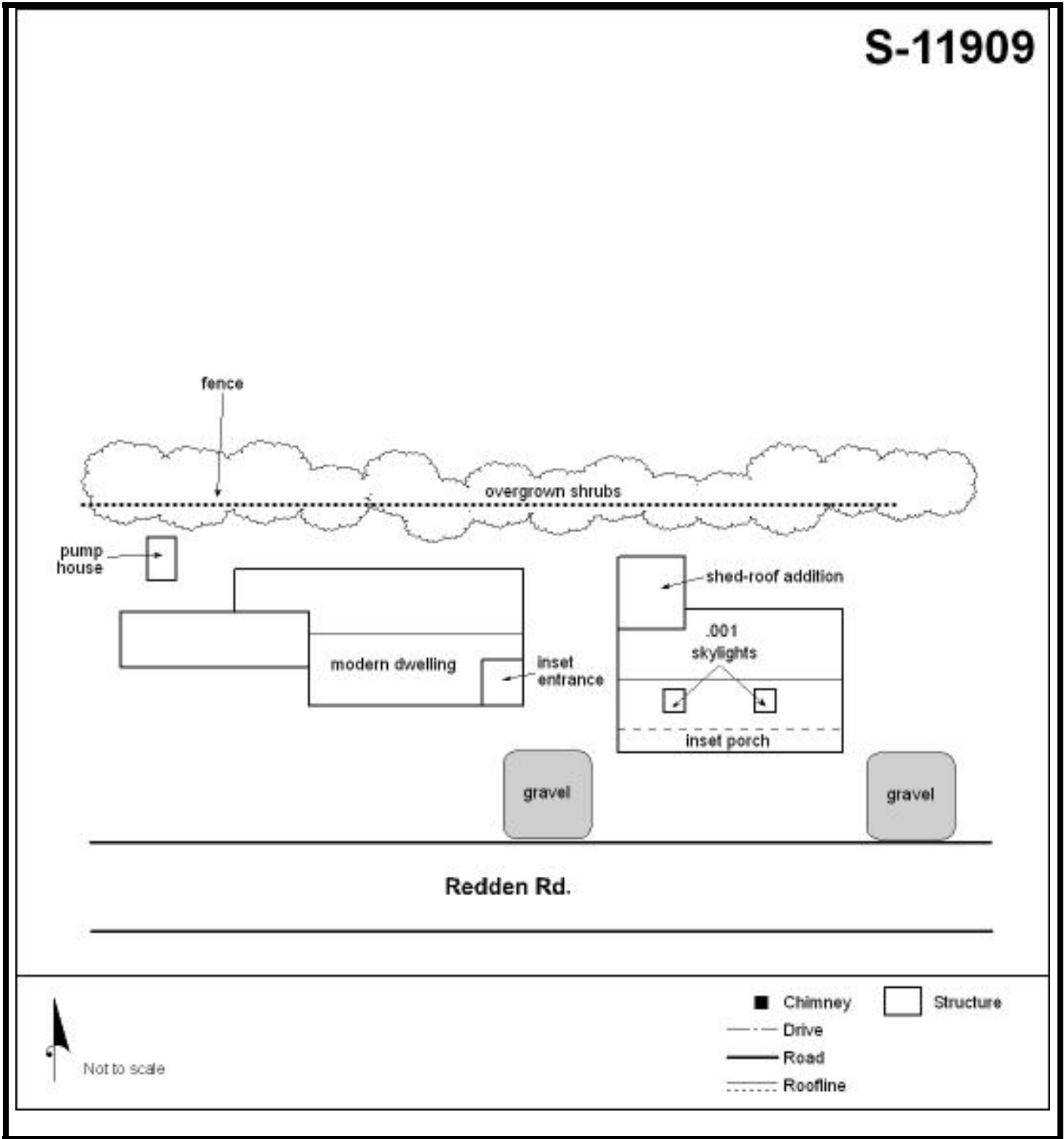

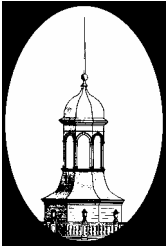

DELAWARE STATE HISTORIC PRESERVATION OFFICE
15 THE GREEN, DOVER, DE 19901

CULTURAL RESOURCE SURVEY
PROPERTY IDENTIFICATION FORM

CRS # S-11910
SPO Map 12-13-11
Hundred Georgetown
Quad Georgetown
Other _____

1. HISTORIC NAME/FUNCTION: Dwelling
2. ADDRESS/LOCATION: 17991 Redden Road
3. TOWN/NEAREST TOWN: Georgetown vicinity?
4. MAIN TYPE OF RESOURCE:

| | | | | | | | |
|-----------|-------------------------------------|-----------|--------------------------|------|--------------------------|--------|--------------------------|
| building | <input checked="" type="checkbox"/> | structure | <input type="checkbox"/> | site | <input type="checkbox"/> | object | <input type="checkbox"/> |
| landscape | <input type="checkbox"/> | district | <input type="checkbox"/> | | | | |
5. MAIN FUNCTION OF PROPERTY: domestic
6. PROJECT TITLE/ REASON FOR SURVEY (if applicable):

7. ADDITIONAL FORMS USED:

| #: | Form: | List property types: |
|----|--------------------------------------|----------------------|
| X | CRS 2 Main Building Form | |
| X | CRS 3 Secondary Building Form | |
| | CRS 4 Archaeological Site Form | |
| | CRS 5 Structure (Building-Like) Form | |
| | CRS 6 Structure (Land Feature) Form | |
| | CRS 7 Object Form | |
| | CRS 8 Landscape Elements Form | |
| X | CRS 9 Map Form | N/A |
| | CRS 14 Potential District Form | |

8. SURVEYOR INFORMATION:

Surveyor name: Kate Farnham

Principal Investigator name: Grace Ziesing

Principal Investigator signature: 

Organization: John Milner Associates, Inc Date: 9/5/2008

9. OTHER NOTES OR OBSERVATIONS:

CRS# S-11910

Owner says house is ca. 40 years old. House looks much newer than outbuildings – replacement house or moved buildings?

10. STATE HISTORIC CONTEXT FRAMEWORK (check all appropriate boxes; refer to state management plan(s)):

- a) Time period(s)
- Pre-European Contact
 - Paleo-Indian
 - Archaic
 - Woodland I
 - Woodland II
 - 1600-1750∇ Contact Period (Native American)
 - 1630-1730∇ Exploration and Frontier Settlement
 - 1730-1770∇ Intensified and Durable Occupation
 - 1770-1830∇ Early Industrialization
 - 1830-1880∇ Industrialization and Early Urbanization
 - 1880-1940∇ Urbanization and Early Suburbanization
 - 1940-1960∇ Suburbanization and Early Ex-urbanization

- b) Geographical zone
- Piedmont
 - Upper Peninsula
 - Lower Peninsula/Cypress Swamp
 - Coastal
 - Urban (City of Wilmington)

c) Historic period theme(s)

- | | |
|--|---|
| <input type="checkbox"/> Agriculture | <input type="checkbox"/> Transportation and Communication |
| <input type="checkbox"/> Forestry | <input type="checkbox"/> Settlement Patterns and Demographic Changes |
| <input type="checkbox"/> Trapping/Hunting | <input checked="" type="checkbox"/> Architecture, Engineering and Decorative Arts |
| <input type="checkbox"/> Mining/Quarrying | <input type="checkbox"/> Government |
| <input type="checkbox"/> Fishing/Oystering | <input type="checkbox"/> Religion |
| <input type="checkbox"/> Manufacturing | <input type="checkbox"/> Education |
| <input type="checkbox"/> Retailing/Wholesaling | <input type="checkbox"/> Community Organizations |
| <input type="checkbox"/> Finance | <input type="checkbox"/> Occupational Organizations |
| <input type="checkbox"/> Professional Services | <input type="checkbox"/> Major Families, Individuals and Events |

USE BLACK INK ONLY

CRS-1

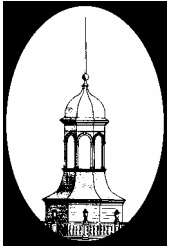

DELAWARE STATE HISTORIC PRESERVATION OFFICE
15 THE GREEN, DOVER, DE 19901

CULTURAL RESOURCE SURVEY
MAIN BUILDING FORM

CRS # S-11910.001

1. ADDRESS/LOCATION: 17991 Redden Road

2. FUNCTION(S): historic domestic current domestic

3. YEAR BUILT: 1960 CIRCA?: ARCHITECT/BUILDER:

4. STYLE OR FLOOR PLAN: Ranch

5. INTEGRITY: original site moved

if moved, from where other location's CRS # year

list major alterations and additions with years (if known) year

- a. new siding, windows, doors
- b. newer second garage addition, newer front porch

6. CURRENT CONDITION: excellent good fair poor

7. DESCRIPTION: (Describe the resource as completely as possible. Use N/A for not applicable; leave no blanks.)

- a. Overall shape: rectangle Stories: 1
Additions: second garage addition, front porch
- b. Structural system (if known): wood-framed
- c. Foundation: materials: concrete block
basement: full partial not visible no basement
- d. Exterior walls (original if visible& any subsequent coverings): vinyl siding
- e. Roof: shape: side gable
materials: asphalt
cornice: boxed
dormers:
chimney: location(s): center, concrete block

8. DESCRIPTION OF ELEVATIONS:

| | | |
|----|--------------------|----------------------------------|
| a. | Facade: Direction: | W |
| 1) | Bays | 5 |
| 2) | Windows | 2 |
| | fenestration | irregular |
| | type | double hung, 6/6 vinyl; casement |
| | trim | vinyl |
| | shutters | vinyl, non-functional |

| | | |
|------------------------|-------------------------|---|
| Facade (cont'd) | | |
| 3) | Door(s) | 3 |
| | location | center, left side |
| | type | vinyl clad garage doors (5-light, 15 panel) and regular door (1-light entrance door) – all modern |
| | trim | plain |
| 4) | Porch(es) | low-pitched front gabled roof, concrete foundation, fully enclosed – possibly an addition |
| b. | Side: Direction: | N |
| 1) | Bays | 3 |
| | 2) | Windows |
| | fenestration | irregular |
| | type | double-hung, 1/1 and 6/6 (all modern) |
| | trim | aluminum, vinyl |
| | shutters | n/a |
| 3) | Door(s) | n/a |
| | location | |
| | type | |
| | trim | |
| 4) | Porch(es) | n/a |
| c. | Side: Direction: | S |
| 1) | Bays | 3 |
| 2) | Windows | 3 |
| | fenestration | irregular |
| | type | double hung, 6/6 vinyl |
| | trim | aluminum, vinyl |
| | shutters | |
| 3) | Door(s) | n/a |
| | location | |
| | type | |
| | trim | |
| 4) | Porch(es) | n/a |
| d. | Rear: Direction: | E |
| 1) | Bays | 5 |
| 2) | Windows | 4 |
| | fenestration | irregular |
| | type | double hung, 6/6 vinyl |
| | trim | aluminum, vinyl |
| | shutters | vinyl, non-functional |
| 3) | Door(s) | 1 |
| | location | right side |
| | type | aluminum, 9-light, 2 panel – modern |
| | trim | plain |
| 4) | Porch(es) | shed-roofed modern |

| | |
|-----|--|
| 9. | INTERIOR: |
| 10. | LANDSCAPING: lawn with scattered trees; rail fence along front; paved driveway medium setback; foundation plantings; row of outbuildings at rear of house |
| 11. | OTHER COMMENTS: |

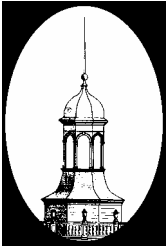

DELAWARE STATE HISTORIC PRESERVATION OFFICE
15 THE GREEN, DOVER, DE 19901

CULTURAL RESOURCE SURVEY
SECONDARY BUILDING FORM

CRS # S-11910.002

1. ADDRESS/LOCATION: 17991 Redden Road

2. FUNCTION(S): historic Garage current Garage

3. YEAR BUILT: 1940 CIRCA?: ARCHITECT/BUILDER: _____

4. STYLE/FLOOR PLAN: One pen

5. INTEGRITY: original site moved
if moved, from where original location's CRS # year

list major alterations and additions with years (if known) year
a. new siding, doors removed
b. _____

6. CURRENT CONDITION: excellent good fair poor

7. DESCRIPTION:
a. Structural system wood-framed
b. Number of stories 1
c. Wall coverings vinyl siding
d. Foundation concrete block
e. Roof
structural system gable front
coverings asphalt
openings n/a

8. DESCRIPTION OF ELEVATIONS:
a. Facade: direction: S
1) bays: 1
2) windows: n/a
3) door(s): open bay, center
4) other: _____

- b. Side: direction: W
 - 1) bays: 0
 - 2) windows:
 - 3) door(s):
 - 4) other:

- c. Side: direction: E
 - 1) bays: 0
 - 2) windows:
 - 3) door(s):
 - 4) other:

- d. Rear: direction: N
 - 1) bays: 0
 - 2) windows:
 - 3) door(s):
 - 4) other:

9. INTERIOR (if accessible):

a) Floor plan

b) Partition/walls

c) Finishes

d) Furnishings/machinery

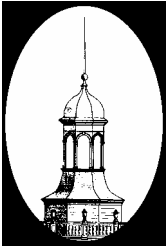

DELAWARE STATE HISTORIC PRESERVATION OFFICE
15 THE GREEN, DOVER, DE 19901

CULTURAL RESOURCE SURVEY
SECONDARY BUILDING FORM

CRS # S-11910.003

1. ADDRESS/LOCATION: 17991 Redden Road

2. FUNCTION(S): historic Shed/workshop current unknown

3. YEAR BUILT: 1940 CIRCA?: ARCHITECT/BUILDER: _____

4. STYLE/FLOOR PLAN: Bungalow/ craftsman

5. INTEGRITY: original site moved
if moved, from where original location's CRS # year

list major alterations and additions with years (if known) year

a. new siding, replaced door

b. _____

6. CURRENT CONDITION: excellent good fair poor

7. DESCRIPTION:

a. Structural system wood-framed

b. Number of stories 1

c. Wall coverings vinyl siding, modern plywood in gable

d. Foundation concrete block piers

e. Roof
structural system gable front
coverings corrugated metal
openings n/a

8. DESCRIPTION OF ELEVATIONS:

a. Facade: direction: S

1) bays: 1

2) windows: n/a

3) door(s): 1, left side, fiberglass/fiberboard with one oblong vertical light

4) other: _____

- b. Side: direction: W
 - 1) bays: 1
 - 2) windows: 1, fixed, 2-light sash
 - 3) door(s): n/a
 - 4) other:

- c. Side: direction: E
 - 1) bays: 0
 - 2) windows:
 - 3) door(s):
 - 4) other:

- d. Rear: direction: N
 - 1) bays: 1
 - 2) windows: 1, awning, 6-light
 - 3) door(s): n/a
 - 4) other:

9. INTERIOR (if accessible):

a) Floor plan

b) Partition/walls

c) Finishes

d) Furnishings/machinery

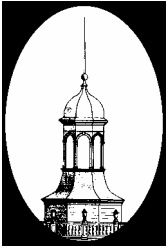

DELAWARE STATE HISTORIC PRESERVATION OFFICE
15 THE GREEN, DOVER, DE 19901

CULTURAL RESOURCE SURVEY
SECONDARY BUILDING FORM

CRS # S-11910.004

1. ADDRESS/LOCATION: 17991 Redden Road

2. FUNCTION(S): historic Agricultural current Storage shed

3. YEAR BUILT: 1940 CIRCA?: ARCHITECT/BUILDER: _____

4. STYLE/FLOOR PLAN: _____

5. INTEGRITY: original site moved
if moved, from where original location's CRS # year

list major alterations and additions with years (if known) year

a. resided in vinyl; shutters added to window openings

b. _____

6. CURRENT CONDITION: excellent good fair poor

7. DESCRIPTION:

a. Structural system wood-framed

b. Number of stories 1

c. Wall coverings vinyl siding

d. Foundation

e. Roof
structural system gable front
coverings metal
openings n/a

8. DESCRIPTION OF ELEVATIONS:

a. Facade: direction: S

1) bays: 1

2) windows: n/a

3) door(s): 1, center, wood

4) other:

- b. Side: direction: W
 - 1) bays: 1
 - 2) windows: 1, fixed, vinyl non-functional shutters
 - 3) door(s): n/a
 - 4) other:

- c. Side: direction: E
 - 1) bays: 1
 - 2) windows: 1, fixed, vinyl non-functional shutters
 - 3) door(s): n/a
 - 4) other:

- d. Rear: direction: N
 - 1) bays: 1
 - 2) Windows: 1, fixed
 - 3) door(s): n/a
 - 4) other:

9. INTERIOR (if accessible):

a) Floor plan

b) Partition/walls

c) Finishes

d) Furnishings/machinery

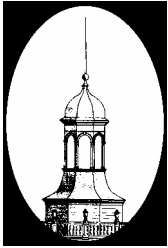

CULTURAL RESOURCE SURVEY
MAP FORM

CRS # S-11910

1. ADDRESS/LOCATION: 17991 Redden Road
2. NOT FOR PUBLICATION reason: _____
3. LOCATION MAP:

Indicate position of resource in relation to geographical landmarks such as streams and crossroads.

(attach section of USGS quad map with location marked or draw location map)

INDICATE NORTH ON SKETCH

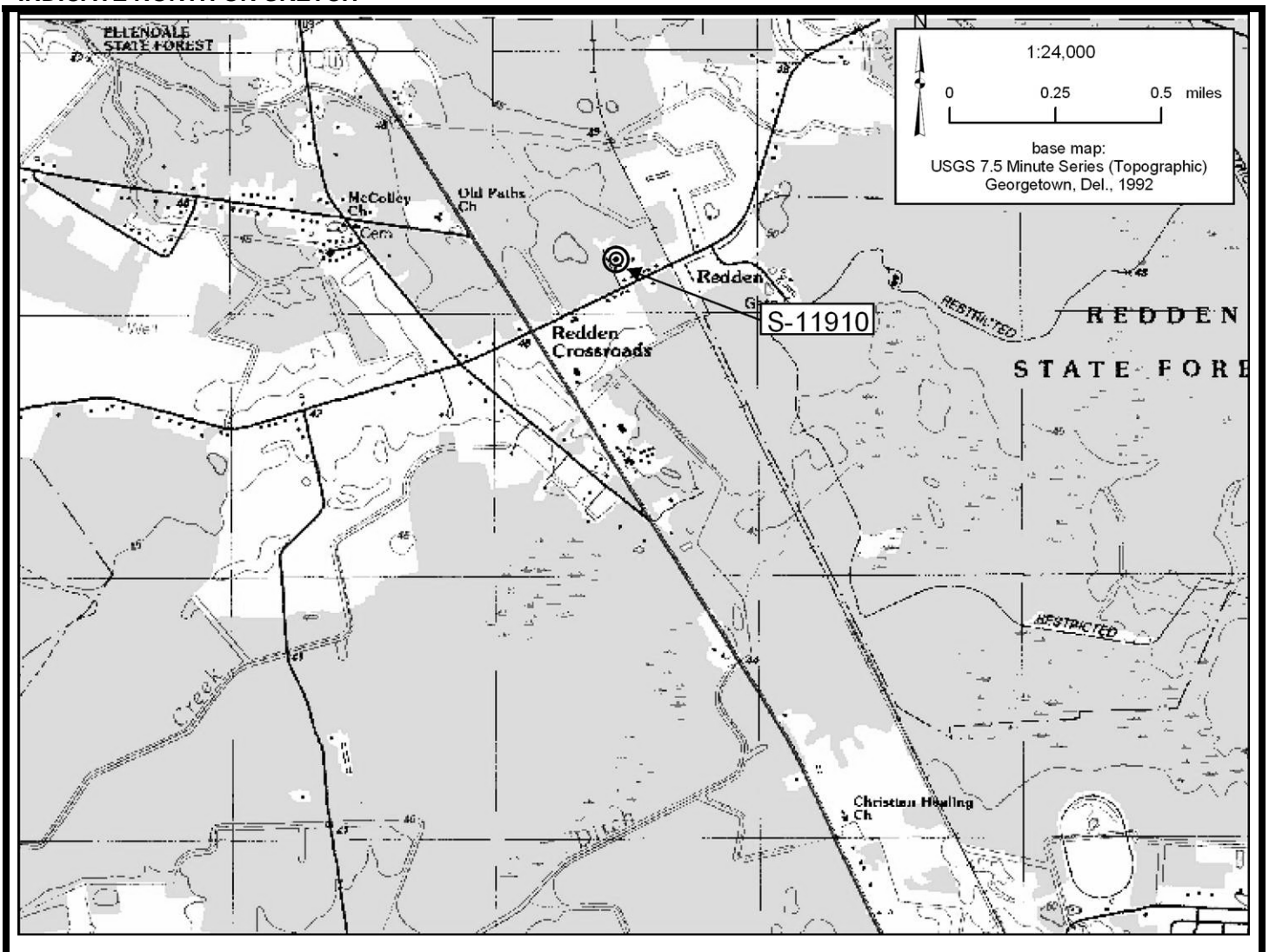

INDICATE NORTH ON PLAN

