

DELAWARE STATE HISTORIC PRESERVATION OFFICE
15 THE GREEN, DOVER, DE 19901

CULTURAL RESOURCE SURVEY
PROPERTY IDENTIFICATION FORM

CRS # S-10440
SPO Map 12-13-13
Hundred Cedar Creek
Quad Ellendale
Other _____

1. HISTORIC NAME/FUNCTION: Dwelling

2. ADDRESS/LOCATION: 10817 DuPont Highway

3. TOWN/NEAREST TOWN: Ellendale vicinity?

4. MAIN TYPE OF RESOURCE: building structure
landscape district site object

5. MAIN FUNCTION OF PROPERTY: domestic

6. PROJECT TITLE/ REASON FOR SURVEY (if applicable):

7. ADDITIONAL FORMS USED:

#:	Form:	List property types:
X	CRS 2 Main Building Form	
X	CRS 3 Secondary Building Form	
	CRS 4 Archaeological Site Form	
	CRS 5 Structure (Building-Like) Form	
	CRS 6 Structure (Land Feature) Form	
	CRS 7 Object Form	
	CRS 8 Landscape Elements Form	
X	CRS 9 Map Form	N/A
	CRS 14 Potential District Form	

8. SURVEYOR INFORMATION:

Surveyor name: Kate Farnham

Principal Investigator name: Grace Ziesing

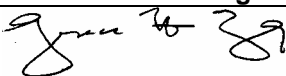
Principal Investigator signature: 

Organization: John Milner Associates, Inc Date: 4/16/2008

9. OTHER NOTES OR OBSERVATIONS:

CRS# S-10440

10. STATE HISTORIC CONTEXT FRAMEWORK (check all appropriate boxes; refer to state management plan(s)):

- a) Time period(s)
- Pre-European Contact
 - Paleo-Indian
 - Archaic
 - Woodland I
 - Woodland II

 - 1600-1750∇ Contact Period (Native American)
 - 1630-1730∇ Exploration and Frontier Settlement
 - 1730-1770∇ Intensified and Durable Occupation
 - 1770-1830∇ Early Industrialization
 - 1830-1880∇ Industrialization and Early Urbanization
 - 1880-1940∇ Urbanization and Early Suburbanization
 - 1940-1960∇ Suburbanization and Early Ex-urbanization

- b) Geographical zone
- Piedmont
 - Upper Peninsula
 - Lower Peninsula/Cypress Swamp
 - Coastal
 - Urban (City of Wilmington)

c) Historic period theme(s)

- | | |
|--|---|
| <input type="checkbox"/> Agriculture | <input type="checkbox"/> Transportation and Communication |
| <input type="checkbox"/> Forestry | <input type="checkbox"/> Settlement Patterns and Demographic Changes |
| <input type="checkbox"/> Trapping/Hunting | <input checked="" type="checkbox"/> Architecture, Engineering and Decorative Arts |
| <input type="checkbox"/> Mining/Quarrying | <input type="checkbox"/> Government |
| <input type="checkbox"/> Fishing/Oystering | <input type="checkbox"/> Religion |
| <input type="checkbox"/> Manufacturing | <input type="checkbox"/> Education |
| <input type="checkbox"/> Retailing/Wholesaling | <input type="checkbox"/> Community Organizations |
| <input type="checkbox"/> Finance | <input type="checkbox"/> Occupational Organizations |
| <input type="checkbox"/> Professional Services | <input type="checkbox"/> Major Families, Individuals and Events |

USE BLACK INK ONLY

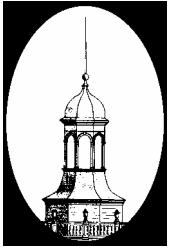

DELAWARE STATE HISTORIC PRESERVATION OFFICE
15 THE GREEN, DOVER, DE 19901

CULTURAL RESOURCE SURVEY
MAIN BUILDING FORM

CRS # S-10440.001

1. ADDRESS/LOCATION: 10817 DuPont Highway

2. FUNCTION(S): historic dwelling current dwelling

3. YEAR BUILT: 1940 CIRCA?: ARCHITECT/BUILDER:

4. STYLE OR FLOOR PLAN: WWII-Era Cottage

5. INTEGRITY: original site moved

if moved, from where other location's CRS # year

list major alterations and additions with years (if known) year

- a. windows are all aluminum
- b. back door replaced, new rear deck

6. CURRENT CONDITION: excellent good fair poor

7. DESCRIPTION: (Describe the resource as completely as possible. Use N/A for not applicable; leave no blanks.)

- a. Overall shape: rectangle Stories: 1
Additions: new rear deck
- b. Structural system (if known): concrete block
- c. Foundation: materials: not visible under stucco
basement: full partial not visible no basement
- d. Exterior walls (original if visible& any subsequent coverings): stucco
- e. Roof: shape: hipped
materials: asphalt
cornice: boxed
dormers:
chimney: location(s): center, brick

8. DESCRIPTION OF ELEVATIONS:

a.	Facade: Direction:	W
	1) Bays	3
	2) Windows	2
	fenestration	regular
	type	double hung, 1/1 aluminum; fixed picture window
	trim	aluminum
	shutters	vinyl, non-functional

Facade (cont'd)		
3)	Door(s)	1
	location	center
	type	wood and glass; half-wheel light and 4 panels
	trim	plain
4)	Porch(es)	painted old concrete stoop with iron pipe railings
b.	Side: Direction:	S
1)	Bays	1
	Windows	1
2)	fenestration	irregular
	type	double hung, 1/1 aluminum
	trim	aluminum
	shutters	vinyl, non-functional
3)	Door(s)	n/a
	location	
	type	
	trim	
4)	Porch(es)	n/a
c.	Side: Direction:	N
1)	Bays	2
2)	Windows	2
	fenestration	regular
	type	double hung, 1/1
	trim	aluminum
	shutters	vinyl, non-functional
3)	Door(s)	n/a
	location	
	type	
	trim	
4)	Porch(es)	n/a
d.	Rear: Direction:	E
1)	Bays	5
2)	Windows	4
	fenestration	irregular
	type	double hung, 1/1 aluminum
	trim	aluminum
	shutters	n/a
3)	Door(s)	1
	location	center
	type	modern fiberglass, half-wheel with 4 panels
	trim	plain
4)	Porch(es)	concrete stoop with pipe handrails; modern wood deck

9.	INTERIOR:
10.	LANDSCAPING: lawn with several large mature trees; garden statuary and shrubs along foundation; unpaved driveway on S leads back to garage NE of house. Backyard filled with junk. Wooded, overgrown at rear of property with modern shed at far rear. Tree line along sides. Lots of cars/ car parts in back.
11.	OTHER COMMENTS:

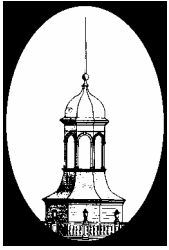

CULTURAL RESOURCE SURVEY
SECONDARY BUILDING FORM

CRS # S-10440.002

1. ADDRESS/LOCATION: 10817 DuPont Highway

2. FUNCTION(S): historic Garage current Garage

3. YEAR BUILT: 1940-1950 CIRCA?: ARCHITECT/BUILDER: _____

4. STYLE/FLOOR PLAN: Bungalow/ craftsman

5. INTEGRITY: original site moved
if moved, from where original location's CRS # year

list major alterations and additions with years (if known) year

a. side shed addition, door missing

b. _____

6. CURRENT CONDITION: excellent good fair poor

7. DESCRIPTION:

- a. Structural system concrete block
- b. Number of stories 1
- c. Wall coverings painted concrete block
- d. Foundation poured concrete slab
- e. Roof
 - structural system complex gable (jerkinhead)
 - coverings asphalt
 - openings n/a

8. DESCRIPTION OF ELEVATIONS:

- a. Facade: direction: S
 - 1) bays: 1
 - 2) windows: n/a
 - 3) door(s): 1, center, missing garage door
 - 4) other: _____

- b. Side: direction: W
 - 1) bays: 0 (side addition)
 - 2) windows:
 - 3) door(s):
 - 4) other:

- c. Side: direction: E
 - 1) bays: 0
 - 2) windows:
 - 3) door(s):
 - 4) other:

- d. Rear: direction: N
 - 1) bays: 0
 - 2) windows:
 - 3) door(s):
 - 4) other:

9. INTERIOR (if accessible):

a) Floor plan

b) Partition/walls

c) Finishes

d) Furnishings/machinery

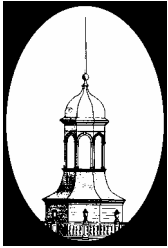

CULTURAL RESOURCE SURVEY
MAP FORM

CRS # S-10440

1. ADDRESS/LOCATION: 10817 DuPont Highway

2. NOT FOR PUBLICATION reason: _____

3. LOCATION MAP:

Indicate position of resource in relation to geographical landmarks such as streams and crossroads.

(attach section of USGS quad map with location marked or draw location map)

INDICATE NORTH ON SKETCH

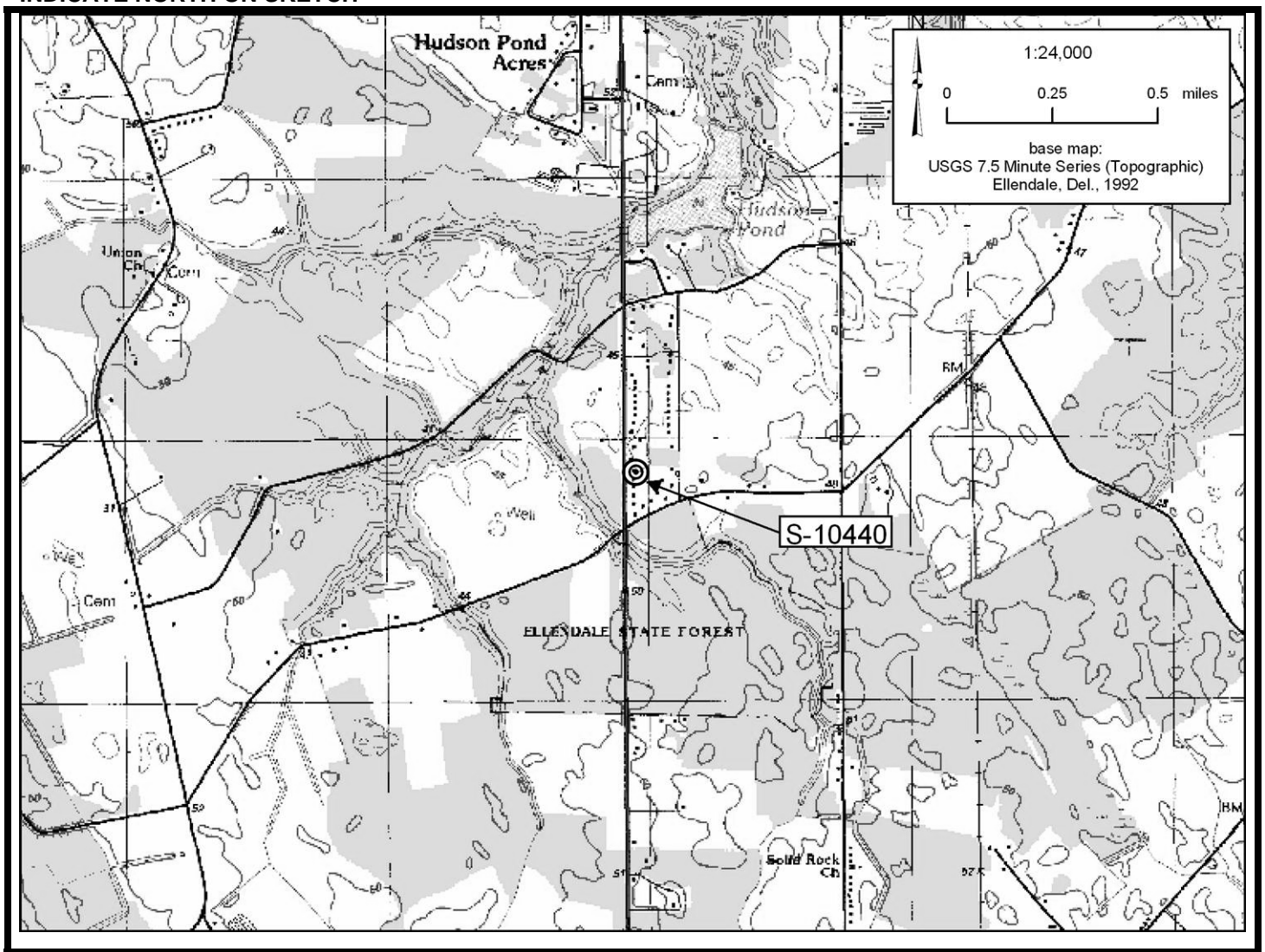

INDICATE NORTH ON PLAN

S-10440

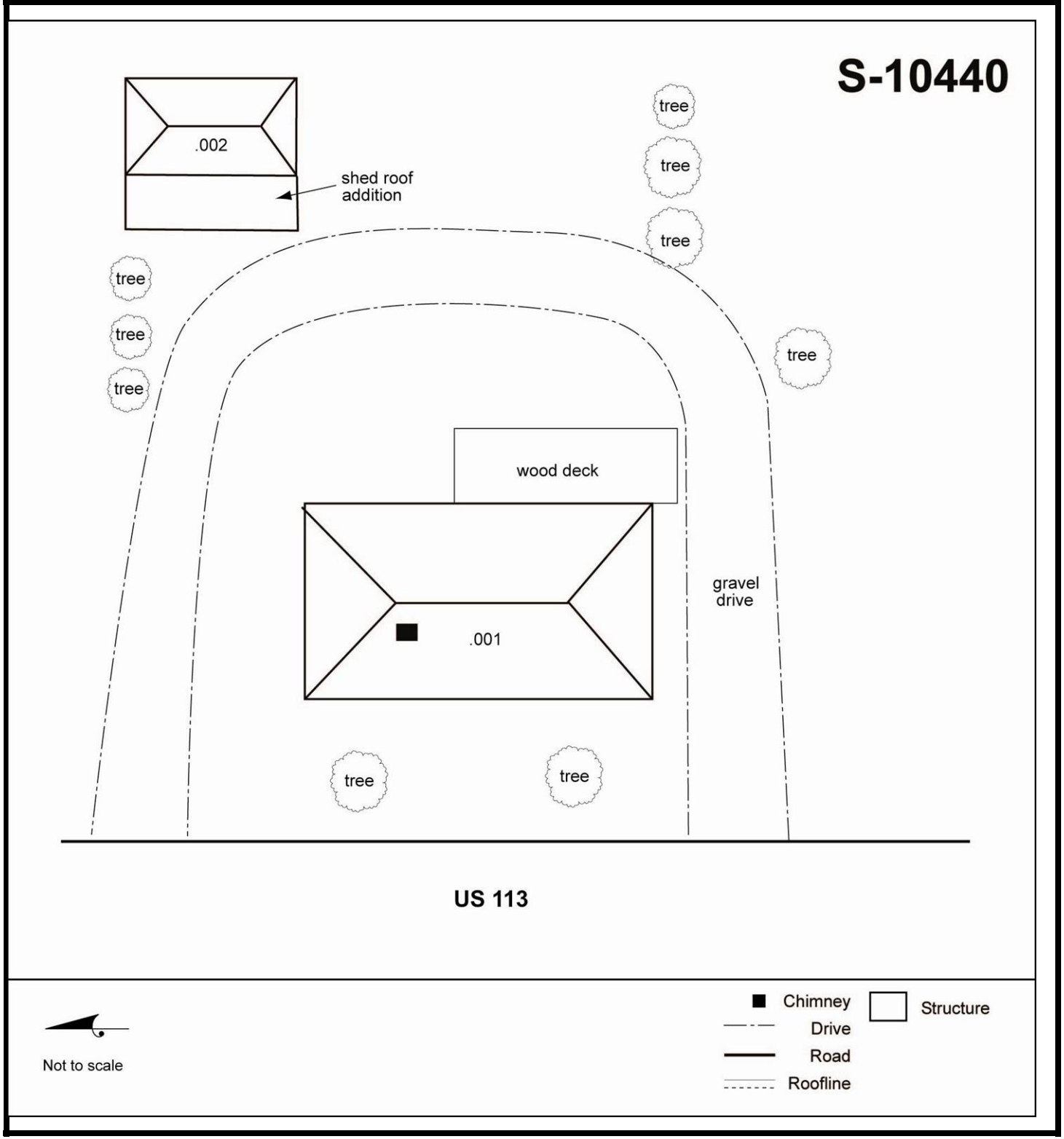

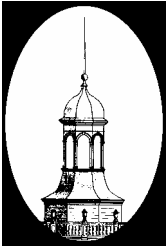

DELAWARE STATE HISTORIC PRESERVATION OFFICE
15 THE GREEN, DOVER, DE 19901

CULTURAL RESOURCE SURVEY
PROPERTY IDENTIFICATION FORM

CRS # S-10441
SPO Map 12-13-13
Hundred Cedar Creek
Quad Ellendale
Other _____

1. HISTORIC NAME/FUNCTION: Domestic Complex

2. ADDRESS/LOCATION: DuPont Highway

3. TOWN/NEAREST TOWN: Ellendale vicinity?

4. MAIN TYPE OF RESOURCE: building structure site object
landscape district

5. MAIN FUNCTION OF PROPERTY: domestic

6. PROJECT TITLE/ REASON FOR SURVEY (if applicable):

7. ADDITIONAL FORMS USED:

#:	Form:	List property types:
X	CRS 2 Main Building Form	
X	CRS 3 Secondary Building Form	
	CRS 4 Archaeological Site Form	
	CRS 5 Structure (Building-Like) Form	
	CRS 6 Structure (Land Feature) Form	
	CRS 7 Object Form	
	CRS 8 Landscape Elements Form	
X	CRS 9 Map Form	N/A
	CRS 14 Potential District Form	

8. SURVEYOR INFORMATION:

Surveyor name: Kate Farnham

Principal Investigator name: Grace Ziesing

Principal Investigator signature:

Organization: John Milner Associates, Inc Date: 4/16/2008

9. OTHER NOTES OR OBSERVATIONS:

CRS# S-10441

Property appears vacant

10. STATE HISTORIC CONTEXT FRAMEWORK (check all appropriate boxes; refer to state management plan(s)):

- a) Time period(s)
- Pre-European Contact
 - Paleo-Indian
 - Archaic
 - Woodland I
 - Woodland II
 - 1600-1750∇ Contact Period (Native American)
 - 1630-1730∇ Exploration and Frontier Settlement
 - 1730-1770∇ Intensified and Durable Occupation
 - 1770-1830∇ Early Industrialization
 - 1830-1880∇ Industrialization and Early Urbanization
 - 1880-1940∇ Urbanization and Early Suburbanization
 - 1940-1960∇ Suburbanization and Early Ex-urbanization

- b) Geographical zone
- Piedmont
 - Upper Peninsula
 - Lower Peninsula/Cypress Swamp
 - Coastal
 - Urban (City of Wilmington)

c) Historic period theme(s)

- | | |
|--|---|
| <input type="checkbox"/> Agriculture | <input type="checkbox"/> Transportation and Communication |
| <input type="checkbox"/> Forestry | <input type="checkbox"/> Settlement Patterns and Demographic Changes |
| <input type="checkbox"/> Trapping/Hunting | <input checked="" type="checkbox"/> Architecture, Engineering and Decorative Arts |
| <input type="checkbox"/> Mining/Quarrying | <input type="checkbox"/> Government |
| <input type="checkbox"/> Fishing/Oystering | <input type="checkbox"/> Religion |
| <input type="checkbox"/> Manufacturing | <input type="checkbox"/> Education |
| <input type="checkbox"/> Retailing/Wholesaling | <input type="checkbox"/> Community Organizations |
| <input type="checkbox"/> Finance | <input type="checkbox"/> Occupational Organizations |
| <input type="checkbox"/> Professional Services | <input type="checkbox"/> Major Families, Individuals and Events |

USE BLACK INK ONLY

CRS-1

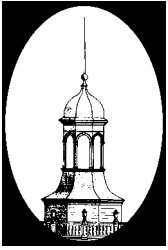

DELAWARE STATE HISTORIC PRESERVATION OFFICE
15 THE GREEN, DOVER, DE 19901

CULTURAL RESOURCE SURVEY
MAIN BUILDING FORM

CRS # S-10441.001

1. ADDRESS/LOCATION: Dupont Highway

2. FUNCTION(S): historic Domestic complex current Domestic complex

3. YEAR BUILT: 1940 CIRCA?: ARCHITECT/BUILDER:

4. STYLE OR FLOOR PLAN: WWII-Era Cottage

5. INTEGRITY: original site moved

if moved, from where other location's CRS # year

list major alterations and additions with years (if known) year

a. newer siding

b. concrete block side addition

6. CURRENT CONDITION: excellent good fair poor

7. DESCRIPTION: (Describe the resource as completely as possible. Use N/A for not applicable; leave no blanks.)

- a. Overall shape: rectangle Stories: 1
Additions: concrete block side addition
- b. Structural system (if known): wood-framed
- c. Foundation: materials: concrete block
basement: full partial not visible no basement
- d. Exterior walls (original if visible& any subsequent coverings): vinyl siding
- e. Roof: shape: side gable
materials: asphalt
cornice: boxed
dormers:
chimney: location(s): center, brick; stovepipe under chimney in addition

8. DESCRIPTION OF ELEVATIONS:

a.	Facade: Direction: W	
	1)	Bays 4
	2)	Windows 3
		fenestration irregular
		type double hung 6/6 wood – original; paired jalousie panels
		trim wood, aluminum
shutters vinyl, non-functional		

Facade (cont'd)		
3)	Door(s)	1
	location	center
	type	wood, plain modern door
	trim	plain
4)	Porch(es)	concrete slab stoop
b. Side: Direction: N		
1)	Bays	2
2)	Windows	2
	fenestration	regular
	type	double hung, 6/6, wood – original
	trim	wood
	shutters	vinyl, non-functional
3)	Door(s)	n/a
	location	
	type	
	trim	
4)	Porch(es)	n/a
c. Side: Direction: S		
1)	Bays	1 (mostly obscured by side addition)
2)	Windows	1 in breezeway type inset
	fenestration	irregular
	type	double hung, 6/6, wood
	trim	wood
	shutters	
3)	Door(s)	n/a
	location	
	type	
	trim	
4)	Porch(es)	n/a
d. Rear: Direction: E		
1)	Bays	4
2)	Windows	3
	fenestration	irregular
	type	double hung, 6/6 original; paired jalousie panels
	trim	wood
	shutters	vinyl, non-functional
3)	Door(s)	1
	location	center
	type	fiberglass-clad wood, half-wheel lights, no panels
	trim	plain
4)	Porch(es)	inset porch with old 9-light, 4 panel door – addition may have been partly original

9.	INTERIOR:
10.	LANDSCAPING: Grassy lot with overgrown trees and shrubs
11.	OTHER COMMENTS:

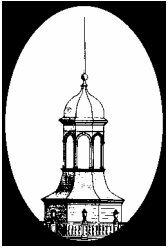

CULTURAL RESOURCE SURVEY
SECONDARY BUILDING FORM

CRS # S-10441.002

1. ADDRESS/LOCATION: Dupont Highway

2. FUNCTION(S): historic Barn/garage current Vacant/ not in use

3. YEAR BUILT: 1940 CIRCA?: ARCHITECT/BUILDER: _____

4. STYLE/FLOOR PLAN: Vernacular

5. INTEGRITY: original site moved
if moved, from where original location's CRS # year

list major alterations and additions with years (if known) year

a. windows boarded up

b. _____

6. CURRENT CONDITION: excellent good fair poor

7. DESCRIPTION:

a. Structural system wood-framed

b. Number of stories 1

c. Wall coverings horizontal wood siding in gables; painted fiberboard (?)

d. Foundation poured concrete slab

e. Roof
structural system side gable, boxed cornice
coverings metal
openings

8. DESCRIPTION OF ELEVATIONS:

a. Facade: direction: W

1) bays: 3

2) windows: 1, casement, diamond pattern casement sash (probably salvage)

3) door(s): 2, center and right, 1 batten door, 1 paired batten garage door

4) other: concrete stoop under center door

- b. Side: direction: N
 - 1) bays: 1
 - 2) windows: 2 (one per story); fixed, 4-light (broken out) on 1st floor; 3-light on 2nd floor
 - 3) door(s): n/a
 - 4) other:

- c. Side: direction: S
 - 1) bays: 1
 - 2) windows: 2 (one per story); 1/1 wood fixed sash
 - 3) door(s): n/a
 - 4) other:

- d. Rear: direction: E
 - 1) bays: 0
 - 2) windows:
 - 3) door(s):
 - 4) other:

9. INTERIOR (if accessible):

a) Floor plan

b) Partition/walls

c) Finishes

d) Furnishings/machinery

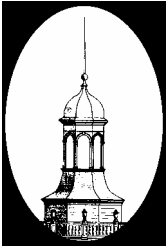

DELAWARE STATE HISTORIC PRESERVATION OFFICE
15 THE GREEN, DOVER, DE 19901

CULTURAL RESOURCE SURVEY
SECONDARY BUILDING FORM

CRS # S-10441.003

1. ADDRESS/LOCATION: Dupont Highway

2. FUNCTION(S): historic Chicken colony house current Vacant/ not in use

3. YEAR BUILT: 1950 CIRCA?: ARCHITECT/BUILDER: _____

4. STYLE/FLOOR PLAN: Vernacular

5. INTEGRITY: original site moved
if moved, from where original location's CRS # year

list major alterations and additions with years (if known) year
a. side panels/ walls missing
b.

6. CURRENT CONDITION: excellent good fair poor

7. DESCRIPTION:

- a. Structural system wood-framed
- b. Number of stories 1/2
- c. Wall coverings wood siding (vertical); metal on N side; slatted wood
- d. Foundation none
- e. Roof
 - structural system gable front
 - coverings metal
 - openings

8. DESCRIPTION OF ELEVATIONS:

- a. Facade: direction: E
 - 1) bays: 1
 - 2) windows: 0
 - 3) door(s): 1, slatted wooden door
 - 4) other:

- b. Side: direction: N
 - 1) bays: 0
 - 2) windows:
 - 3) door(s):
 - 4) other:

- c. Side: direction: S
 - 1) bays: 0
 - 2) windows:
 - 3) door(s):
 - 4) other:

- d. Rear: direction: W
 - 1) bays: 0
 - 2) windows:
 - 3) door(s):
 - 4) other:

9. INTERIOR (if accessible):

a) Floor plan

b) Partition/walls

c) Finishes

d) Furnishings/machinery

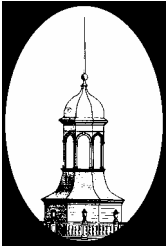

DELAWARE STATE HISTORIC PRESERVATION OFFICE
15 THE GREEN, DOVER, DE 19901

CULTURAL RESOURCE SURVEY
SECONDARY BUILDING FORM

CRS # S-10441.004

1. ADDRESS/LOCATION: Dupont Highway

2. FUNCTION(S): historic Chicken house current Vacant/ not in use

3. YEAR BUILT: 1950 CIRCA?: ARCHITECT/BUILDER: _____

4. STYLE/FLOOR PLAN: Vernacular

5. INTEGRITY: original site moved
if moved, from where original location's CRS # year

list major alterations and additions with years (if known) year
a. patched with newer materials
b. _____

6. CURRENT CONDITION: excellent good fair poor

7. DESCRIPTION:
a. Structural system wood-framed
b. Number of stories 1
c. Wall coverings metal, fiberboard
d. Foundation unknown
e. Roof
structural system shed
coverings metal
openings int. gable, terra cotta pipe chimney

8. DESCRIPTION OF ELEVATIONS:
a. Facade: direction: S
1) bays: 7, E end of building has collapsed
2) windows: screened
3) door(s): 5, evenly spaced across façade wood batten doors
4) other: _____

- b. Side: direction: E
 - 1) bays: not accessible/ collapsed
 - 2) windows:
 - 3) door(s):
 - 4) other:

- c. Side: direction: W
 - 1) bays: 1
 - 2) windows: 1, salvaged – fixed leaded glass sash
 - 3) door(s): 0
 - 4) other:

- d. Rear: direction: N
 - 1) bays: not accessible
 - 2) windows:
 - 3) door(s):
 - 4) other:

9. INTERIOR (if accessible):

a) Floor plan

b) Partition/walls

c) Finishes

d) Furnishings/machinery

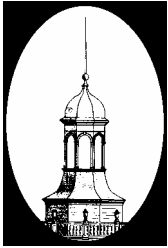

CULTURAL RESOURCE SURVEY
MAP FORM

CRS # S-10441

1. ADDRESS/LOCATION: Dupont Highway
2. NOT FOR PUBLICATION reason: _____
3. LOCATION MAP:

Indicate position of resource in relation to geographical landmarks such as streams and crossroads.

(attach section of USGS quad map with location marked or draw location map)

INDICATE NORTH ON SKETCH

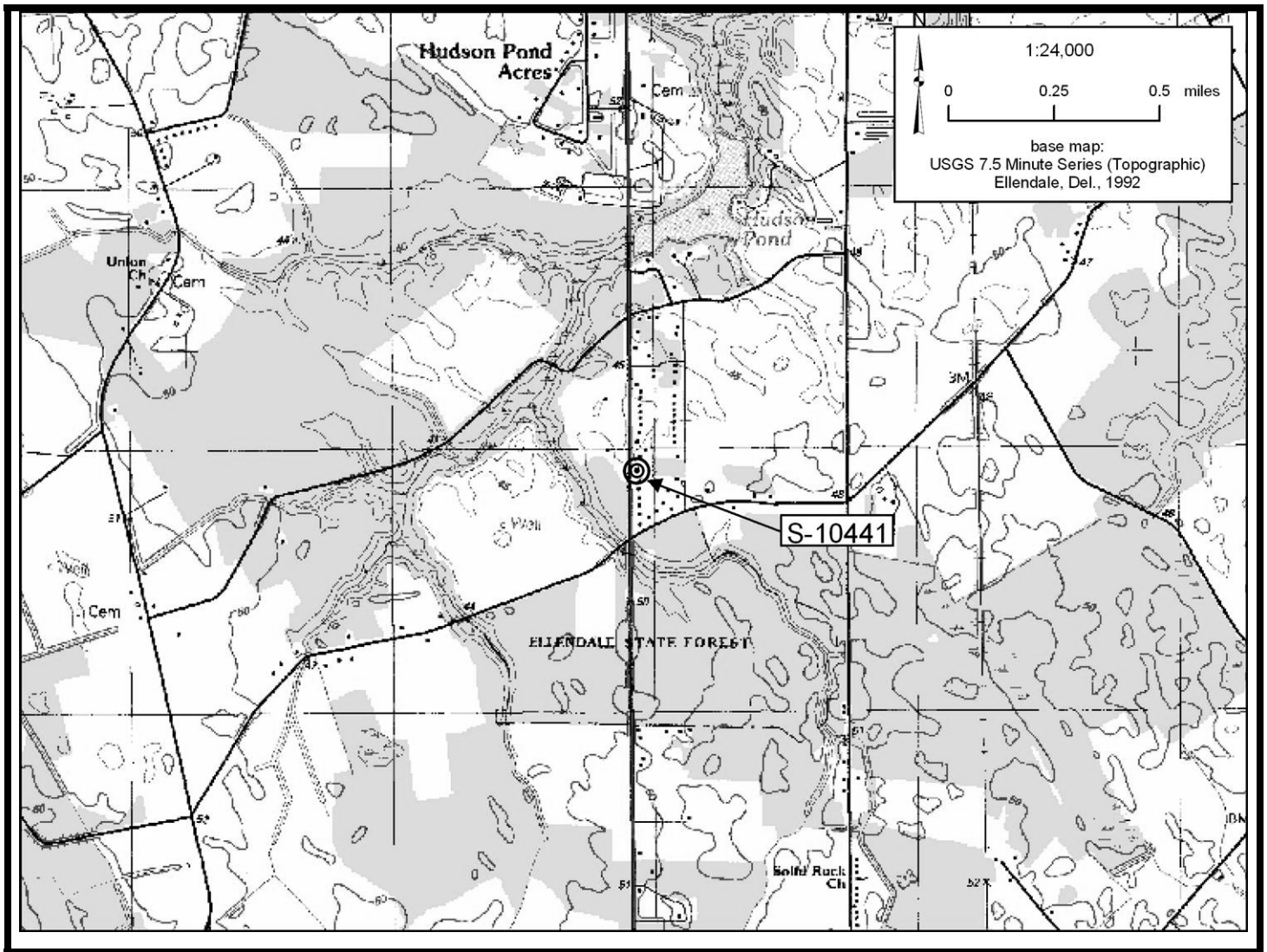

INDICATE NORTH ON PLAN

