

CULTURAL RESOURCE SURVEY
SURVEY UPDATE FORM

CRS # S-08568

1. HISTORIC NAME/FUNCTION: Dwelling

2. ADDRESS/LOCATION: U.S. 113

3. CURRENT CONDITION: excellent good fair poor demolished

4. INTEGRITY: new siding, windows, and shutters

5. SETTING INTEGRITY:

6. FORMS ADDED (give number of forms completed for each):

#:	Form:	List property types:
X	CRS 2 Main Building Form	
X	CRS 3 Secondary Building Form	
	CRS 4 Archaeological Site Form	
	CRS 5 Structure (Building-Like) Form	
	CRS 6 Structure (Land Feature) Form	
	CRS 7 Object Form	
	CRS 8 Landscape Elements Form	
X	CRS 9 Map Form	
	CRS 14 Potential District Form	

7. SURVEYOR INFORMATION:

Surveyor name: Jacky S. Taylor

Principal Investigator name: Grace H. Ziesing

Principal Investigator signature: *Grace H. Ziesing*

Organization: John Milner Associates, Inc. Date: 09/2005

8. OTHER NOTES OR OBSERVATIONS:

CRS# S-08568

Resurveyed for the U.S. 113 North/South Study by JMA on behalf of the Delaware Department of Transportation.

9. STATE HISTORIC CONTEXT FRAMEWORK (check all appropriate boxes; refer to state management plan(s)):

a) Time period(s)

- Pre-European Contact
- Paleo-Indian
- Archaic
- Woodland I
- Woodland II

- 1600-1750∇ Contact Period (Native American)
- 1630-1730∇ Exploration and Frontier Settlement
- 1730-1770∇ Intensified and Durable Occupation
- 1770-1830∇ Early Industrialization
- 1830-1880∇ Industrialization and Early Urbanization
- 1880-1940∇ Urbanization and Early Suburbanization
- 1940-1960∇ Suburbanization and Early Ex-urbanization

b) Geographical zone

- Piedmont
- Upper Peninsula
- Lower Peninsula/Cypress Swamp
- Coastal
- Urban (City of Wilmington)

c) Historic period theme(s)

- | | |
|--|---|
| <input type="checkbox"/> Agriculture | <input type="checkbox"/> Transportation and Communication |
| <input type="checkbox"/> Forestry | <input type="checkbox"/> Settlement Patterns and Demographic Changes |
| <input type="checkbox"/> Trapping/Hunting | <input checked="" type="checkbox"/> Architecture, Engineering and Decorative Arts |
| <input type="checkbox"/> Mining/Quarrying | <input type="checkbox"/> Government |
| <input type="checkbox"/> Fishing/Oystering | <input type="checkbox"/> Religion |
| <input type="checkbox"/> Manufacturing | <input type="checkbox"/> Education |
| <input type="checkbox"/> Retailing/Wholesaling | <input type="checkbox"/> Community Organizations |
| <input type="checkbox"/> Finance | <input type="checkbox"/> Occupational Organizations |
| <input type="checkbox"/> Professional Services | <input type="checkbox"/> Major Families, Individuals and Events |

USE BLACK INK ONLY

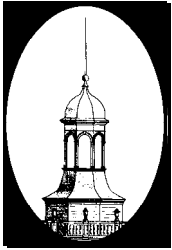

DELAWARE STATE HISTORIC PRESERVATION OFFICE
15 THE GREEN, DOVER, DE 19901

CULTURAL RESOURCE SURVEY
MAIN BUILDING FORM

CRS # S-08568.001

1.	ADDRESS/LOCATION:	U.S. 113
----	-------------------	----------

2.	FUNCTION(S):	historic: domestic	current: domestic
----	--------------	--------------------	-------------------

3.	YEAR BUILT:	early 20th century	CIRCA?:	ARCHITECT/BUILDER:
----	-------------	--------------------	---------	--------------------

4.	STYLE OR FLOOR PLAN:	double-pile cottage
----	----------------------	---------------------

5.	INTEGRITY:	original site	<input checked="" type="checkbox"/>	moved	<input type="checkbox"/>
----	------------	---------------	-------------------------------------	-------	--------------------------

if moved, from where

other location's CRS #

year

list major alterations and additions with years (if known)

year

a. new aluminum siding, windows, and vinyl shutters

b.

6.	CURRENT CONDITION:	excellent	<input type="checkbox"/>	good	<input type="checkbox"/>	fair	<input checked="" type="checkbox"/>	poor	<input type="checkbox"/>
----	--------------------	-----------	--------------------------	------	--------------------------	------	-------------------------------------	------	--------------------------

7.	DESCRIPTION: (Describe the resource as completely as possible. Use N/A for not applicable; leave no blanks.)
----	--

a. Overall shape: rectangle
Additions:

Stories: 1-1/2

b. Structural system (if known): wood-framed

c. Foundation: materials: panel-faced concrete block
basement: full partial not visible no basement

d. Exterior walls (original if visible& any subsequent coverings): aluminum siding

e. Roof: shape: side gable
materials: asphalt shingles
cornice: decorative barge board
dormers: 2 full-width dormers, one in front, one in rear
chimney: location(s): brick, in rear dormer

8.	DESCRIPTION OF ELEVATIONS:
----	----------------------------

a.	Facade: Direction: west
1)	Bays: 2
2)	Windows: 2, first story; 2, second story
	Fenestration: regular
	Type: 1/1 double-hung sash
	Trim: aluminum
	Shutters: vinyl, non-functional

	Facade (cont'd)
3)	Door(s): 1 Location: side Type: wood Trim: plain
4)	Porch(es):
b.	Side: Direction: south
1)	Bays: 2
2)	Windows: 2, first story; 2, second story Fenestration: regular Type: 1/1 double-hung sash Trim: aluminum Shutters: vinyl, non-functional
3)	Door(s): none Location: Type: Trim:
4)	Porch(es):
c.	Side: Direction: north
1)	Bays: 3
2)	Windows: 2, first story; 2, second story Fenestration: irregular Type: 6/6 and 1/1 double-hung sash Trim: Shutters: vinyl, non-functional
3)	Door(s): 1 Location: Type: other Trim: plain
4)	Porch(es):
d.	Rear: Direction: east
1)	Bays: [obscured by enclosed porch]
2)	Windows: 4, first story Fenestration: irregular Type: 6/6 double-hung sash; 2 sliding French doors Trim: Shutters:
3)	Door(s): Location: Type: Trim:
4)	Porch(es): shed roof enclosed porch with asphalt shingles

9.	INTERIOR:
----	------------------

10.	LANDSCAPING: mature trees and shrubs in front; woodland in rear
-----	--

11.	OTHER COMMENTS:
-----	------------------------

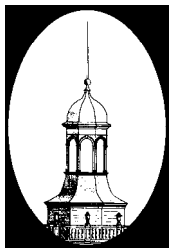

DELAWARE STATE HISTORIC PRESERVATION OFFICE
15 THE GREEN, DOVER, DE 19901

CULTURAL RESOURCE SURVEY
SECONDARY BUILDING FORM

CRS # S-08568.002

1. ADDRESS/LOCATION: U.S. 113

2. FUNCTION(S): historic garage current garage

3. YEAR BUILT: 1880-1940 CIRCA?: Y ARCHITECT/BUILDER: _____

4. STYLE/FLOOR PLAN: Vernacular

5. INTEGRITY: original site _____ moved _____
if moved, from where _____ original location's CRS # _____ year _____

list major alterations and additions with years (if known) _____ year _____

a. asphalt shingles on roof, particle board on rear facade

b. _____

6. CURRENT CONDITION: excellent _____ good _____ fair poor _____

7. DESCRIPTION:

a. Structural system wood-frame

b. Number of stories 1

c. Wall coverings Wood Siding Vertical

d. Foundation concrete block

e. Roof
structural system
coverings
openings

8. DESCRIPTION OF ELEVATIONS:

a. Facade: direction: west

1) bays: 2

2) windows:

3) door(s): Count: 2; Type: wood
Details: sliding garage doors

4) other:

- b. **Side: direction:** south
 - 1) **bays:** 1
 - 2) **windows:** Count: 2; regular ; awning
 - 3) **door(s):**
 - 4) **other:**

- c. **Side: direction:** north
 - 1) **bays:** 1
 - 2) **windows:** Count: 2; regular ; awning
 - 3) **door(s):**
 - 4) **other:**

- d. **Rear: direction:** east
 - 1) **bays:**
 - 2) **windows:**
 - 3) **door(s):**
 - 4) **other:**

9. **INTERIOR (if accessible):**

a) **Floor plan**

rectangle

b) **Partition/walls**

c) **Finishes**

d) **Furnishings/machinery**

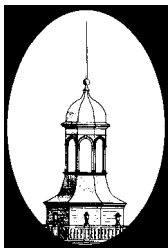

DELAWARE STATE HISTORIC PRESERVATION OFFICE
15 THE GREEN, DOVER, DE 19901

CULTURAL RESOURCE SURVEY
MAP FORM

CRS # S-08568

1. ADDRESS/LOCATION: U.S. Route 113
2. NOT FOR PUBLICATION reason: _____
3. LOCATION MAP:

Indicate position of resource in relation to geographical landmarks such as streams and crossroads.

(attach section of USGS quad map with location marked or draw location map)

INDICATE NORTH ON SKETCH

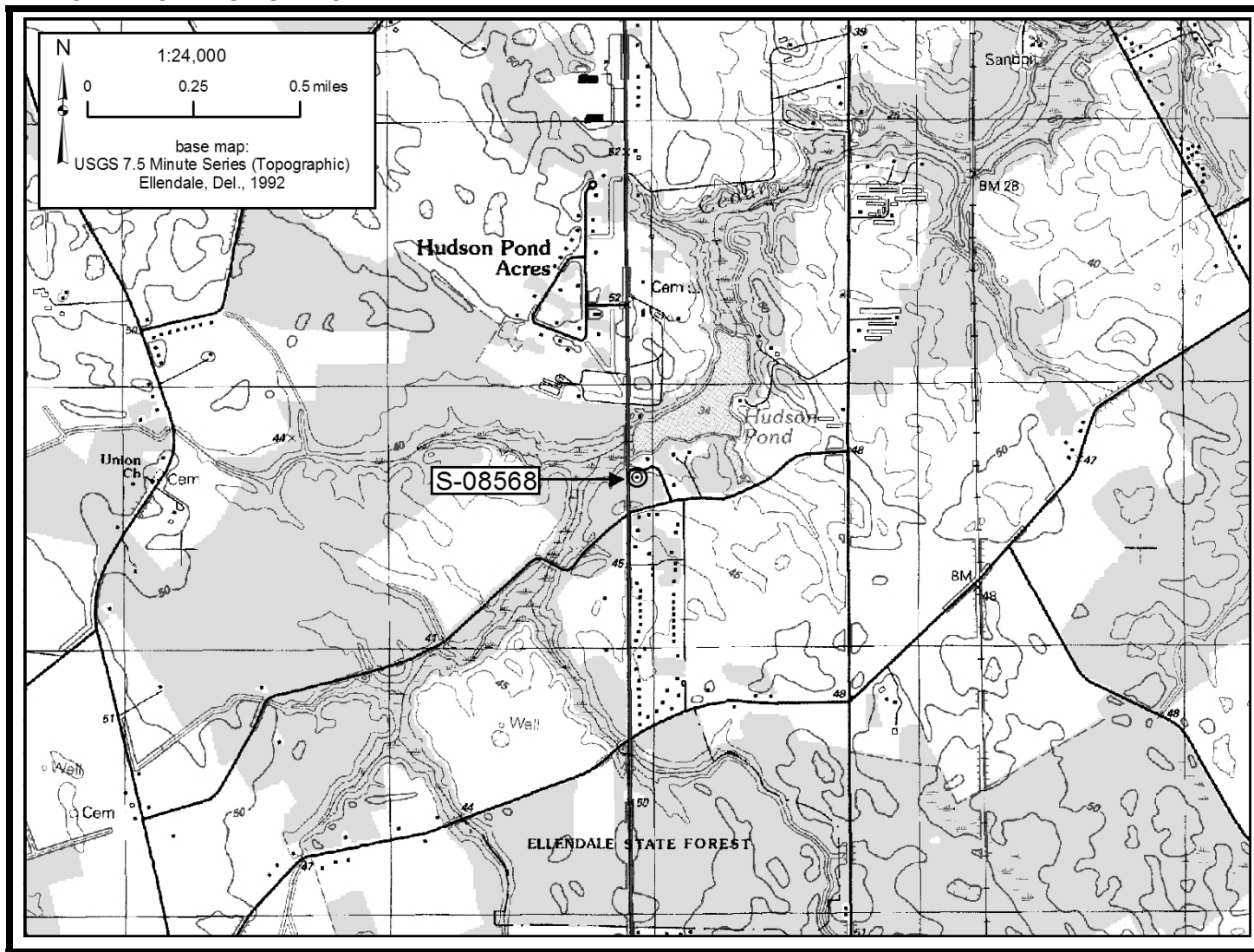

INDICATE NORTH ON PLAN

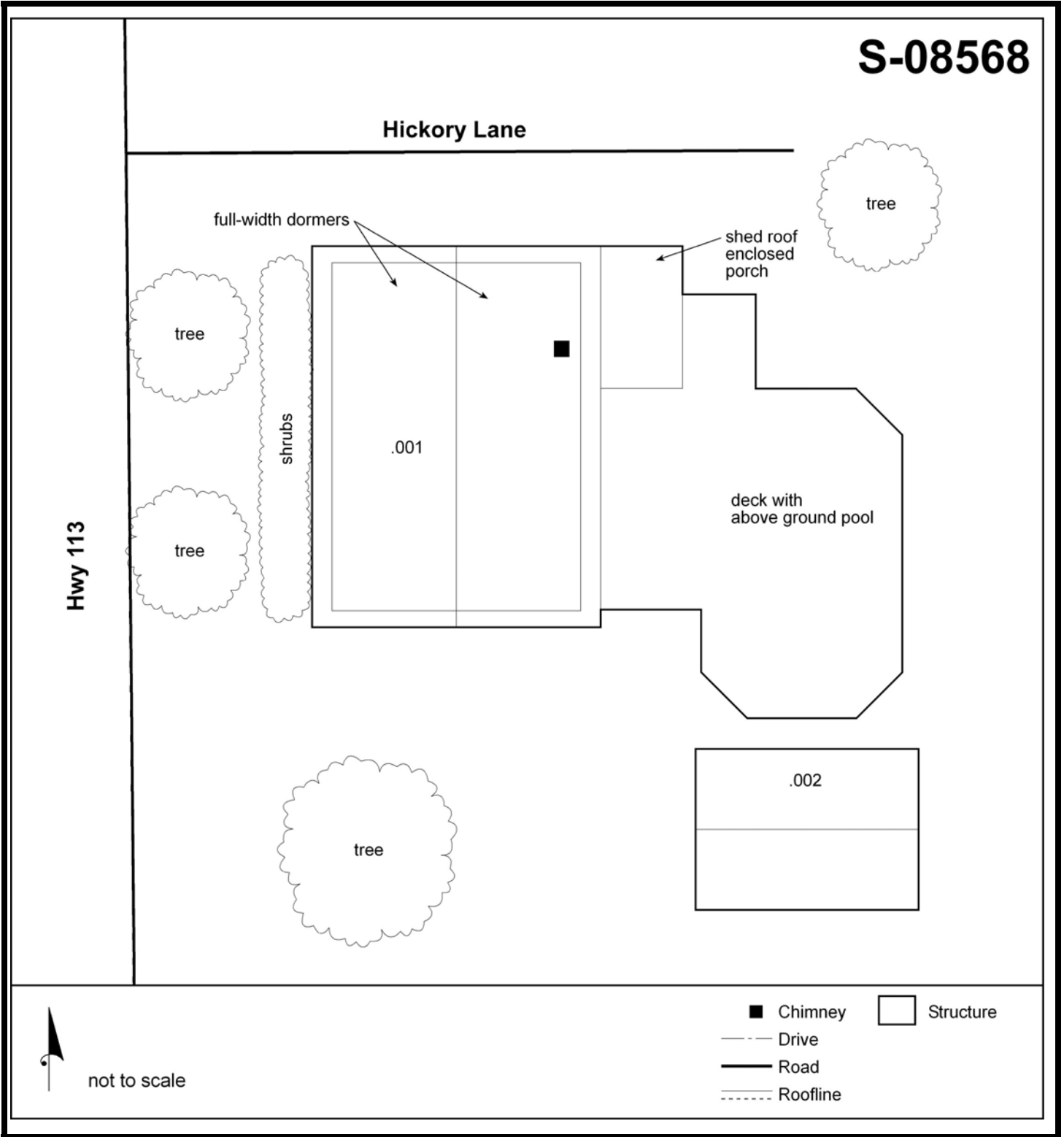

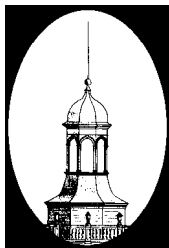

DELAWARE STATE HISTORIC PRESERVATION OFFICE
15 THE GREEN, DOVER, DE 19901

CULTURAL RESOURCE SURVEY
SURVEY UPDATE FORM

CRS # S-08569

1. HISTORIC NAME/FUNCTION: Dwelling

2. ADDRESS/LOCATION: U.S. Route 113

3. CURRENT CONDITION: excellent good fair poor demolished

4. INTEGRITY: vinyl siding, new windows and shutters; shed-roof addition to south side; rear porch enclosed

5. SETTING INTEGRITY:

6. FORMS ADDED (give number of forms completed for each):

#:	Form:	List property types:
X	CRS 2 Main Building Form	
	CRS 3 Secondary Building Form	
	CRS 4 Archaeological Site Form	
	CRS 5 Structure (Building-Like) Form	
	CRS 6 Structure (Land Feature) Form	
	CRS 7 Object Form	
	CRS 8 Landscape Elements Form	
X	CRS 9 Map Form	
	CRS 14 Potential District Form	

7. SURVEYOR INFORMATION:

Surveyor name: Jacky S. Taylor

Principal Investigator name: Grace H. Ziesing

Principal Investigator signature: *Grace H. Ziesing*

Organization: John Milner Associates, Inc. Date: 09/2005

8. OTHER NOTES OR OBSERVATIONS:

CRS# S-08569

Resurveyed for the U.S. 113 North/South Study by JMA on behalf of the Delaware Department of Transportation.

9. STATE HISTORIC CONTEXT FRAMEWORK (check all appropriate boxes; refer to state management plan(s)):

- a) Time period(s)
- Pre-European Contact
 - Paleo-Indian
 - Archaic
 - Woodland I
 - Woodland II

 - 1600-1750—Contact Period (Native American)
 - 1630-1730—Exploration and Frontier Settlement
 - 1730-1770—Intensified and Durable Occupation
 - 1770-1830—Early Industrialization
 - 1830-1880—Industrialization and Early Urbanization
 - 1880-1940—Urbanization and Early Suburbanization
 - 1940-1960—Suburbanization and Early Ex-urbanization

- b) Geographical zone
- Piedmont
 - Upper Peninsula
 - Lower Peninsula/Cypress Swamp
 - Coastal
 - Urban (City of Wilmington)

c) Historic period theme(s)

- | | |
|--|---|
| <input type="checkbox"/> Agriculture | <input type="checkbox"/> Transportation and Communication |
| <input type="checkbox"/> Forestry | <input type="checkbox"/> Settlement Patterns and Demographic Changes |
| <input type="checkbox"/> Trapping/Hunting | <input checked="" type="checkbox"/> Architecture, Engineering and Decorative Arts |
| <input type="checkbox"/> Mining/Quarrying | <input type="checkbox"/> Government |
| <input type="checkbox"/> Fishing/Oystering | <input type="checkbox"/> Religion |
| <input type="checkbox"/> Manufacturing | <input type="checkbox"/> Education |
| <input type="checkbox"/> Retailing/Wholesaling | <input type="checkbox"/> Community Organizations |
| <input type="checkbox"/> Finance | <input type="checkbox"/> Occupational Organizations |
| <input type="checkbox"/> Professional Services | <input type="checkbox"/> Major Families, Individuals and Events |

USE BLACK INK ONLY

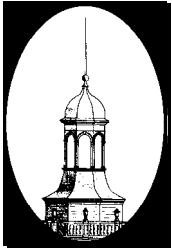

DELAWARE STATE HISTORIC PRESERVATION OFFICE
15 THE GREEN, DOVER, DE 19901

CULTURAL RESOURCE SURVEY
MAIN BUILDING FORM

CRS # S-08569.001

1.	ADDRESS/LOCATION:	U.S. Route 113
----	-------------------	----------------

2.	FUNCTION(S):	historic: domestic	current: domestic
----	--------------	--------------------	-------------------

3.	YEAR BUILT:	early to mid 20th century	CIRCA?:	ARCHITECT/BUILDER:	
----	-------------	---------------------------	---------	--------------------	--

4.	STYLE OR FLOOR PLAN:	double-pile cottage
----	----------------------	---------------------

5.	INTEGRITY:	original site		moved	
----	------------	---------------	--	-------	--

if moved, from where other location's CRS # year

list major alterations and additions with years (if known) year

a. vinyl siding, new windows and shutters; shed-roof addition to south side; rear porch enclosed

b.

6.	CURRENT CONDITION:	excellent		good		fair	<input checked="" type="checkbox"/>	poor	
----	--------------------	-----------	--	------	--	------	-------------------------------------	------	--

7.	DESCRIPTION: (Describe the resource as completely as possible. Use N/A for not applicable; leave no blanks.)
----	--

- a. Overall shape: rectangle Stories: 1-1/2
Additions: shed-roof addition to south side
- b. Structural system (if known): wood-framed
- c. Foundation: materials: panel-faced concrete block
basement: full partial not visible no basement
- d. Exterior walls (original if visible& any subsequent coverings): vinyl siding
- e. Roof: shape: side gable
materials: aluminum
cornice: boxed
dormers: shed-roof dormer with asphalt shingles and two 3/1 double-hung sash windows
chimney: location(s): brick; interior gable end, and center

8.	DESCRIPTION OF ELEVATIONS:
----	----------------------------

a.	Facade: Direction: west
1)	Bays: 3
2)	Windows: 3
	Fenestration:
	Type: 3/1 and 1/1, double-hung sash
	Trim: wood and aluminum
	Shutters:

	Facade (cont'd)
3)	Door(s): 1
	Location:
	Type: wood-and-glass (3 panes)
	Trim:
4)	Porch(es):
b.	Side: Direction: north
1)	Bays: 1
2)	Windows: 1, first story; 1, second story
	Fenestration: regular
	Type: 3/1, double-hung sash
	Trim: wood and aluminum
	Shutters: vinyl, non-functional
3)	Door(s):
	Location:
	Type:
	Trim:
4)	Porch(es):
c.	Side: Direction: south
1)	Bays: [obscured by addition]
2)	Windows: 2, first story; 1, second story
	Fenestration: regular
	Type: 3-part bay and 1/1, double-hung sash
	Trim: aluminum
	Shutters:
3)	Door(s):
	Location: center
	Type: other
	Trim: plain
4)	Porch(es):
d.	Rear: Direction: east
1)	Bays: [obscured by addition]
2)	Windows: 3, first story
	Fenestration: regular
	Type: 1/1, double-hung sash
	Trim: aluminum
	Shutters:
3)	Door(s): 1 [obscured]
	Location:
	Type:
	Trim:
4)	Porch(es): shed-roof enclosed porch

9.	INTERIOR:
----	------------------

10.	LANDSCAPING: on main road, surrounded by woods
-----	---

11.	OTHER COMMENTS:
-----	------------------------



DELAWARE STATE HISTORIC PRESERVATION OFFICE
15 THE GREEN, DOVER, DE 19901

CULTURAL RESOURCE SURVEY
MAP FORM

CRS # S-08569

1. ADDRESS/LOCATION: U.S. Route 113
2. NOT FOR PUBLICATION reason: _____
3. LOCATION MAP:

Indicate position of resource in relation to geographical landmarks such as streams and crossroads.

(attach section of USGS quad map with location marked or draw location map)

INDICATE NORTH ON SKETCH

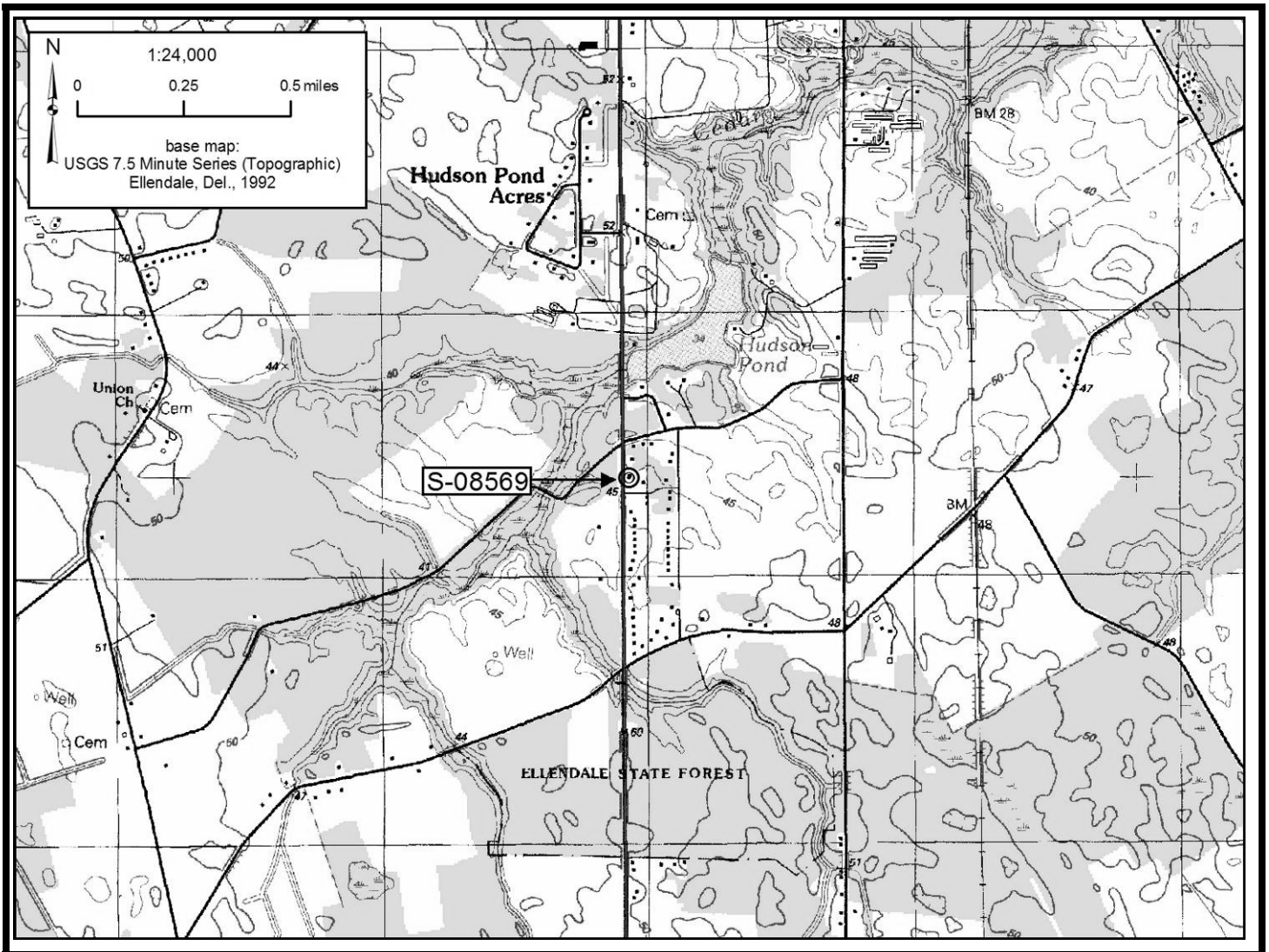

INDICATE NORTH ON PLAN

S-08569

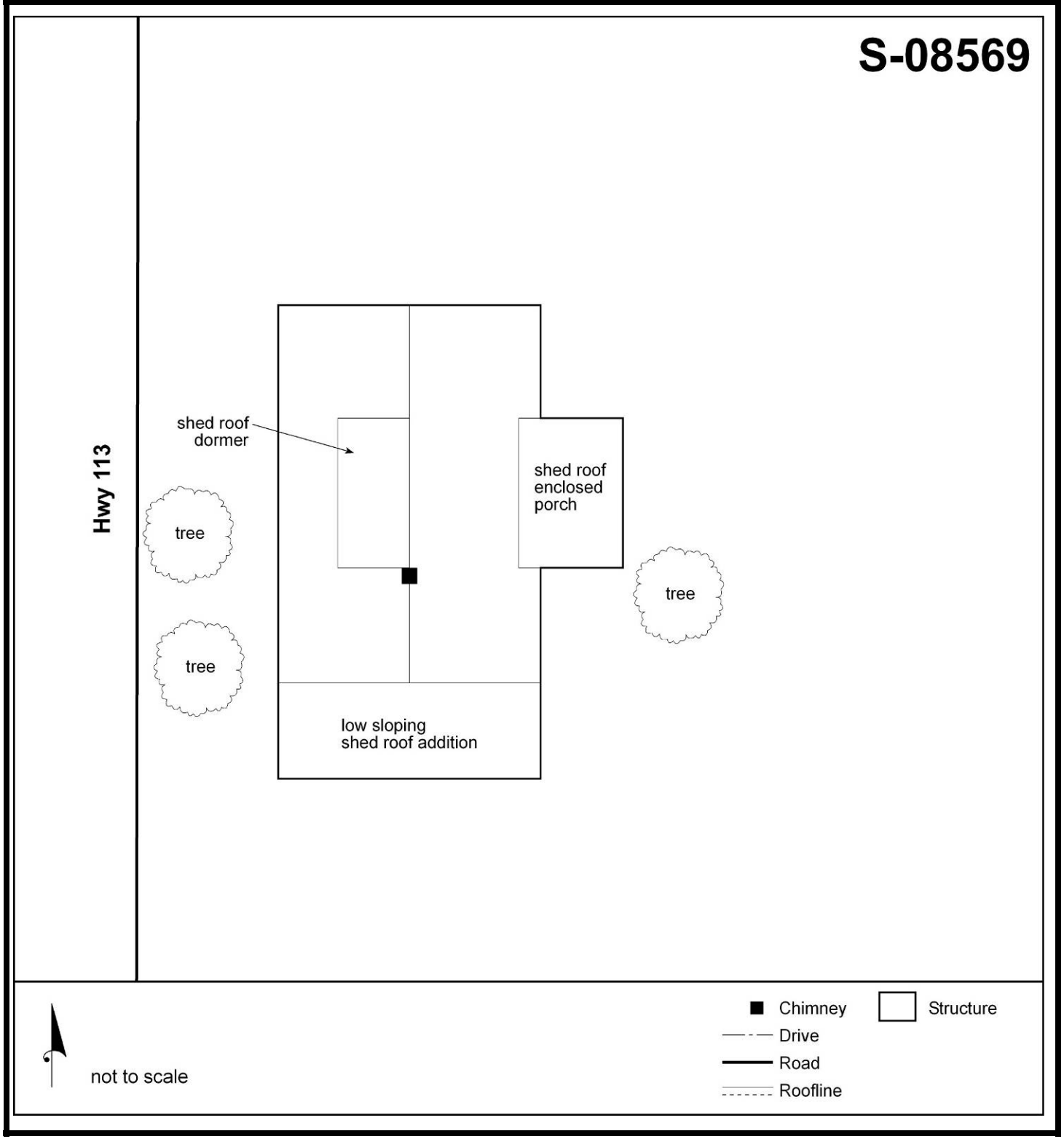

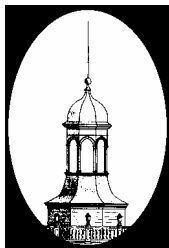

CULTURAL RESOURCE SURVEY
SURVEY UPDATE FORM

CRS # S-08570

1. HISTORIC NAME/FUNCTION: Dwelling

2. ADDRESS/LOCATION: DuPont Hwy

3. CURRENT CONDITION: excellent good fair poor demolished

4. INTEGRITY: new front door and breezeway door/windows on house, new stucco on house, openings on stand boarded up

5. SETTING INTEGRITY: newer trailer homes on either side

6. FORMS ADDED (give number of forms completed for each):

#:	Form:	List property types:
X	CRS 2 Main Building Form	
X	CRS 3 Secondary Building Form	
	CRS 4 Archaeological Site Form	
	CRS 5 Structure (Building-Like) Form	
	CRS 6 Structure (Land Feature) Form	
	CRS 7 Object Form	
	CRS 8 Landscape Elements Form	
X	CRS 9 Map Form	N/A
	CRS 14 Potential District Form	

7. SURVEYOR INFORMATION:

Surveyor name: Kate Farnham

Principal Investigator name: Grace Ziesing

Principal Investigator signature:

Organization: John Milner Associates, Inc Date: 8/1/2008

8. OTHER NOTES OR OBSERVATIONS:

CRS# S-08570

Resurveyed for US113 North/South Study, Delaware Department of Transportation, by John Milner Associates, Inc.

House and shop on same parcel. Small ranch-style dwelling.

9. STATE HISTORIC CONTEXT FRAMEWORK (check all appropriate boxes; refer to state management plan(s)):

- a) Time period(s)
- Pre-European Contact
 - Paleo-Indian
 - Archaic
 - Woodland I
 - Woodland II
 - 1600-1750∇ Contact Period (Native American)
 - 1630-1730∇ Exploration and Frontier Settlement
 - 1730-1770∇ Intensified and Durable Occupation
 - 1770-1830∇ Early Industrialization
 - 1830-1880∇ Industrialization and Early Urbanization
 - 1880-1940∇ Urbanization and Early Suburbanization
 - 1940-1960∇ Suburbanization and Early Ex-urbanization

- b) Geographical zone
- Piedmont
 - Upper Peninsula
 - Lower Peninsula/Cypress Swamp
 - Coastal
 - Urban (City of Wilmington)

c) Historic period theme(s)

- | | |
|---|--|
| <input type="checkbox"/> Agriculture | <input type="checkbox"/> Transportation and Communication |
| <input type="checkbox"/> Forestry | <input type="checkbox"/> Settlement Patterns and Demographic Changes |
| <input type="checkbox"/> Trapping/Hunting | <input type="checkbox"/> Architecture, Engineering and Decorative Arts |
| <input type="checkbox"/> Mining/Quarrying | <input type="checkbox"/> Government |
| <input type="checkbox"/> Fishing/Oystering | <input type="checkbox"/> Religion |
| <input type="checkbox"/> Manufacturing | <input type="checkbox"/> Education |
| <input checked="" type="checkbox"/> Retailing/Wholesaling | <input type="checkbox"/> Community Organizations |
| <input type="checkbox"/> Finance | <input type="checkbox"/> Occupational Organizations |
| <input type="checkbox"/> Professional Services | <input type="checkbox"/> Major Families, Individuals and Events |

USE BLACK INK ONLY

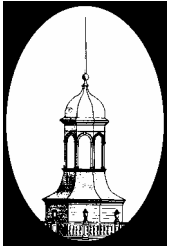

DELAWARE STATE HISTORIC PRESERVATION OFFICE
15 THE GREEN, DOVER, DE 19901

CULTURAL RESOURCE SURVEY
MAIN BUILDING FORM

CRS # S-08570.001

1. ADDRESS/LOCATION: DuPont Hwy

2. FUNCTION(S): historic Domestic current Domestic

3. YEAR BUILT: 1950 CIRCA?: ARCHITECT/BUILDER:

4. STYLE OR FLOOR PLAN: Double pen, ranch

5. INTEGRITY: original site moved

if moved, from where other location's CRS # year

list major alterations and additions with years (if known) year

a. new door on front, new breezeway enclosure

b. stucco cladding over entire house (excepting rear wall)

6. CURRENT CONDITION: excellent good fair poor

7. DESCRIPTION: (Describe the resource as completely as possible. Use N/A for not applicable; leave no blanks.)

a. Overall shape: rectangle Stories: 1
Additions:

b Structural system (if known): wood-framed

c. Foundation: materials: concrete block
basement: full partial not visible no basement

d. Exterior walls (original if visible& any subsequent coverings): stucco, wood shingle (on rear)

e. Roof: shape: side gable
materials: asphalt
cornice: boxed
dormers:
chimney: location(s):

8. DESCRIPTION OF ELEVATIONS:

a.	Facade: Direction: W	
	1)	Bays 5
	2)	Windows 3
		fenestration regular
		type double-hung, 2/2, horizontal dividers
		trim wood
shutters		

	Facade (cont'd)	
3)	Door(s)	2
	location	center, side
	type	wood beadboard paired garage doors; front door – modern fiberglass w/oval leaded glass window
	trim	plain
4)	Porch(es)	gabled entry porch clad entirely in stucco; concrete steps
b.	Side: Direction: N	
1)	Bays	2
2)	Windows	2
	fenestration	regular
	type	double-hung, 2/2, horizontal dividers
	trim	wood
	shutters	
3)	Door(s)	
	location	
	type	
	trim	
4)	Porch(es)	
c.	Side: Direction: S	
1)	Bays	1
2)	Windows	1
	fenestration	regular
	type	double-hung, 2/2
	trim	wood
	shutters	
3)	Door(s)	
	location	
	type	
	trim	
4)	Porch(es)	
d.	Rear: Direction: E	
1)	Bays	5
2)	Windows	4
	fenestration	irregular
	type	double-hung, 2/2
	trim	wood
	shutters	
3)	Door(s)	1
	location	center
	type	fiberglass, 9-light, 2 panel
	trim	plain
4)	Porch(es)	large, shed-roofed screened porch - modern

9.	INTERIOR:
10.	LANDSCAPING: Gravel driveway on S end of parcel leads straight back to garage. Shaded lawn with some big trees, beautiful rock gardens and flowerbeds around foundation and in middle of yard, large open grassy backyard
11.	OTHER COMMENTS:

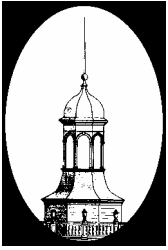

DELAWARE STATE HISTORIC PRESERVATION OFFICE
15 THE GREEN, DOVER, DE 19901

CULTURAL RESOURCE SURVEY
SECONDARY BUILDING FORM

CRS # S-08570.002

1. ADDRESS/LOCATION: DuPont Hwy

2. FUNCTION(S): historic Commerce/ trade current Vacant/ not in use

3. YEAR BUILT: 1950 CIRCA?: ARCHITECT/BUILDER: _____

4. STYLE/FLOOR PLAN: Vernacular, one pen

5. INTEGRITY: original site moved
if moved, from where original location's CRS # year

list major alterations and additions with years (if known) year

a. most openings boarded up with painted plywood, front doors and windows on S section of
façade were removed and covered with plywood siding

6. CURRENT CONDITION: excellent good fair poor

7. DESCRIPTION:

- a. Structural system wood-framed
- b. Number of stories 1
- c. Wall coverings wood siding (horizontal and vertical)
- d. Foundation concrete block (piers)
- e. Roof
structural system side gable, salt box, exposed rafter ends
coverings asphalt
openings

8. DESCRIPTION OF ELEVATIONS:

- a. Facade: direction: W
 - 1) bays: 5
 - 2) windows: 4
 - 3) door(s): 1, center, wood and glass, 3-lights (original)
 - 4) other: inset porch on NW corner along front – shed roof. Plain posts on ground, small wooden steps at door, no floor

- b. Side: direction: N
 - 1) bays: 1
 - 2) windows: 0 (most all openings covered with plywood cladding)
 - 3) door(s): 1, side (within porch), wood and glass, 6-light, 2 panel
 - 4) other: inset porch, same as façade

- c. Side: direction: S
 - 1) bays: 1
 - 2) windows: 1, double hung, 1/1, modern
 - 3) door(s): 0
 - 4) other:

- d. Rear: direction: E
 - 1) bays: 4
 - 2) windows: 4, fixed, 1 - boarded up
 - 3) door(s): 0
 - 4) other:

9. INTERIOR (if accessible):

a) Floor plan

b) Partition/walls

c) Finishes

d) Furnishings/machinery

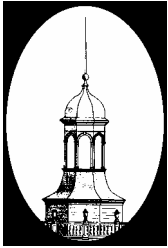

CULTURAL RESOURCE SURVEY
MAP FORM

CRS # S-08570

1. ADDRESS/LOCATION: DuPont Hwy

2. NOT FOR PUBLICATION reason: _____

3. LOCATION MAP:

Indicate position of resource in relation to geographical landmarks such as streams and crossroads.

(attach section of USGS quad map with location marked or draw location map)

INDICATE NORTH ON SKETCH

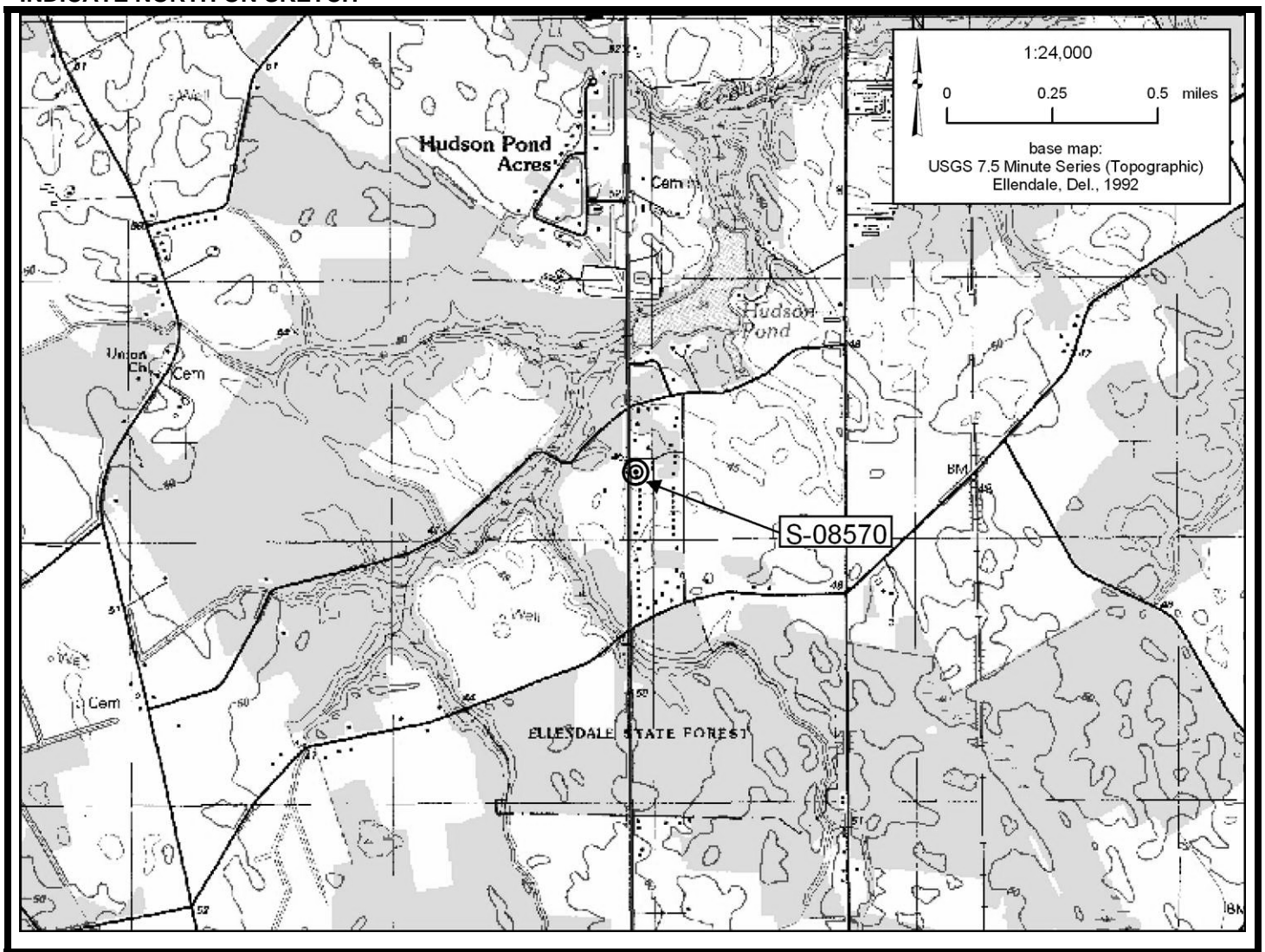

INDICATE NORTH ON PLAN

