

CULTURAL RESOURCE SURVEY
SURVEY UPDATE FORM

CRS # S-03828

1. HISTORIC NAME/FUNCTION: Dwelling

2. ADDRESS/LOCATION: Old State Road

3. CURRENT CONDITION: excellent good fair poor demolished

4. INTEGRITY:

5. SETTING INTEGRITY:

6. FORMS ADDED (give number of forms completed for each):

#:	Form:	List property types:
	CRS 2 Main Building Form	
	CRS 3 Secondary Building Form	
	CRS 4 Archaeological Site Form	
	CRS 5 Structure (Building-Like) Form	
	CRS 6 Structure (Land Feature) Form	
	CRS 7 Object Form	
	CRS 8 Landscape Elements Form	
	CRS 9 Map Form	N/A
	CRS 14 Potential District Form	

7. SURVEYOR INFORMATION:

Surveyor name: Kate Farnham

Principal Investigator name: Grace Ziesing

Principal Investigator signature:

Organization: John Milner Associates, Inc Date: 4/3/2008

8. OTHER NOTES OR OBSERVATIONS:

CRS# S-03828

Resurveyed for US113 North/South Study, Delaware Department of Transportation, by John Milner Associates, Inc.

Demolished

9. STATE HISTORIC CONTEXT FRAMEWORK (check all appropriate boxes; refer to state management plan(s)):

a) Time period(s)

- Pre-European Contact
- Paleo-Indian
- Archaic
- Woodland I
- Woodland II

- 1600-1750∇ Contact Period (Native American)
- 1630-1730∇ Exploration and Frontier Settlement
- 1730-1770∇ Intensified and Durable Occupation
- 1770-1830∇ Early Industrialization
- 1830-1880∇ Industrialization and Early Urbanization
- 1880-1940∇ Urbanization and Early Suburbanization
- 1940-1960∇ Suburbanization and Early Ex-urbanization

b) Geographical zone

- Piedmont
- Upper Peninsula
- Lower Peninsula/Cypress Swamp
- Coastal
- Urban (City of Wilmington)

c) Historic period theme(s)

- | | |
|--|--|
| <input type="checkbox"/> Agriculture | <input type="checkbox"/> Transportation and Communication |
| <input type="checkbox"/> Forestry | <input type="checkbox"/> Settlement Patterns and Demographic Changes |
| <input type="checkbox"/> Trapping/Hunting | <input type="checkbox"/> Architecture, Engineering and Decorative Arts |
| <input type="checkbox"/> Mining/Quarrying | <input type="checkbox"/> Government |
| <input type="checkbox"/> Fishing/Oystering | <input type="checkbox"/> Religion |
| <input type="checkbox"/> Manufacturing | <input type="checkbox"/> Education |
| <input type="checkbox"/> Retailing/Wholesaling | <input type="checkbox"/> Community Organizations |
| <input type="checkbox"/> Finance | <input type="checkbox"/> Occupational Organizations |
| <input type="checkbox"/> Professional Services | <input type="checkbox"/> Major Families, Individuals and Events |

USE BLACK INK ONLY

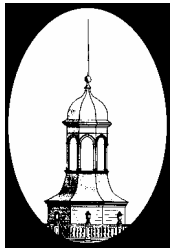

DELAWARE STATE HISTORIC PRESERVATION OFFICE
15 THE GREEN, DOVER, DE 19901

CULTURAL RESOURCE SURVEY
SURVEY UPDATE FORM

CRS # S-03890

1. HISTORIC NAME/FUNCTION: dwelling

2. ADDRESS/LOCATION: Milton-Ellendale Rd @ Sharon's Road

3. CURRENT CONDITION: excellent good fair poor demolished

4. INTEGRITY: Resided and new windows; east porch enclosed since 1983. West and North porches enclosed prior to 1983.

5. SETTING INTEGRITY: New trailer next door, large new housing development to the rear.

6. FORMS ADDED (give number of forms completed for each):

#:	Form:	List property types:
X	CRS 2 Main Building Form	
X	CRS 3 Secondary Building Form	
	CRS 4 Archaeological Site Form	
X	CRS 5 Structure (Building-Like) Form	
	CRS 6 Structure (Land Feature) Form	
	CRS 7 Object Form	
	CRS 8 Landscape Elements Form	
X	CRS 9 Map Form	N/A
	CRS 14 Potential District Form	

7. SURVEYOR INFORMATION:

Surveyor name: Kate Farnham

Principal Investigator name: Grace Ziesing

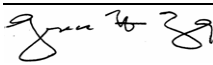
Principal Investigator signature: 

Organization: John Milner Associates Inc Date: 4/4/2008

8. OTHER NOTES OR OBSERVATIONS:

CRS# S-03890

Resurveyed for US113 North/South Study, Delaware Department of Transportation, by John Milner Associates, Inc.

Appears to be remains from a farm complex at this site, may be original house for this tract.

9. STATE HISTORIC CONTEXT FRAMEWORK (check all appropriate boxes; refer to state management plan(s)):

a) Time period(s)

- Pre-European Contact
- Paleo-Indian
- Archaic
- Woodland I
- Woodland II

- 1600-1750∇ Contact Period (Native American)
- 1630-1730∇ Exploration and Frontier Settlement
- 1730-1770∇ Intensified and Durable Occupation
- 1770-1830∇ Early Industrialization
- 1830-1880∇ Industrialization and Early Urbanization
- 1880-1940∇ Urbanization and Early Suburbanization
- 1940-1960∇ Suburbanization and Early Ex-urbanization

b) Geographical zone

- Piedmont
- Upper Peninsula
- Lower Peninsula/Cypress Swamp
- Coastal
- Urban (City of Wilmington)

c) Historic period theme(s)

- | | |
|---|---|
| <input checked="" type="checkbox"/> Agriculture | <input type="checkbox"/> Transportation and Communication |
| <input type="checkbox"/> Forestry | <input type="checkbox"/> Settlement Patterns and Demographic Changes |
| <input type="checkbox"/> Trapping/Hunting | <input checked="" type="checkbox"/> Architecture, Engineering and Decorative Arts |
| <input type="checkbox"/> Mining/Quarrying | <input type="checkbox"/> Government |
| <input type="checkbox"/> Fishing/Oystering | <input type="checkbox"/> Religion |
| <input type="checkbox"/> Manufacturing | <input type="checkbox"/> Education |
| <input type="checkbox"/> Retailing/Wholesaling | <input type="checkbox"/> Community Organizations |
| <input type="checkbox"/> Finance | <input type="checkbox"/> Occupational Organizations |
| <input type="checkbox"/> Professional Services | <input type="checkbox"/> Major Families, Individuals and Events |

USE BLACK INK ONLY

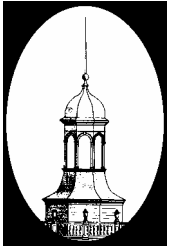

DELAWARE STATE HISTORIC PRESERVATION OFFICE
15 THE GREEN, DOVER, DE 19901

CULTURAL RESOURCE SURVEY
MAIN BUILDING FORM

CRS # S-03890.001

1. ADDRESS/LOCATION: Milton-Ellendale Rd @ Sharon's Road

2. FUNCTION(S): historic Agricultural Complex current Agricultural complex

3. YEAR BUILT: 1880 CIRCA?: ARCHITECT/BUILDER:

4. STYLE OR FLOOR PLAN: 3-bay I-house

5. INTEGRITY: original site moved

if moved, from where other location's CRS # year

list major alterations and additions with years (if known) year

- a. enclosed front porch, new siding, all windows and doors replaced recently
- b. eaves boxed with new cladding, side porches on rear all enclosed

6. CURRENT CONDITION: excellent good fair poor

7. DESCRIPTION: (Describe the resource as completely as possible. Use N/A for not applicable; leave no blanks.)

a. Overall shape: L-plan Stories: 2.5, with 1.5 story ell
Additions:

b Structural system (if known): wood frame

c. Foundation: materials: brick
basement: full partial not visible no basement

d. Exterior walls (original if visible& any subsequent coverings): vinyl siding

e. Roof: shape: cross gable, side gable
materials: asphalt
cornice: boxed
dormers:
chimney: location(s): brick, ext. gable (X3)

8. DESCRIPTION OF ELEVATIONS:

a.	Facade: Direction: N
1)	Bays 3 (1 st floor hidden by enclosed porch)
2)	Windows 3 (2 nd story)
	fenestration regular
	type double hung, 1/1 vinyl
	trim vinyl
	shutters

Facade (cont'd)	
3)	Door(s) 1
	location center of porch
	type wood and glass; 3 lights over 3 panels – mid 20 th century
	trim plain
4)	Porch(es) portico; shed-roofed porch, fully enclosed
b. Side: Direction: E	
1)	Bays 4
2)	Windows 3 (1 st story), 4 (second story), 2 (3 rd story)
	fenestration Regular
	type fixed, double hung 1/1 vinyl, all replaced including attic
	trim vinyl
	shutters
3)	Door(s) 1
	location inside porch, center
	type fiberglass
	trim
4)	Porch(es) portico; large shed-roof side porch, enclosed with glass and siding. Original siding (fishscale) extant inside porch
c. Side: Direction: W	
1)	Bays 4
2)	Windows 2 (front section), 2 (ell section), 2 (front section)
	fenestration regular
	type double hung, 1/1, all replaced vinyl including attic windows
	trim vinyl
	shutters
3)	Door(s) 0
	location
	type
	trim
4)	Porch(es) portico; enclosed shed-roof porch along rear ell, enclosed pre-1983
d. Rear: Direction: S	
1)	Bays 2
2)	Windows 1 (1 st story), 2 (2 nd story)
	fenestration regular
	type double hung, 1/1 vinyl
	trim vinyl
	shutters
3)	Door(s)
	location
	type
	trim
4)	Porch(es)

9.	INTERIOR:
10.	LANDSCAPING: triangular lot, gravel driveway connects street in back. Large maple in back yard beyond driveway. A few shrubs/ azaleas in front yard. Cluster of old outbuildings at SW rear corner w/ another old tree.
11.	OTHER COMMENTS:

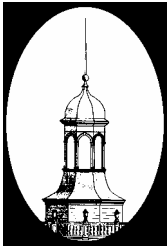

DELAWARE STATE HISTORIC PRESERVATION OFFICE
15 THE GREEN, DOVER, DE 19901

CULTURAL RESOURCE SURVEY
STRUCTURE (BUILDING-LIKE) FORM

CRS # S-03890.002

1. ADDRESS/LOCATION: Milton-Ellendale Rd @ Sharon's Road

2. FUNCTION: Corncrib IN USE?

3. YEAR BUILT: 1900 CIRCA?: ARCHITECT/BUILDER:

4. STYLE/PLAN: Gable-front, steep roof pitch

5. INTEGRITY: original site moved

if moved, from where original location's CRS # year

list major alterations and additions with dates (if known) year

a.

b.

6. CURRENT CONDITION: excellent good fair poor

7. DESCRIPTION (describe the structure as completely as possible):

a) Overall shape	rectangular
height	12
length	14
width	12

b) Structural system: frame

c) Foundation: not visible, very old cinder blocks

d) Exterior covering: wood siding (vertical)

7. DESCRIPTION (cont'd):

CRS #	S-03890.002
-------	-------------

e) Openings 1 door in east side, old unpainted 4-panel door ca. 19th century

f) Other features

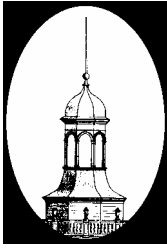

DELAWARE STATE HISTORIC PRESERVATION OFFICE
15 THE GREEN, DOVER, DE 19901

CULTURAL RESOURCE SURVEY
SECONDARY BUILDING FORM

CRS # S-03890.003

1. ADDRESS/LOCATION: Milton-Ellendale Rd @ Sharon's Road

2. FUNCTION(S): historic Privy current Not in use

3. YEAR BUILT: 1930 CIRCA?: ARCHITECT/BUILDER: _____

4. STYLE/FLOOR PLAN: One pen; double privy

5. INTEGRITY: original site moved
if moved, from where original location's CRS # year

list major alterations and additions with years (if known) year

a. interior wallboard; plastic toilet seats on holes

b. _____

6. CURRENT CONDITION: excellent good fair poor

7. DESCRIPTION:

a. Structural system wood frame

b. Number of stories 1

c. Wall coverings wood siding (vertical)

d. Foundation concrete block

e. Roof
structural system shed roof, exposed rafter ends
coverings metal
openings

8. DESCRIPTION OF ELEVATIONS:

a. Facade: direction: N

1) bays: 1

2) windows:

3) door(s): 1, wood, beadboard batten door

4) other:

- b. Side: direction: E
 - 1) bays:
 - 2) windows:
 - 3) door(s):
 - 4) other:

- c. Side: direction: W
 - 1) bays: 1
 - 2) windows: irregular fenestrations, fixed. plexiglass
 - 3) door(s):
 - 4) other:

- d. Rear: direction: S
 - 1) bays:
 - 2) windows:
 - 3) door(s):
 - 4) other:

9. INTERIOR (if accessible):

a) Floor plan

b) Partition/walls

c) Finishes

d) Furnishings/machinery

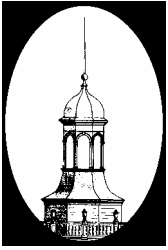

DELAWARE STATE HISTORIC PRESERVATION OFFICE
15 THE GREEN, DOVER, DE 19901

CULTURAL RESOURCE SURVEY
SECONDARY BUILDING FORM

CRS # S-03890.004

1. ADDRESS/LOCATION: Milton-Ellendale Rd @ Sharon's Road

2. FUNCTION(S): historic Agricultural shed current unknown

3. YEAR BUILT: 1950 CIRCA?: ARCHITECT/BUILDER: _____

4. STYLE/FLOOR PLAN: One pen

5. INTEGRITY: original site moved
if moved, from where original location's CRS # year

list major alterations and additions with years (if known) year
a. metal cladding all over shed
b.

6. CURRENT CONDITION: excellent good fair poor

7. DESCRIPTION:
a. Structural system wood-framed
b. Number of stories 1
c. Wall coverings metal cladding
d. Foundation concrete block
e. Roof
structural system gable front, exposed rafter ends
coverings metal
openings

8. DESCRIPTION OF ELEVATIONS:
a. Facade: direction: E
1) bays: 1
2) windows: 0
3) door(s): 1, center, fairly old wood batten door
4) other:

b. Side: direction: N

1) bays: 0

2) windows:

3) door(s):

4) other:

c. Side: direction: S

1) bays: 1

2) windows: 1, regular fenestration, casement, 4 lights, wood trim

3) door(s):

4) other:

d. Rear: direction: W

1) bays: 0

2) windows:

3) door(s):

4) other:

9. INTERIOR (if accessible):

a) Floor plan

b) Partition/walls

c) Finishes

d) Furnishings/machinery

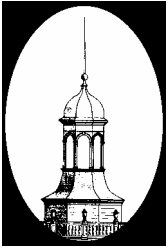

DELAWARE STATE HISTORIC PRESERVATION OFFICE
15 THE GREEN, DOVER, DE 19901

CULTURAL RESOURCE SURVEY
SECONDARY BUILDING FORM

CRS # S-03890.005

1. ADDRESS/LOCATION: Milton-Ellendale Rd @ Sharon's Road

2. FUNCTION(S): historic Milk house current Domestic/ unknown

3. YEAR BUILT: 1920 CIRCA?: ARCHITECT/BUILDER: _____

4. STYLE/FLOOR PLAN: One pen

5. INTEGRITY: original site moved
if moved, from where original location's CRS # year

list major alterations and additions with years (if known) year
a. windows boarded up
b.

6. CURRENT CONDITION: excellent good fair poor

7. DESCRIPTION:

- a. Structural system concrete block
- b. Number of stories 1
- c. Wall coverings wood siding (vertical)
- d. Foundation concrete block
- e. Roof
structural system gable front, exposed rafter ends
coverings composition
openings

8. DESCRIPTION OF ELEVATIONS:

- a. Facade: direction: N
 - 1) bays: 1
 - 2) windows:
 - 3) door(s): 1, wood batten door
 - 4) other: stoop porch, bricks laid in ground

b. Side: direction: W

- 1) bays: 1
- 2) windows: 1, casement, boarded up (probably 4-light)
- 3) door(s):
- 4) other:

c. Side: direction: E

- 1) bays: 1
- 2) windows: 1, casement, boarded up (probably 4-light)
- 3) door(s):
- 4) other:

d. Rear: direction: S

- 1) bays: 1
- 2) windows: 1, 4 light, partially boarded up; brick window lintel
- 3) door(s):
- 4) other:

9. INTERIOR (if accessible):

a) Floor plan

b) Partition/walls

c) Finishes

d) Furnishings/machinery

CULTURAL RESOURCE SURVEY
MAP FORM

CRS # S-03890

1. ADDRESS/LOCATION: Milton-Ellendale Rd @ Sharon's Road

2. NOT FOR PUBLICATION reason: _____

3. LOCATION MAP:

Indicate position of resource in relation to geographical landmarks such as streams and crossroads.

(attach section of USGS quad map with location marked or draw location map)

INDICATE NORTH ON SKETCH

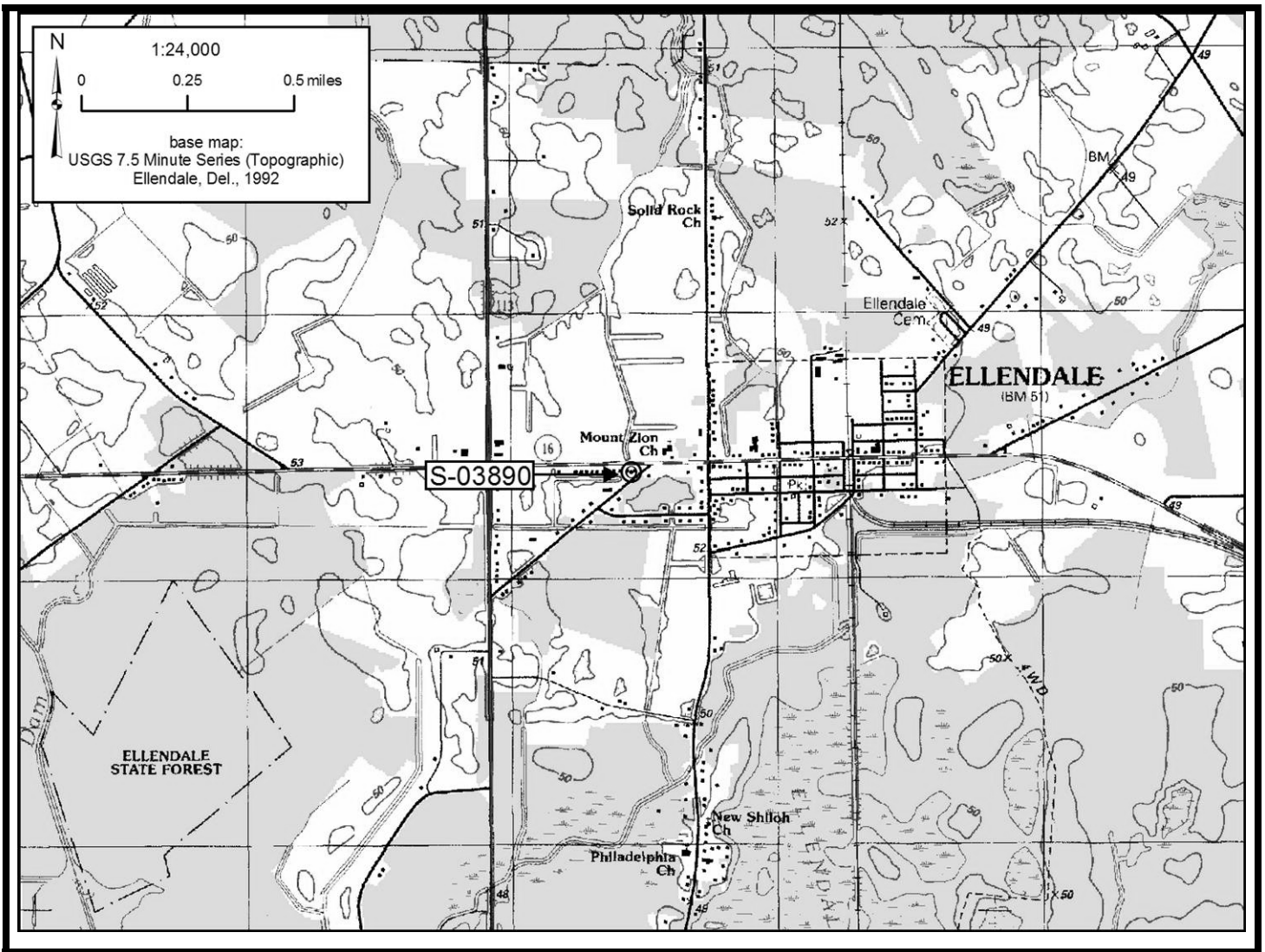

INDICATE NORTH ON PLAN

S-03890

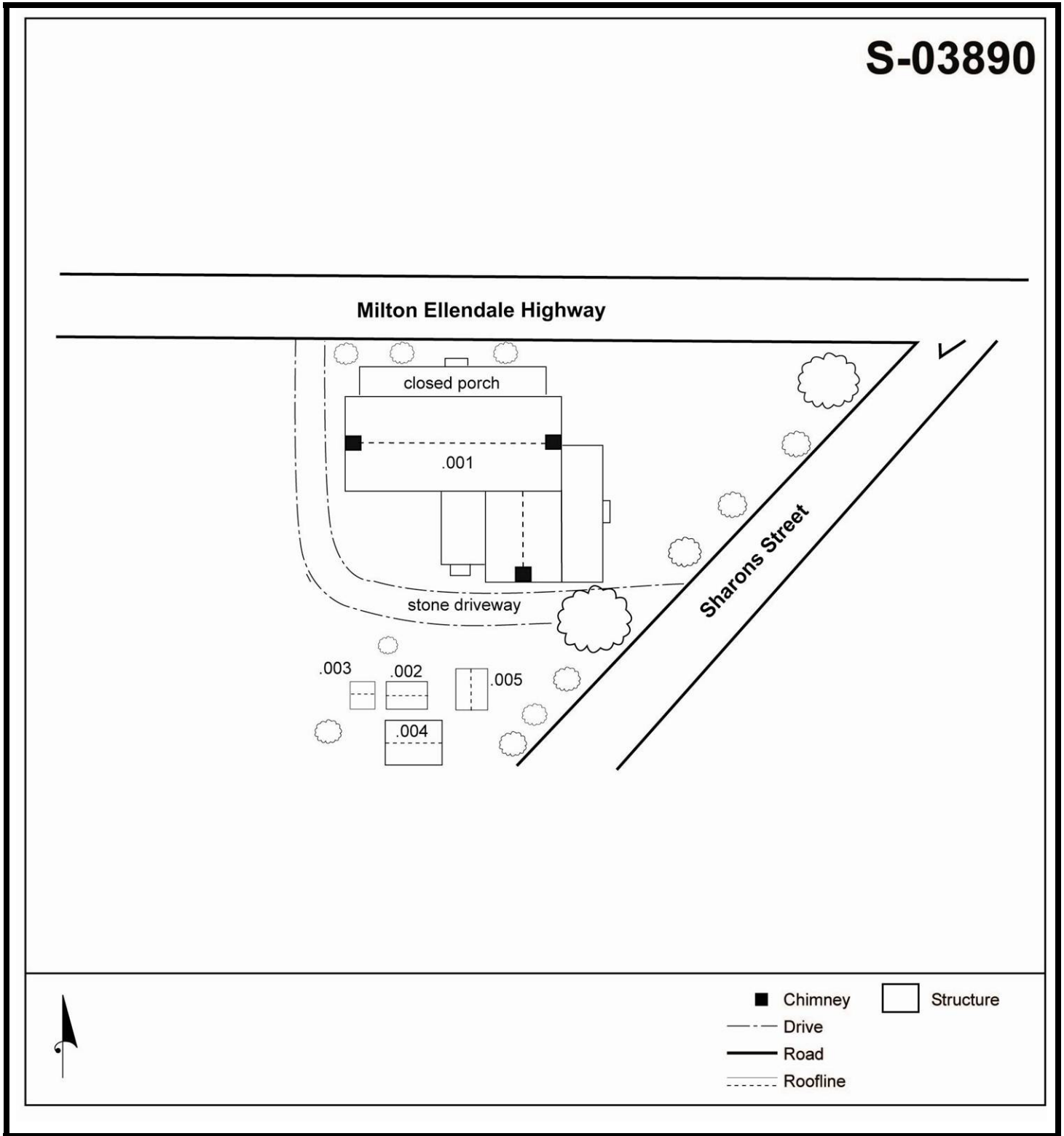

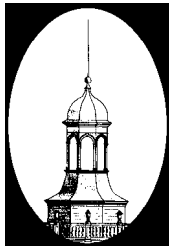

CULTURAL RESOURCE SURVEY
SURVEY UPDATE FORM

CRS # S-03891

1. HISTORIC NAME/FUNCTION: Dwelling

2. ADDRESS/LOCATION: Sharons Road

3. CURRENT CONDITION: excellent good fair poor demolished

4. INTEGRITY:

5. SETTING INTEGRITY:

6. FORMS ADDED (give number of forms completed for each):

#:	Form:	List property types:
	CRS 2 Main Building Form	
	CRS 3 Secondary Building Form	
	CRS 4 Archaeological Site Form	
	CRS 5 Structure (Building-Like) Form	
	CRS 6 Structure (Land Feature) Form	
	CRS 7 Object Form	
	CRS 8 Landscape Elements Form	
	CRS 9 Map Form	N/A
	CRS 14 Potential District Form	

7. SURVEYOR INFORMATION:

Surveyor name: Kate Farnham

Principal Investigator name: Grace Ziesing

Principal Investigator signature:

Organization: John Milner Associates, Inc Date: 4/3/2008

8. OTHER NOTES OR OBSERVATIONS:

CRS# S-03891

Resurveyed for US113 North/South Study, Delaware Department of Transportation, by John Milner Associates, Inc.

Demolished

9. STATE HISTORIC CONTEXT FRAMEWORK (check all appropriate boxes; refer to state management plan(s)):

a) Time period(s)

- Pre-European Contact
- Paleo-Indian
- Archaic
- Woodland I
- Woodland II

- 1600-1750∇ Contact Period (Native American)
- 1630-1730∇ Exploration and Frontier Settlement
- 1730-1770∇ Intensified and Durable Occupation
- 1770-1830∇ Early Industrialization
- 1830-1880∇ Industrialization and Early Urbanization
- 1880-1940∇ Urbanization and Early Suburbanization
- 1940-1960∇ Suburbanization and Early Ex-urbanization

b) Geographical zone

- Piedmont
- Upper Peninsula
- Lower Peninsula/Cypress Swamp
- Coastal
- Urban (City of Wilmington)

c) Historic period theme(s)

- | | |
|--|--|
| <input type="checkbox"/> Agriculture | <input type="checkbox"/> Transportation and Communication |
| <input type="checkbox"/> Forestry | <input type="checkbox"/> Settlement Patterns and Demographic Changes |
| <input type="checkbox"/> Trapping/Hunting | <input type="checkbox"/> Architecture, Engineering and Decorative Arts |
| <input type="checkbox"/> Mining/Quarrying | <input type="checkbox"/> Government |
| <input type="checkbox"/> Fishing/Oystering | <input type="checkbox"/> Religion |
| <input type="checkbox"/> Manufacturing | <input type="checkbox"/> Education |
| <input type="checkbox"/> Retailing/Wholesaling | <input type="checkbox"/> Community Organizations |
| <input type="checkbox"/> Finance | <input type="checkbox"/> Occupational Organizations |
| <input type="checkbox"/> Professional Services | <input type="checkbox"/> Major Families, Individuals and Events |

USE BLACK INK ONLY