

CULTURAL RESOURCE SURVEY
SURVEY UPDATE FORM

CRS # S-03188

1. HISTORIC NAME/FUNCTION: Dwelling

2. ADDRESS/LOCATION: McColley's Chapel Road

3. CURRENT CONDITION: excellent good fair poor demolished

4. INTEGRITY:

5. SETTING INTEGRITY:

6. FORMS ADDED (give number of forms completed for each):

#:	Form:	List property types:
	CRS 2 Main Building Form	
	CRS 3 Secondary Building Form	
	CRS 4 Archaeological Site Form	
	CRS 5 Structure (Building-Like) Form	
	CRS 6 Structure (Land Feature) Form	
	CRS 7 Object Form	
	CRS 8 Landscape Elements Form	
	CRS 9 Map Form	N/A
	CRS 14 Potential District Form	

7. SURVEYOR INFORMATION:

Surveyor name: Kate Farnham

Principal Investigator name: Grace Ziesing

Principal Investigator signature:

Organization: John Milner Associates, Inc Date: 4/3/2008

8. OTHER NOTES OR OBSERVATIONS:

CRS# S-03188

Resurveyed for US113 North/South Study, Delaware Department of Transportation, by John Milner Associates, Inc.

Demolished

9. STATE HISTORIC CONTEXT FRAMEWORK (check all appropriate boxes; refer to state management plan(s)):

a) Time period(s)

- Pre-European Contact
- Paleo-Indian
- Archaic
- Woodland I
- Woodland II

- 1600-1750∇ Contact Period (Native American)
- 1630-1730∇ Exploration and Frontier Settlement
- 1730-1770∇ Intensified and Durable Occupation
- 1770-1830∇ Early Industrialization
- 1830-1880∇ Industrialization and Early Urbanization
- 1880-1940∇ Urbanization and Early Suburbanization
- 1940-1960∇ Suburbanization and Early Ex-urbanization

b) Geographical zone

- Piedmont
- Upper Peninsula
- Lower Peninsula/Cypress Swamp
- Coastal
- Urban (City of Wilmington)

c) Historic period theme(s)

- | | |
|------------------------------------------------|------------------------------------------------------------------------|
| <input type="checkbox"/> Agriculture | <input type="checkbox"/> Transportation and Communication |
| <input type="checkbox"/> Forestry | <input type="checkbox"/> Settlement Patterns and Demographic Changes |
| <input type="checkbox"/> Trapping/Hunting | <input type="checkbox"/> Architecture, Engineering and Decorative Arts |
| <input type="checkbox"/> Mining/Quarrying | <input type="checkbox"/> Government |
| <input type="checkbox"/> Fishing/Oystering | <input type="checkbox"/> Religion |
| <input type="checkbox"/> Manufacturing | <input type="checkbox"/> Education |
| <input type="checkbox"/> Retailing/Wholesaling | <input type="checkbox"/> Community Organizations |
| <input type="checkbox"/> Finance | <input type="checkbox"/> Occupational Organizations |
| <input type="checkbox"/> Professional Services | <input type="checkbox"/> Major Families, Individuals and Events |

USE BLACK INK ONLY

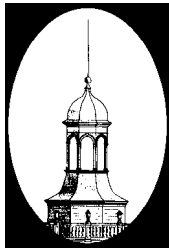

CULTURAL RESOURCE SURVEY
SURVEY UPDATE FORM

CRS # S-03221

1. HISTORIC NAME/FUNCTION: Dwelling

2. ADDRESS/LOCATION: 18912 Redden Road

3. CURRENT CONDITION: excellent good fair poor demolished

4. INTEGRITY: resided in vinyl; replacement windows and door; 1-story gabled addition on southwest end

5. SETTING INTEGRITY:

6. FORMS ADDED (give number of forms completed for each):

#:	Form:	List property types:
X	CRS 2 Main Building Form	
X	CRS 3 Secondary Building Form	
	CRS 4 Archaeological Site Form	
	CRS 5 Structure (Building-Like) Form	
	CRS 6 Structure (Land Feature) Form	
	CRS 7 Object Form	
	CRS 8 Landscape Elements Form	
X	CRS 9 Map Form	
	CRS 14 Potential District Form	

7. SURVEYOR INFORMATION:

Surveyor name: Courtney L. Clark

Principal Investigator name: Grace H. Ziesing

Principal Investigator signature:

Organization: John Milner Associates, Inc. Date: 09/2005

8. OTHER NOTES OR OBSERVATIONS:

CRS# S-03221

Resurveyed for the U.S. 113 North/South Study by JMA on behalf of the Delaware Department of Transportation.

9. STATE HISTORIC CONTEXT FRAMEWORK (check all appropriate boxes; refer to state management plan(s)):

a) Time period(s)

- Pre-European Contact
- Paleo-Indian
- Archaic
- Woodland I
- Woodland II

- 1600-1750∇ Contact Period (Native American)
- 1630-1730∇ Exploration and Frontier Settlement
- 1730-1770∇ Intensified and Durable Occupation
- 1770-1830∇ Early Industrialization
- 1830-1880∇ Industrialization and Early Urbanization
- 1880-1940∇ Urbanization and Early Suburbanization
- 1940-1960∇ Suburbanization and Early Ex-urbanization

b) Geographical zone

- Piedmont
- Upper Peninsula
- Lower Peninsula/Cypress Swamp
- Coastal
- Urban (City of Wilmington)

c) Historic period theme(s)

- | | |
|------------------------------------------------|-----------------------------------------------------------------------------------|
| <input type="checkbox"/> Agriculture | <input type="checkbox"/> Transportation and Communication |
| <input type="checkbox"/> Forestry | <input type="checkbox"/> Settlement Patterns and Demographic Changes |
| <input type="checkbox"/> Trapping/Hunting | <input checked="" type="checkbox"/> Architecture, Engineering and Decorative Arts |
| <input type="checkbox"/> Mining/Quarrying | <input type="checkbox"/> Government |
| <input type="checkbox"/> Fishing/Oystering | <input type="checkbox"/> Religion |
| <input type="checkbox"/> Manufacturing | <input type="checkbox"/> Education |
| <input type="checkbox"/> Retailing/Wholesaling | <input type="checkbox"/> Community Organizations |
| <input type="checkbox"/> Finance | <input type="checkbox"/> Occupational Organizations |
| <input type="checkbox"/> Professional Services | <input type="checkbox"/> Major Families, Individuals and Events |

USE BLACK INK ONLY

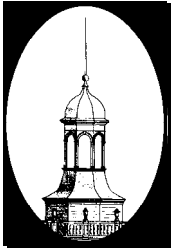

DELAWARE STATE HISTORIC PRESERVATION OFFICE
15 THE GREEN, DOVER, DE 19901

CULTURAL RESOURCE SURVEY
MAIN BUILDING FORM

CRS # S-03221.001

1. ADDRESS/LOCATION: 18912 Redden Road

2. FUNCTION(S): current: domestic historic: domestic

3. YEAR BUILT: 1945 CIRCA?: X ARCHITECT/BUILDER:

4. STYLE OR FLOOR PLAN: vernacular World War II-era cottage

5. INTEGRITY: original site X moved

if moved, from where other location's CRS # year

list major alterations and additions with years (if known) year

a. resided in vinyl; replacement windows

b. 1-story gabled addition on southwest end

6. CURRENT CONDITION: excellent good X fair poor

7. DESCRIPTION: (Describe the resource as completely as possible. Use N/A for not applicable; leave no blanks.)

a. Overall shape: rectangle Stories: 1
Additions: 1-story gabled addition on southwest end

b. Structural system (if known): wood-framed

c. Foundation: materials: concrete block
basement: full partial not visible no basement

d. Exterior walls (original if visible& any subsequent coverings): vinyl siding

e. Roof: shape: side gable
materials: composition shingle
cornice:
dormers:
chimney: location(s): concrete-block, center chimney

8. DESCRIPTION OF ELEVATIONS:

a. Facade: Direction: northwest
1) Bays: 4
2) Windows: 3, first story
Fenestration: irregular
Type: 1/1 double-hung sash
Trim: vinyl
Shutters: vinyl, non-functional

Facade (cont'd)	
3)	Door(s): 1 Location: center Type: wood-and-glass Trim: plain
4)	Porch(es): gabled portico; supported by wood posts on concrete deck
b. Side: Direction: northeast	
1)	Bays: 3
2)	Windows: 2 Fenestration: irregular Type: 1/1 double-hung sash Trim: vinyl Shutters:
3)	Door(s): 1 Location: center Type: wood-and-glass Trim: plain
4)	Porch(es): gabled portico; supported by wood posts on concrete deck
c. Side: Direction: southwest	
1)	Bays: [obscured by 1-story gabled addition]
2)	Windows: Fenestration: Type: Trim: Shutters:
3)	Door(s): Location: center Type: other Trim: plain
4)	Porch(es):
d. Rear: Direction: southeast	
1)	Bays: 3
2)	Windows: 3 Fenestration: irregular Type: 1/1 double-hung sash Trim: vinyl Shutters:
3)	Door(s): none Location: Type: Trim:
4)	Porch(es):

9.	INTERIOR:
----	------------------

10.	LANDSCAPING: dwelling faces Redden Road; paved driveways to southwest and northeast sides of house; mature trees and shrubs shade front and side lawns; agricultural fields to southwest of property, residences to northeast
-----	--------------------------------------------------------------------------------------------------------------------------------------------------------------------------------------------------------------------------------------

11.	OTHER COMMENTS:
-----	------------------------

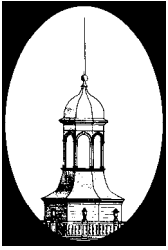

DELAWARE STATE HISTORIC PRESERVATION OFFICE
15 THE GREEN, DOVER, DE 19901

CULTURAL RESOURCE SURVEY
SECONDARY BUILDING FORM

CRS # S-03221.002

1. ADDRESS/LOCATION: 18912 Redden Road

2. FUNCTION(S): historic garage current garage

3. YEAR BUILT: 1945 CIRCA?: ARCHITECT/BUILDER: _____

4. STYLE/FLOOR PLAN: _____

5. INTEGRITY: original site moved
if moved, from where original location's CRS # year

list major alterations and additions with years (if known) year
a. garage doors replaced
b.

6. CURRENT CONDITION: excellent good fair poor

7. DESCRIPTION:
a. Structural system wood-framed
b. Number of stories 1
c. Wall coverings asbestos shingles
d. Foundation concrete block
e. Roof gable front
structural system
coverings composition shingles
openings

8. DESCRIPTION OF ELEVATIONS:
a. Facade: direction: northwest
1) bays: 2
2) windows: none
3) door(s): 2, side-by-side; 1 wood-and-glass; 1 aluminum
4) other:

- b. **Side: direction:** southwest
 - 1) **bays:** 1
 - 2) **windows:** 1, fixed, with wood trim
 - 3) **door(s):** none
 - 4) **other:**

- c. **Side: direction:** northeast
 - 1) **bays:** 1
 - 2) **windows:** 1, fixed, covered by plywood
 - 3) **door(s):** none
 - 4) **other:**

- d. **Rear: direction:** southeast
 - 1) **bays:** 1
 - 2) **windows:** none
 - 3) **door(s):** 1, center wood door
 - 4) **other:**

9. **INTERIOR (if accessible):**

a) **Floor plan**

b) **Partition/walls**

c) **Finishes**

d) **Furnishings/machinery**

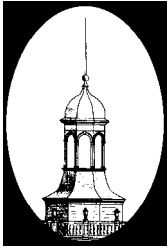

DELAWARE STATE HISTORIC PRESERVATION OFFICE
15 THE GREEN, DOVER, DE 19901

CULTURAL RESOURCE SURVEY
MAP FORM

CRS # S-03221

1. ADDRESS/LOCATION: 18912 Redden Road

2. NOT FOR PUBLICATION reason: _____

3. LOCATION MAP:

Indicate position of resource in relation to geographical landmarks such as streams and crossroads.

(attach section of USGS quad map with location marked or draw location map)

INDICATE NORTH ON SKETCH

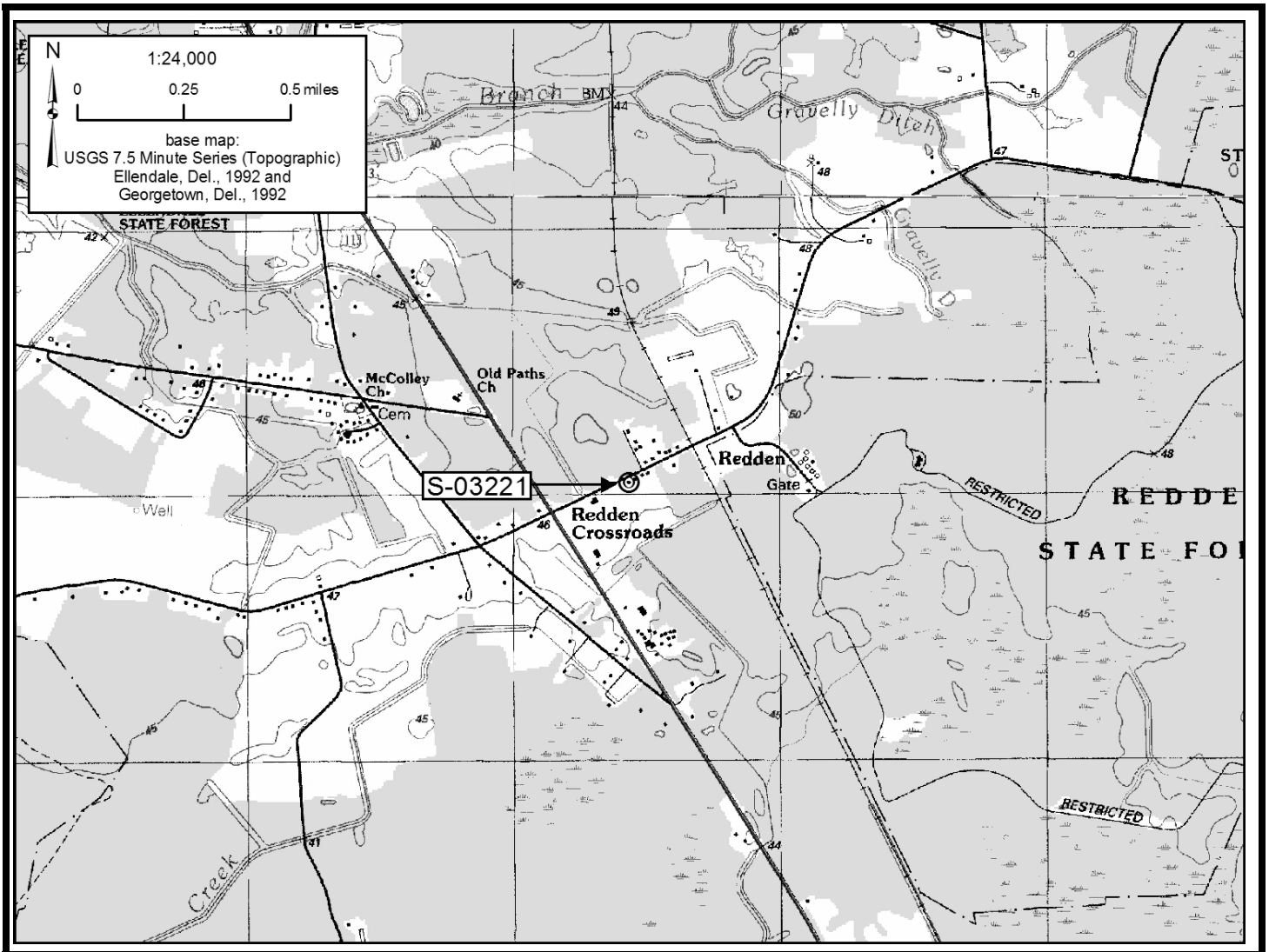

4. SITE PLAN:

CRS # S-03221

INDICATE NORTH ON PLAN

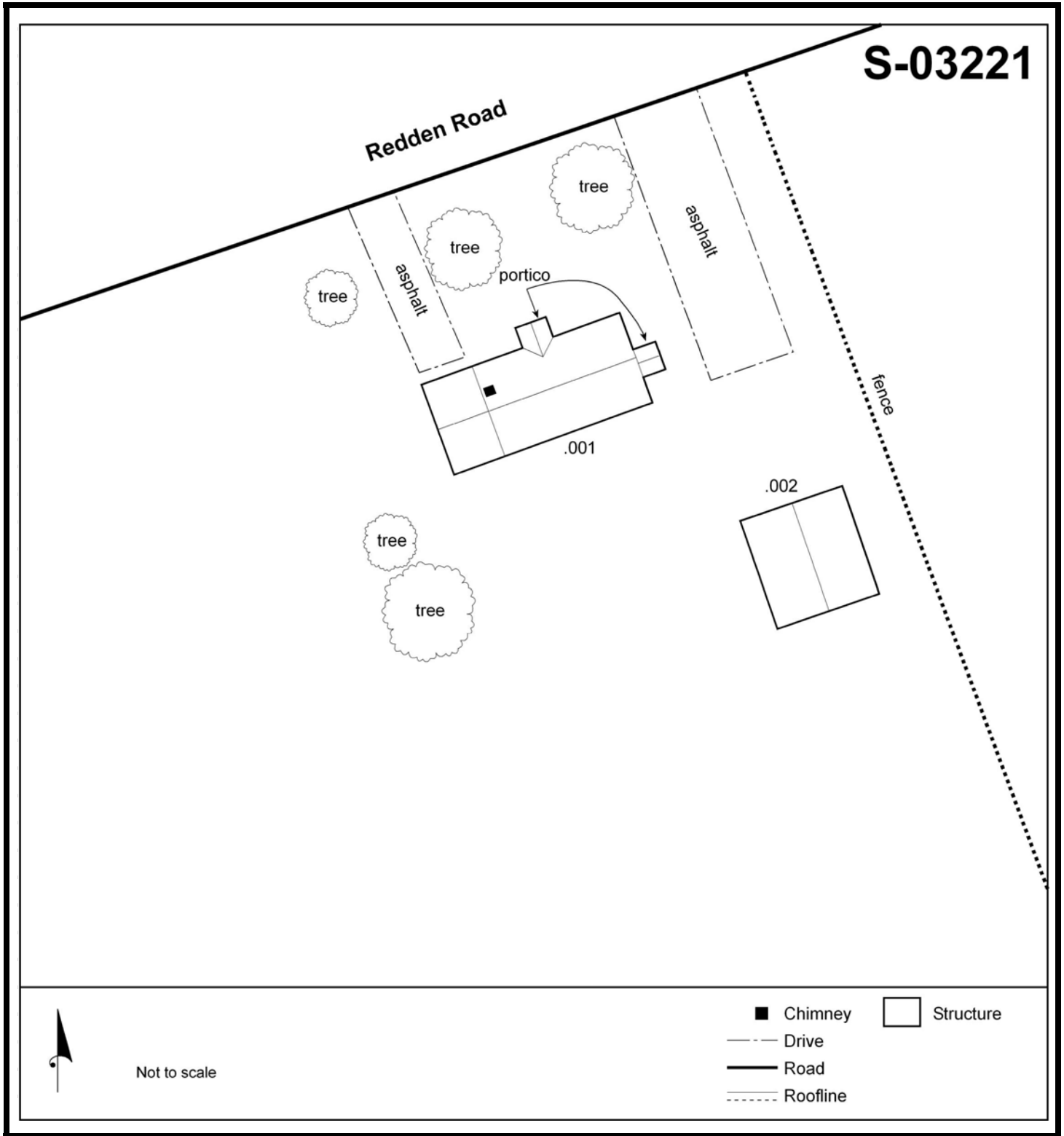

USE BLACK INK ONLY

CRS-9

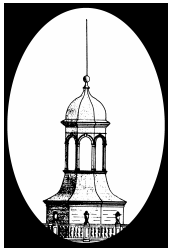

CULTURAL RESOURCE SURVEY
SURVEY UPDATE FORM

CRS # S-03235

1. HISTORIC NAME/FUNCTION: Dwelling/Agricultural Property

2. ADDRESS/LOCATION: Dupont Highway

3. CURRENT CONDITION: excellent good fair poor demolished

4. INTEGRITY: moved

5. SETTING INTEGRITY:

6. FORMS ADDED (give number of forms completed for each):

#:	Form:	List property types:
X	CRS 2 Main Building Form	
X	CRS 3 Secondary Building Form	
	CRS 4 Archaeological Site Form	
X	CRS 5 Structure (Building-Like) Form	
	CRS 6 Structure (Land Feature) Form	
	CRS 7 Object Form	
	CRS 8 Landscape Elements Form	
X	CRS 9 Map Form	
	CRS 14 Potential District Form	

7. SURVEYOR INFORMATION:

Surveyor name: Courtney Clark

Principal Investigator name: Grace H. Ziesing

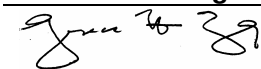
Principal Investigator signature: 

Organization: John Milner Associates Inc. Date: 07/26/2007

8. OTHER NOTES OR OBSERVATIONS:

CRS# S-03235

9. STATE HISTORIC CONTEXT FRAMEWORK (check all appropriate boxes; refer to state management plan(s)):

- a) Time period(s)
- Pre-European Contact
 - Paleo-Indian
 - Archaic
 - Woodland I
 - Woodland II
- 1600-1750- Contact Period (Native American)
1630-1730- Exploration and Frontier Settlement
1730-1770- Intensified and Durable Occupation
1770-1830- Early Industrialization
1830-1880- Industrialization and Early Urbanization
X 1880-1940- Urbanization and Early Suburbanization
1940-1960- Suburbanization and Early Ex-urbanization

- b) Geographical zone
- Piedmont
 - Upper Peninsula
 - X Lower Peninsula/Cypress Swamp
 - Coastal
 - Urban (City of Wilmington)

c) Historic period theme(s)

- | | | |
|-----------------------|---|-----------------------------------------------|
| Agriculture | | Transportation and Communication |
| Forestry | | Settlement Patterns and Demographic Changes |
| Trapping/Hunting | X | Architecture, Engineering and Decorative Arts |
| Mining/Quarrying | | Government |
| Fishing/Oystering | | Religion |
| Manufacturing | | Education |
| Retailing/Wholesaling | | Community Organizations |
| Finance | | Occupational Organizations |
| Professional Services | | Major Families, Individuals and Events |

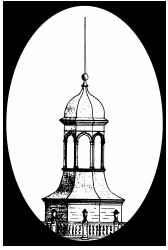

DELAWARE STATE HISTORIC PRESERVATION OFFICE
15 THE GREEN, DOVER, DE 19901

CULTURAL RESOURCE SURVEY
MAIN BUILDING FORM

CRS # S-03235.001

1. ADDRESS/LOCATION: Dupont Highway
2. FUNCTION(S): historic current
3. YEAR BUILT: 1895 CIRCA?: Y ARCHITECT/BUILDER:
4. STYLE OR FLOOR PLAN: Vernacular, central hall
5. INTEGRITY: original site moved X
- if moved, from where other location's CRS # year

list major alterations and additions with years (if known) year

a. resided in vinyl, replacement windows and doors, 1-story shed-roof addition on rear, 1 room, 1-story gabled addition attached to corner

b.

6. CURRENT CONDITION: excellent good X fair poor

7. DESCRIPTION: (Describe the resource as completely as possible. Use N/A for not applicable; leave no blanks.)

- a. Overall shape: rectangle Stories: 2.5
Additions:
- b. Structural system (if known): wood-frame
- c. Foundation: materials: concrete block
basement: full partial not visible no basement
- d. Exterior walls (original if visible& any subsequent coverings): Vinyl Siding
- e. Roof: shape: Side Gable
materials: Asphalt
cornice:
dormers:
chimney: location(s): other: exterior/rear, concrete block

8. DESCRIPTION OF ELEVATIONS:

- a. Facade: Direction: southwest
- 1) Bays: 5
- 2) Windows: 4, 4
Fenestration: regular
Type: double hung, 1/1
Trim: vinyl
Shutters: vinyl, non-functional

Facade (cont'd)

- 3) **Door(s):** 1
Location: center
Type: other
Trim: plain
- 4) **Porch(es):**

b. Side: Direction: southeast

- 1) **Bays:**
- 2) **Windows:** , 2
Fenestration: regular
Type: fixed
Trim: wood
Shutters:
- 3) **Door(s):**
Location:
Type:
Trim:
- 4) **Porch(es):**

c. Side: Direction: northwest

- 1) **Bays:**
- 2) **Windows:** 1, 0, 1
Fenestration: irregular
Type: double hung, 1/1
Trim: vinyl
Shutters: (vinyl,non-functional)
- 3) **Door(s):**
Location:
Type:
Trim:
- 4) **Porch(es):**

d. Rear: Direction: northeast

- 1) **Bays:**
- 2) **Windows:** 1, 1
Fenestration: irregular
Type: double hung, 1/1
Trim: vinyl
Shutters:
- 3) **Door(s):** 1
Location: other: within addition
Type:
Trim: plain
- 4) **Porch(es):**

9. INTERIOR:

10. LANDSCAPING: faces Rt. 113, driveway circles dwelling, plantings across front of house

11. OTHER COMMENTS:

USE BLACK INK ONLY

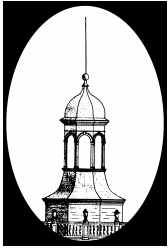

DELAWARE STATE HISTORIC PRESERVATION OFFICE
15 THE GREEN, DOVER, DE 19901

CULTURAL RESOURCE SURVEY
MAP FORM

CRS # S-03235

1. ADDRESS/LOCATION: Dupont Highway
2. NOT FOR PUBLICATION reason: _____
3. LOCATION MAP:

Indicate position of resource in relation to geographical landmarks such as streams and crossroads.

(attach section of USGS quad map with location marked or draw location map)

INDICATE NORTH ON SKETCH

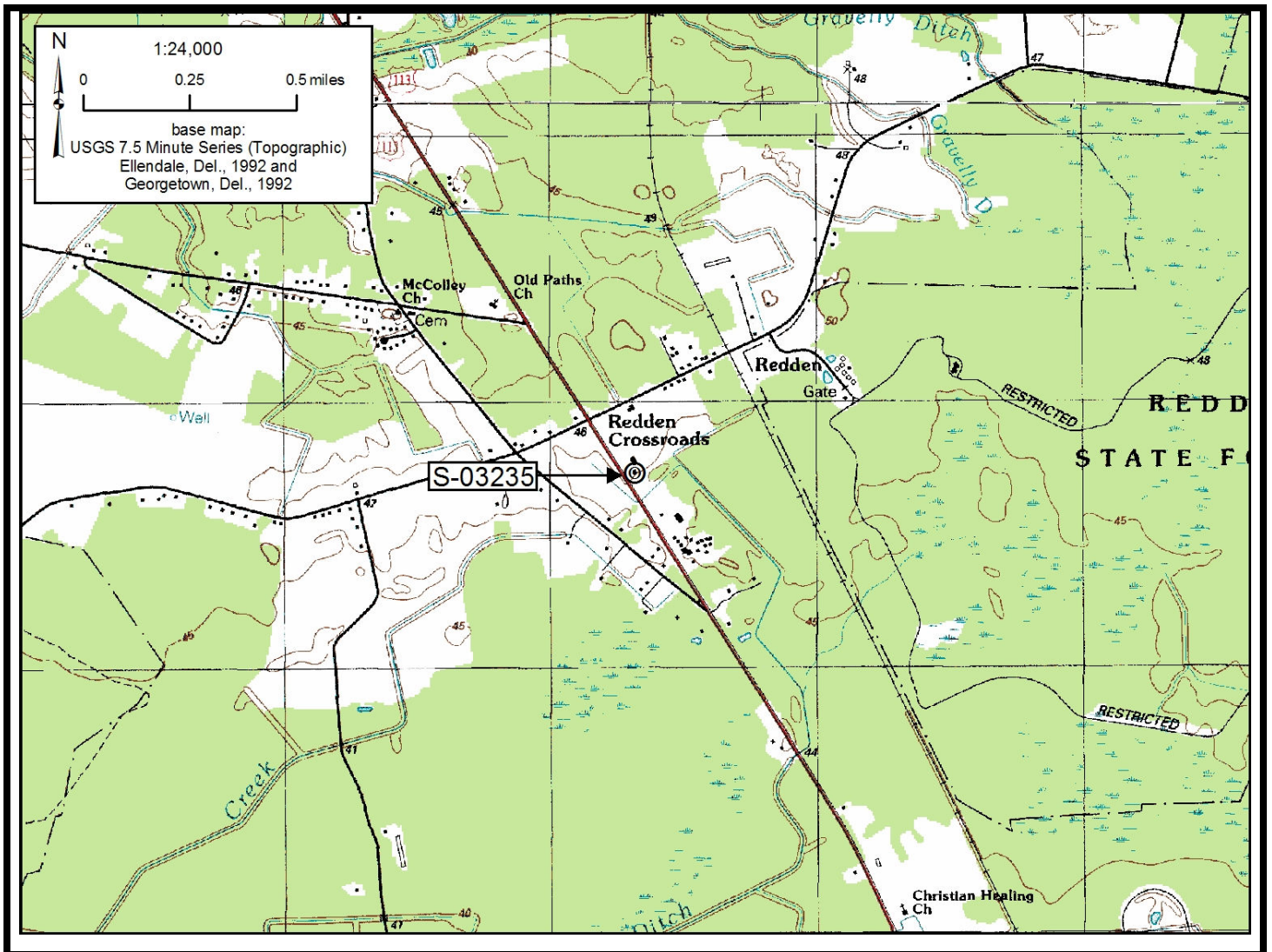

4. SITE PLAN:

CRS # S-03235

INDICATE NORTH ON PLAN

S-03235

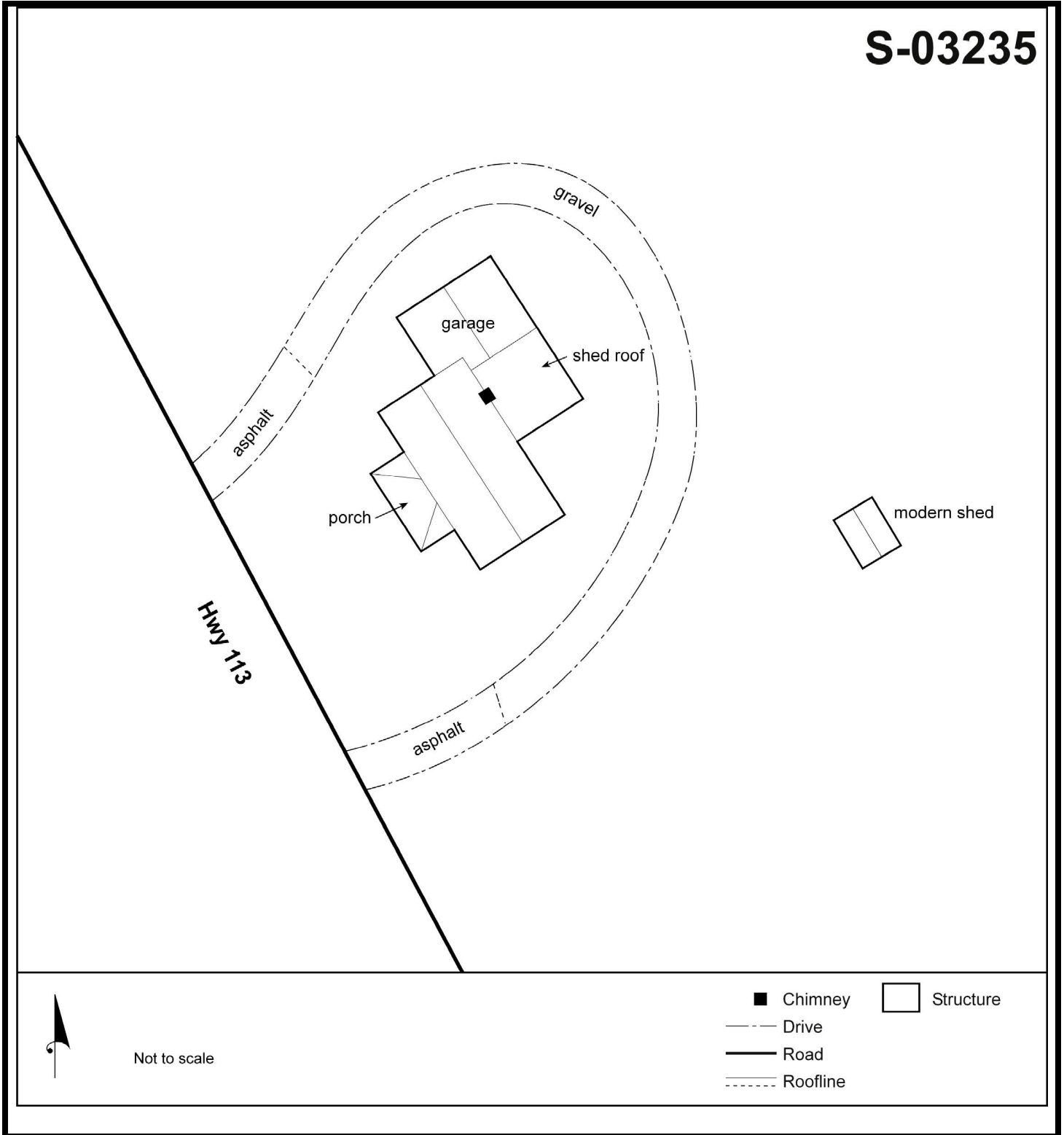

USE BLACK INK ONLY

CRS-9