

TYPE A

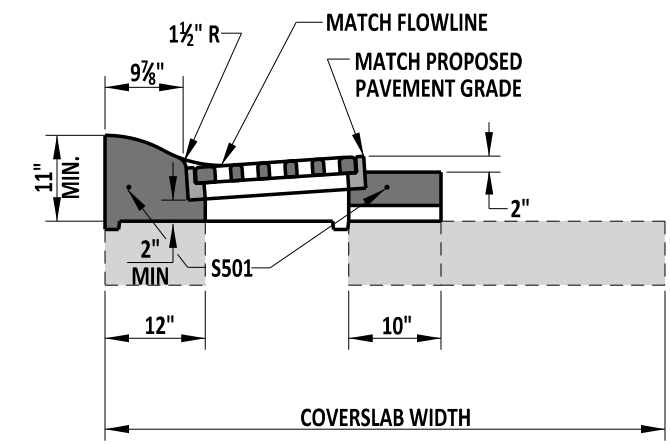

TYPE D

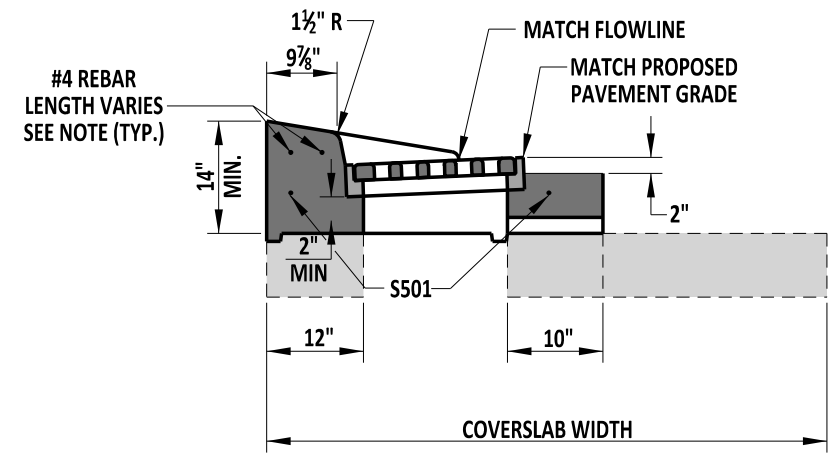

TYPE E

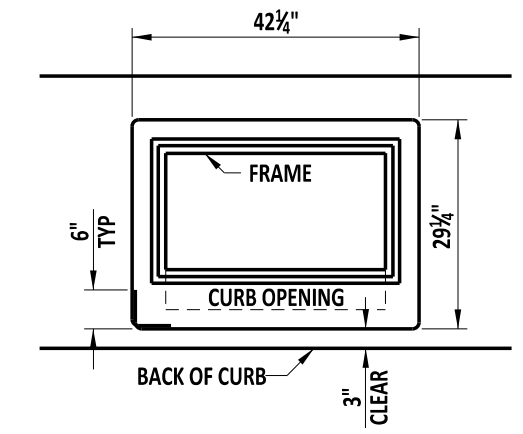

S501 BENDING DIAGRAM
#5 REBAR TO BE CONTINUOUS OR WITH 12" OVERLAP BETWEEN BARS.

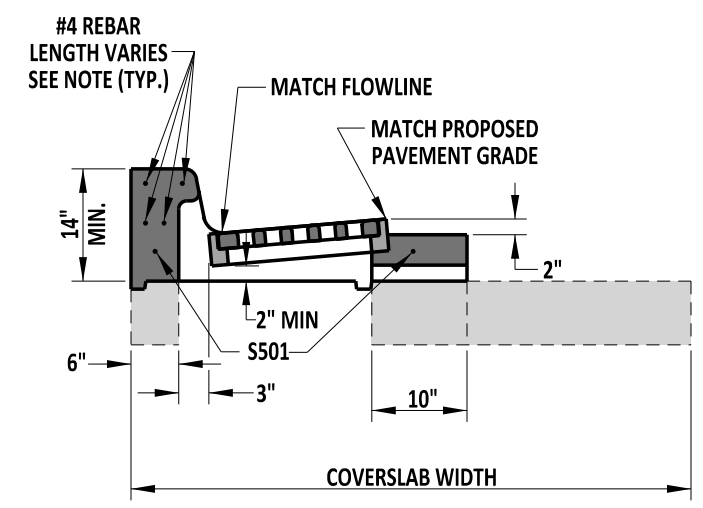

TYPE B

SEE CURB OPENING DETAIL ON THIS SHEET

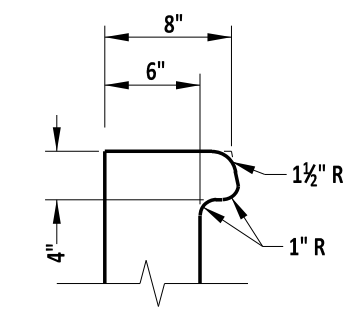

CURB OPENING DETAIL

INLET TOP UNIT APPLICATIONS	
TOP UNIT	CURB
TYPE A	USE IN NON CURBED
TYPE B	INTEGRAL PCC CURB & GUTTER, TYPE 1-8 & 3-8, PCC CURB TYPE 1-8
TYPE C	INTEGRAL PCC CURB & GUTTER, TYPES 1-6, 3-6, 1-4, 3-4, 1-2 AND 3-2 AND PCC CURB TYPE 1-6, 1-4, AND 1-2.
TYPE D	INTEGRAL PCC CURB & GUTTER, TYPE 2
TYPE E	PCC CURB TYPE 2

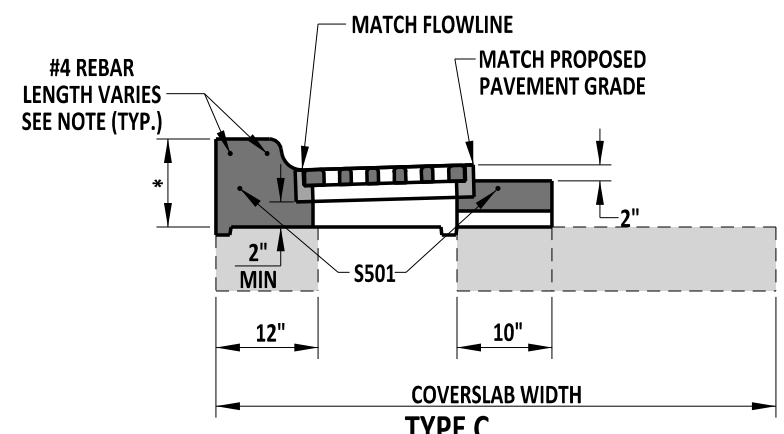

TYPE C

* - THIS DIMENSION VARIES BASED ON THE HEIGHT OF THE CURB AND GUTTER OR CURB USED:
 - INTEGRAL PCC CURB AND GUTTER, TYPES 1-6 AND 3-6 & CURB, TYPE 1-6 - 12" MIN.
 - INTEGRAL PCC CURB AND GUTTER, TYPES 1-4 AND 3-4 & CURB, TYPE 1-4 - 10" MIN.
 - INTEGRAL PCC CURB AND GUTTER, TYPES 1-2 AND 3-2 & CURB, TYPE 1-2 - 8" MIN.

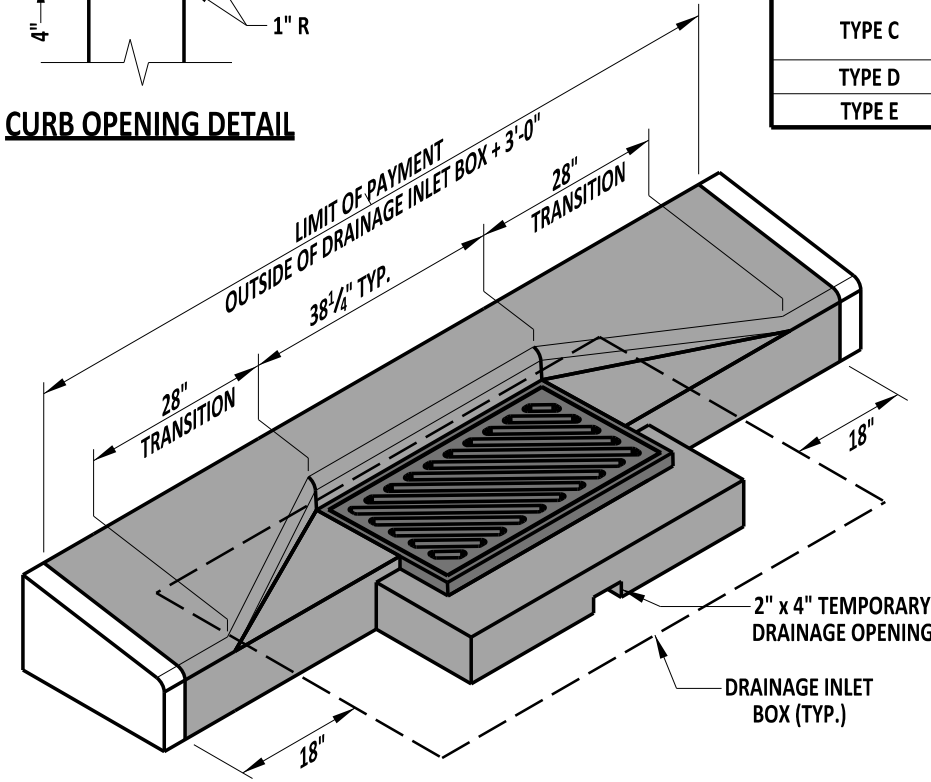

ISOMETRIC VIEW
TYPE E UNIT SHOWN

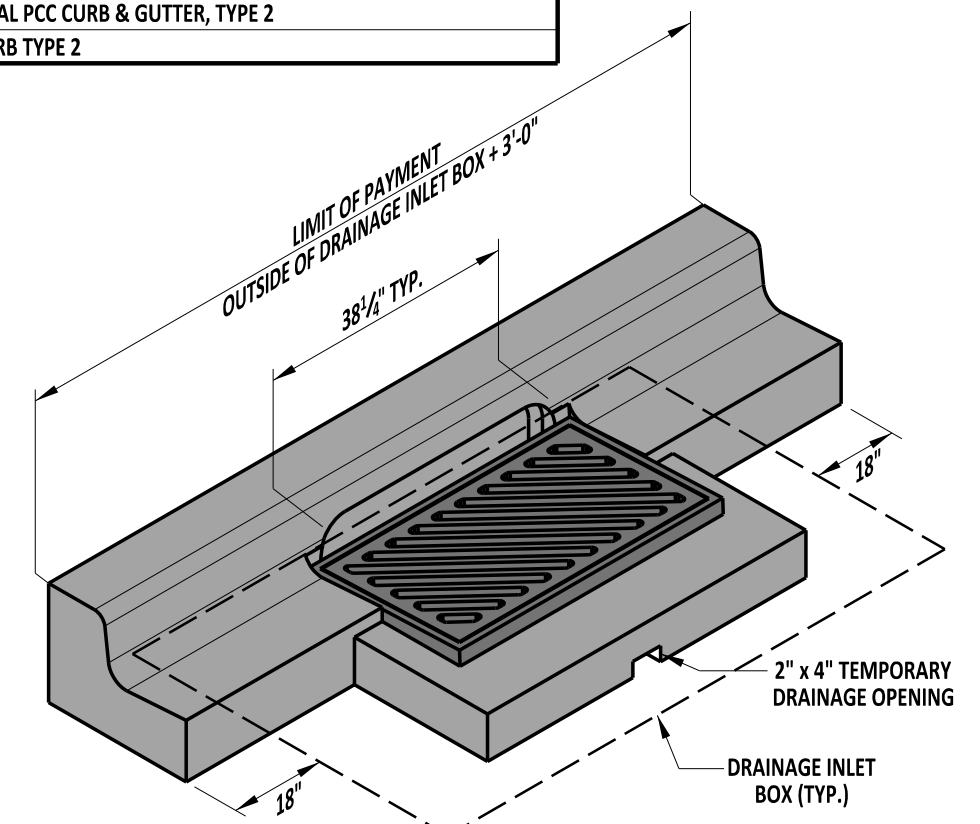

ISOMETRIC VIEW
TYPE B TOP UNIT SHOWN WITH INTEGRAL CURB & GUTTER TYPE 3

NOTE: LENGTH OF #4 REBAR SHALL BE THE OUTSIDE OF THE DRAINAGE INLET BOX PLUS 2'-9".

	 ENGINEERING SUPPORT DATE 09/01/2020 RECOMMENDED	DRAINAGE INLET TOP UNITS		REVIEWED DEPUTY DIRECTOR - DESIGN DATE 09/01/2020
	STANDARD NO. D-5 (2020)	SHT. 3 OF 9	APPROVED CHIEF ENGINEER DATE 09/01/2020	