

CHAMFER AND LOWER SETBACK DETAIL

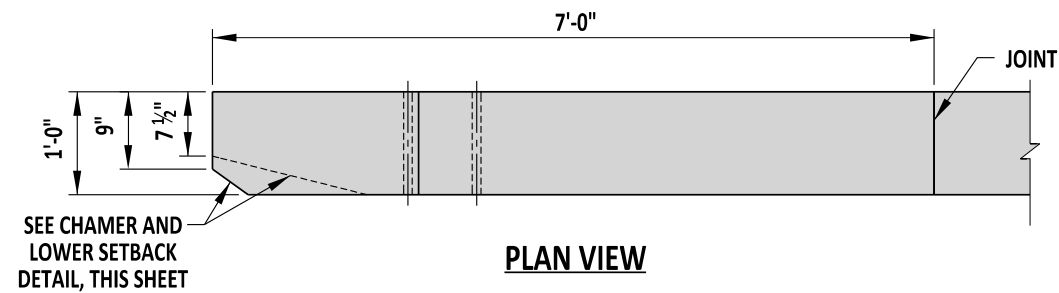

PLAN VIEW

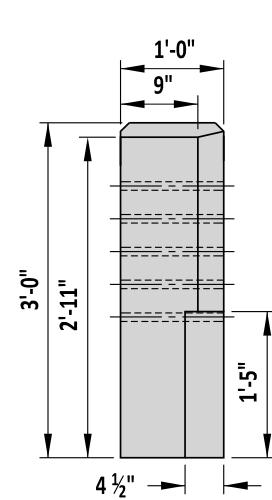

END VIEW

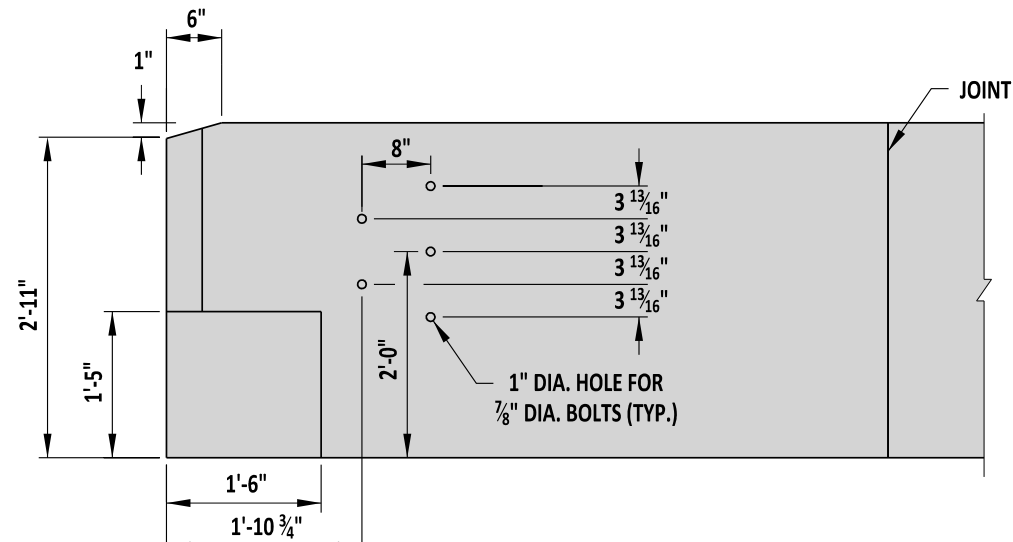

ELEVATION VIEW

NOTES:

- 1). THRIE-BEAM GUARDRAIL NOT SHOWN. SEE STANDARD NO. B-10 FOR MORE INFORMATION ON THRIE-BEAM CONNCTION.
- 2). FOUNDATION NOT SHOWN. FOR ROADSIDE BARRIER APPLICATIONS BUTTRESS SHALL BE CONSTRUCTED ON A MINIMUM 2'-0" WIDE x 2'-0" DEEP FOOTING OVER 8" OF GABC.
- 3). CHAMFER ALL EXPOSED EDGES 3/4" x 3/4", UNLESS NOTED OTHERWISE.
- 4). SEE SHEET 2 FOR BUTTRESS REINFORCEMENT.

DESIGNER NOTES:

- 1). FOR BUTTRESS APPLICATIONS AT BRIDGE APPROACHES, BRIDGE DESIGNER SHALL MATCH GEOMETRY SHOWN ON THIS DETAIL FOR THRIE-BEAM ATTACHMENT. LENGTH SHOWN HERE IS MINIMUM LENGTH FOR THRIE-BEAM ATTACHMENT. BRIDGE DESIGNER IS RESPONSIBLE FOR REINFORCEMENT DESIGN AND CONNECTION TO WINGWALL OR SLEEPER SLAB.

TL-3



Paul J. [Signature]
 ENGINEERING SUPPORT DATE 09/01/2020
RECOMMENDED

THRIE-BEAM APPROACH GUARDRAIL TRANSITION (AGT) TO CONCRETE BUTTRESS

STANDARD NO. B-11 (2020) SHT. 1 OF 8

REVIEWED

[Signature]
 DEPUTY DIRECTOR - DESIGN

09/01/2020
 DATE

APPROVED

[Signature]
 CHIEF ENGINEER

09/01/2020
 DATE