

TYPICAL SECTION

SCALE: 3/8" = 1'-0"

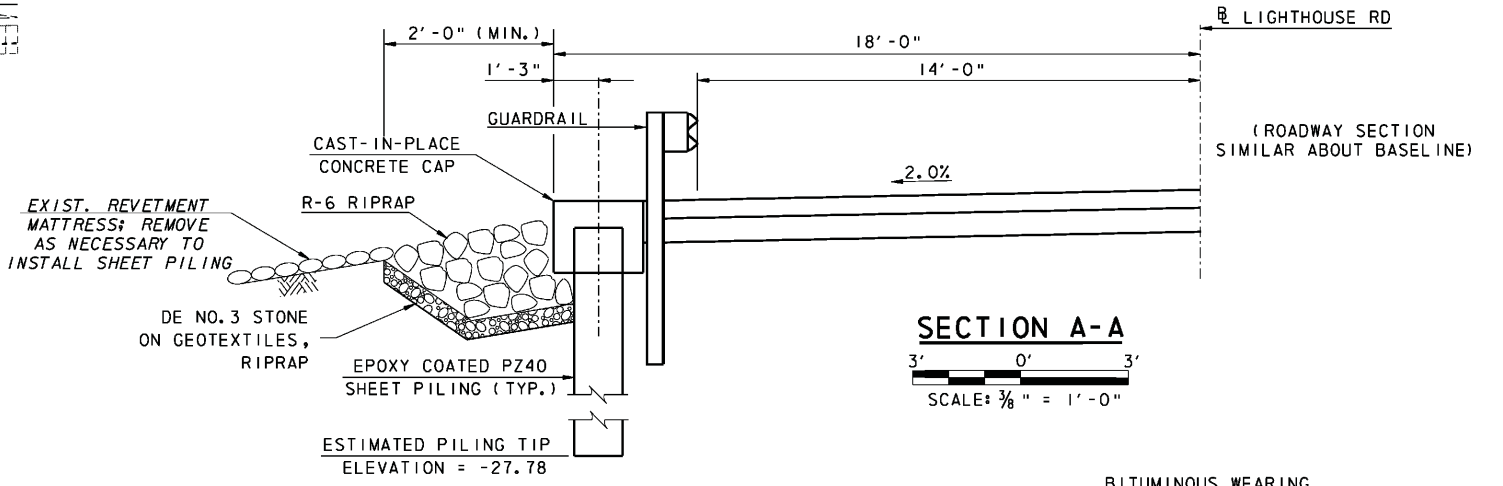

SECTION A-A

SCALE: 3/8" = 1'-0"

LEGEND

- EXISTING BORING
- 2— PROPOSED CONTOURS, 2' INTERVALS
- 2--- EXISTING CONTOURS, 2' INTERVALS
- ▨ EXISTING STRUCTURE (TO BE REMOVED)
- EXISTING REVETMENT MATTRESS (TO BE REMOVED)

PLAN

SCALE: 1" = 10'

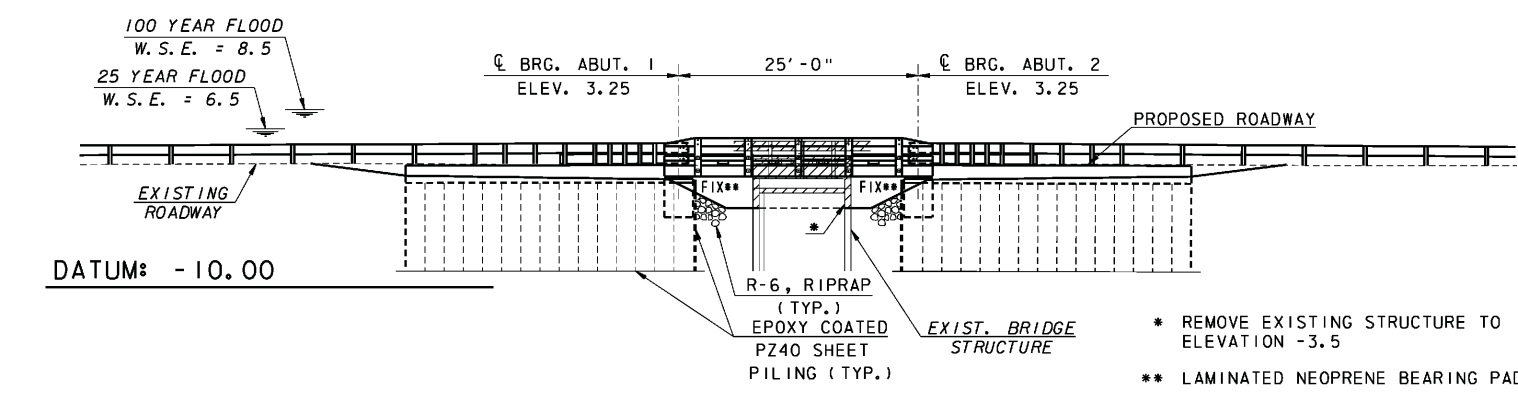

ELEVATION

SCALE: 1" = 10'

EXISTING CORE BORINGS

NO.	STATION	OFFSET
SB3	12+76.34	3.97' R
SB4	12+80.65	5.72' L
SB5	13+11.69	4.94' R
SB6	13+20.04	5.20' L
SB7	13+68.39	5.33' R

HYDRAULIC DATA

25-YEAR FLOOD DISCHARGE = 1745 C.F.S.
 25-YEAR FLOOD ELEVATION = 6.24 FT. UPSTREAM
 = 6.50 FT. APPROACH

100-YEAR FLOOD DISCHARGE = 2687 C.F.S.
 100-YEAR FLOOD ELEVATION = 8.13 FT. UPSTREAM
 = 8.50 FT. APPROACH

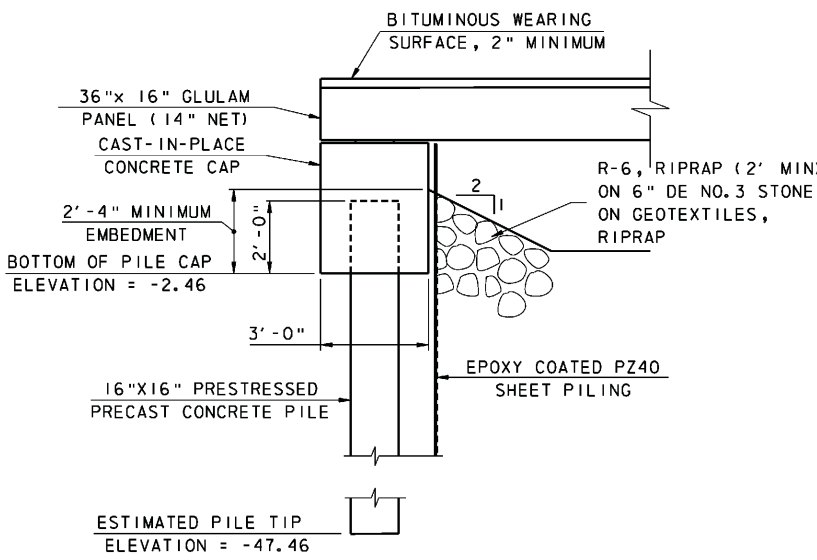

SECTION B-B

SCALE: 3/8" = 1'-0"

1/17/2010 BR 3-925 Bridge Plan & Elev.dgn