

**STANDARD DESIGN  
TYPICAL APPLICATION OF TRAFFIC CONTROL DEVICES FOR  
HIGHWAY CONSTRUCTION, MAINTENANCE AND UTILITY OPERATIONS  
CASE 8 - A**

**TWO-LANE, TWO-WAY - MOVING DAYTIME OPERATIONS**

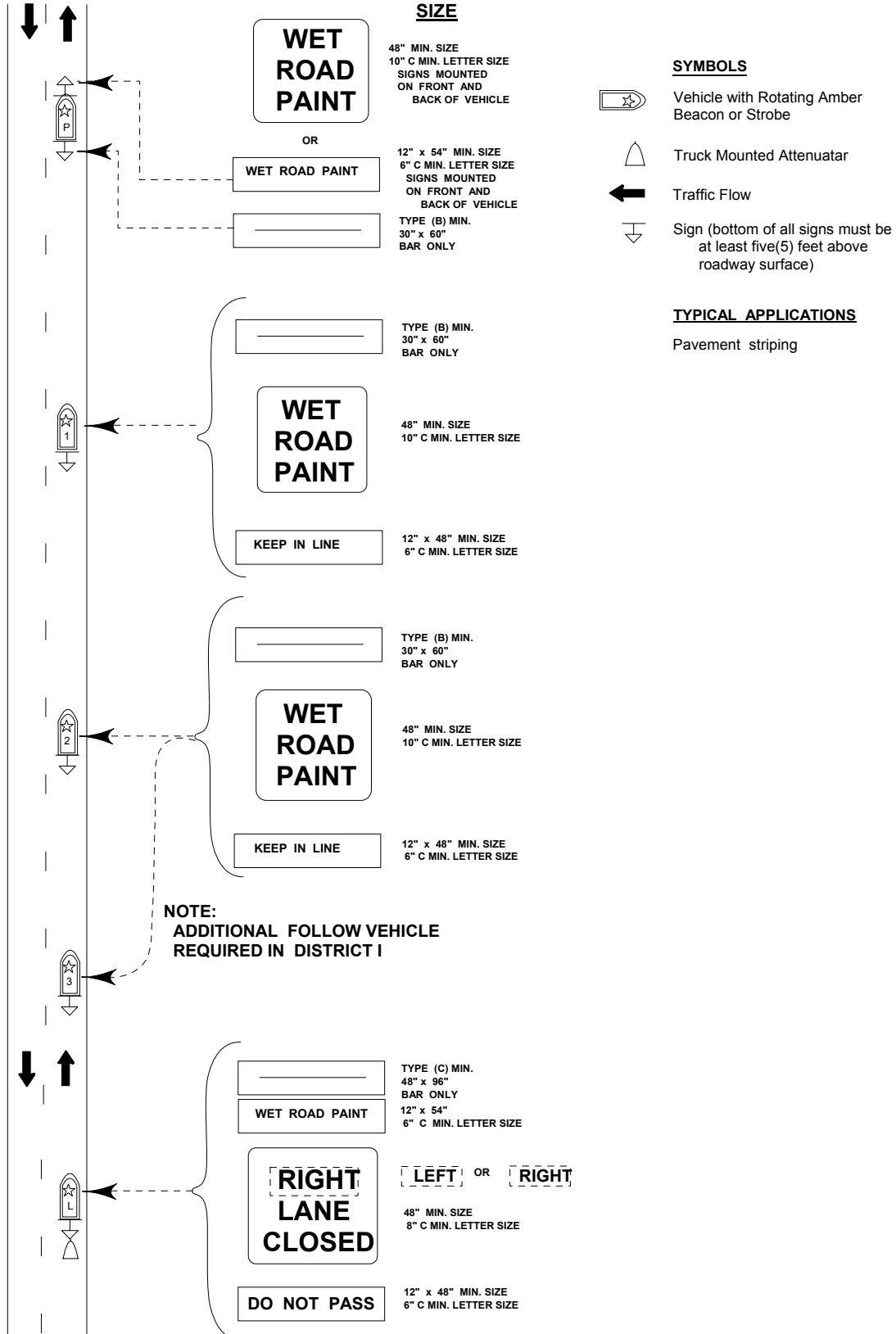

## CASE 8-A

### TWO LANE, TWO Way - MOVING DAYTIME OPERATIONS ONLY

Where, at any time, any vehicle, equipment, workers or their activities require a moving operation where the average speed of movement is greater than four (4) miles per hour, but less than twenty-five (25) miles per hour.

#### General Notes

1. All vehicles, equipment, workers (except flagger) and their activities are restricted at all times to one side of the pavement, unless otherwise authorized by the Engineer.
2. A minimum of four (4) vehicles are required at all times during moving applications of pavement markings. An additional follow vehicle is required in District I. (*See Standard Design Case 8-A*)
3. The first follow vehicle shall be driven at a variable distance behind the Paint Machine to prevent other vehicles from entering behind the Paint Machine.  
The second follow vehicle, the third follow vehicle required in District I and the last follow vehicle shall be driven at intervals of approximately seven hundred and fifty feet (750') behind the first follow vehicle.  
The last follow vehicle shall be equipped with an impact attenuator (T.M.A.)
4. Flags and Flashing Lights shall be mounted on the paint gun carriages whenever the carriage is extended 1 foot (1') or more beyond the width of the Paint Machine.
5. All signs must be fabricated of an approved reflective orange background with black copy and white (silver) stripes.
6. Longitudinal dimensions may be adjusted slightly to fit field conditions.
7. This is the minimum requirement for the condition set forth. The Traffic Engineer may require additional traffic control devices as deemed necessary.