

STANDARD DESIGN
TYPICAL APPLICATION OF TRAFFIC CONTROL DEVICES FOR
HIGHWAY CONSTRUCTION, MAINTENANCE AND UTILITY OPERATIONS
CASE 1
TWO-LANE, TWO-WAY TRAFFIC, DAY OR NIGHT OPERATIONS
OVER 6 FEET FROM EDGE OF PAVEMENT

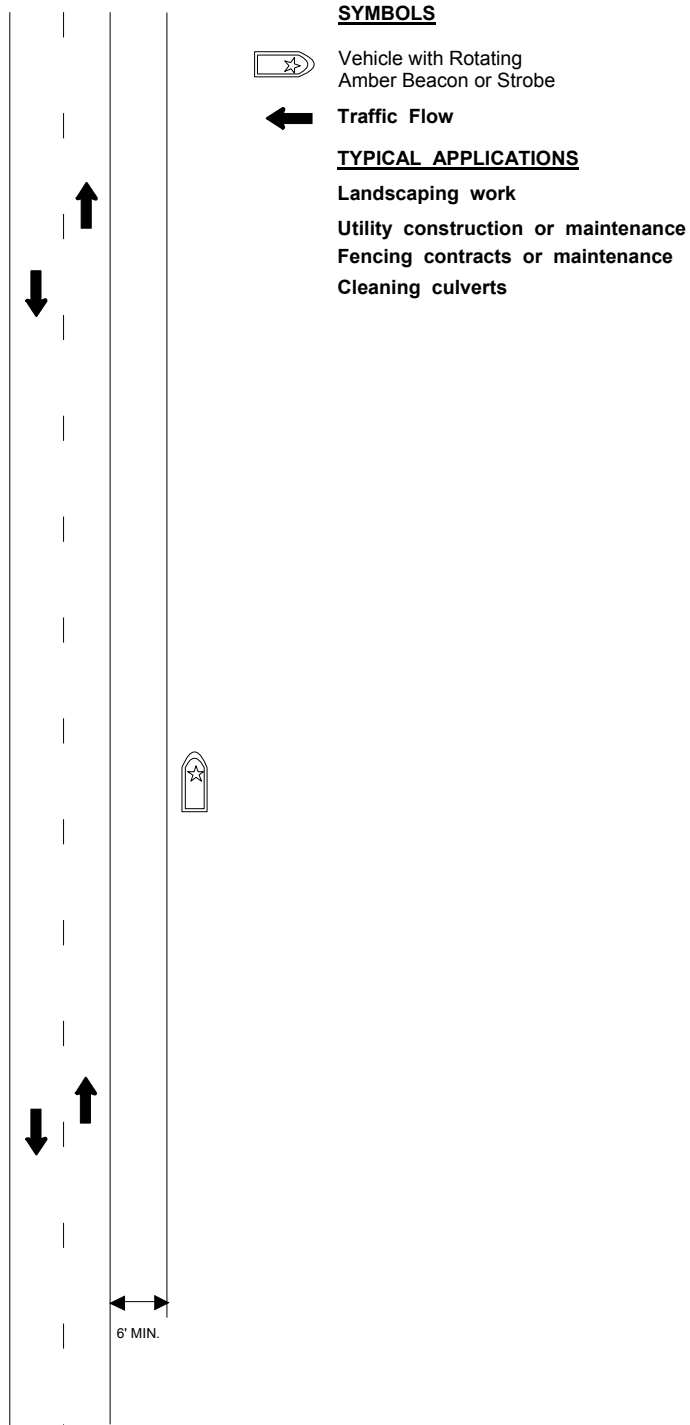

CASE 1

TWO-LANE, TWO-WAY TRAFFIC, DAY OR NIGHT OPERATIONS OVER 6 FEET FROM EDGE OF PAVEMENT

Where, at all times, all vehicles, equipment, workers and their activities are more than the width of the shoulder, but not less than six (6) feet from the edge of the pavement.

General Notes

1. No special signing is required.
2. If the work operation requires that two (2) or more vehicles cross the shoulder or six (6) foot clear zone in any one hour, traffic control will be in conformance with Case 2.
3. All vehicles in a work area shall display flashing lights installed for the purpose of warning approaching drivers of a vehicular traffic hazard requiring unusual care in approaching, overtaking, or passing.
4. This Case 1 is a minimum requirement for the condition set forth. The Traffic Engineer may require additional traffic control devices including flaggers as deemed necessary.